

May 13th, 2025

Templeville Road P2 and Glendown Road Active travel Scheme

Project Overview

WHERE: Templeville Road , Templeogue College to Rathfarnham Shopping Centre (Dodder Grenway)
Glendown Road , Templeville Road to Orwell Road

WHY: Delivering a joined up network across Templeogue and Tenenure areas to provide all people with a safe cycle and pedestrian network

WHAT: The NTA have made funds available for a 1km and 500m high-quality cycle lanes, more footpaths, measures to slow speeding, a narrowing of junction radii, repurposing carriageway widths to 3m, pedestrian crossings, 3 trees will be removed but will be replaced 5-fold,

When: Donnelly Civil Engineering has been appointed to start works at the end of May 2025 for duration of 12 months

Who is it for?

Children

Walking home together or to after-school activities together. Cycle to sports practice.

Young Adults

Able to access more job opportunities when they might not be able to afford a license/car.

Adults

More time is given back to parents when children can safely get to school and activities on their own.

Ageing Population

Reduced speeding = safer roads. Less traffic on the roads for them to be able to access amenities via car.

Everyone

All Road Users:

Drivers, Walkers, Cyclists

Context Map



Templeville Road P2

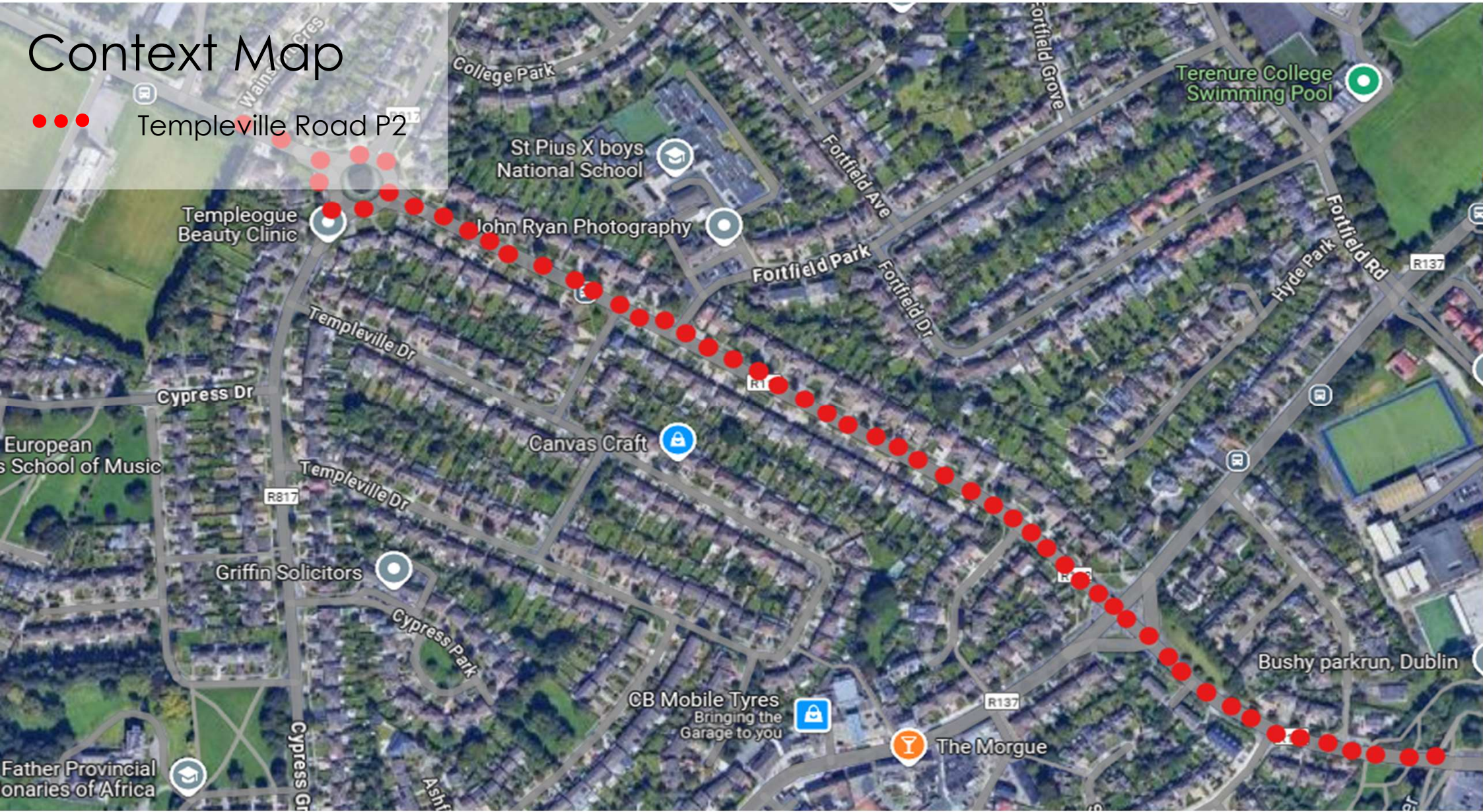

Context Map



Glendown Road

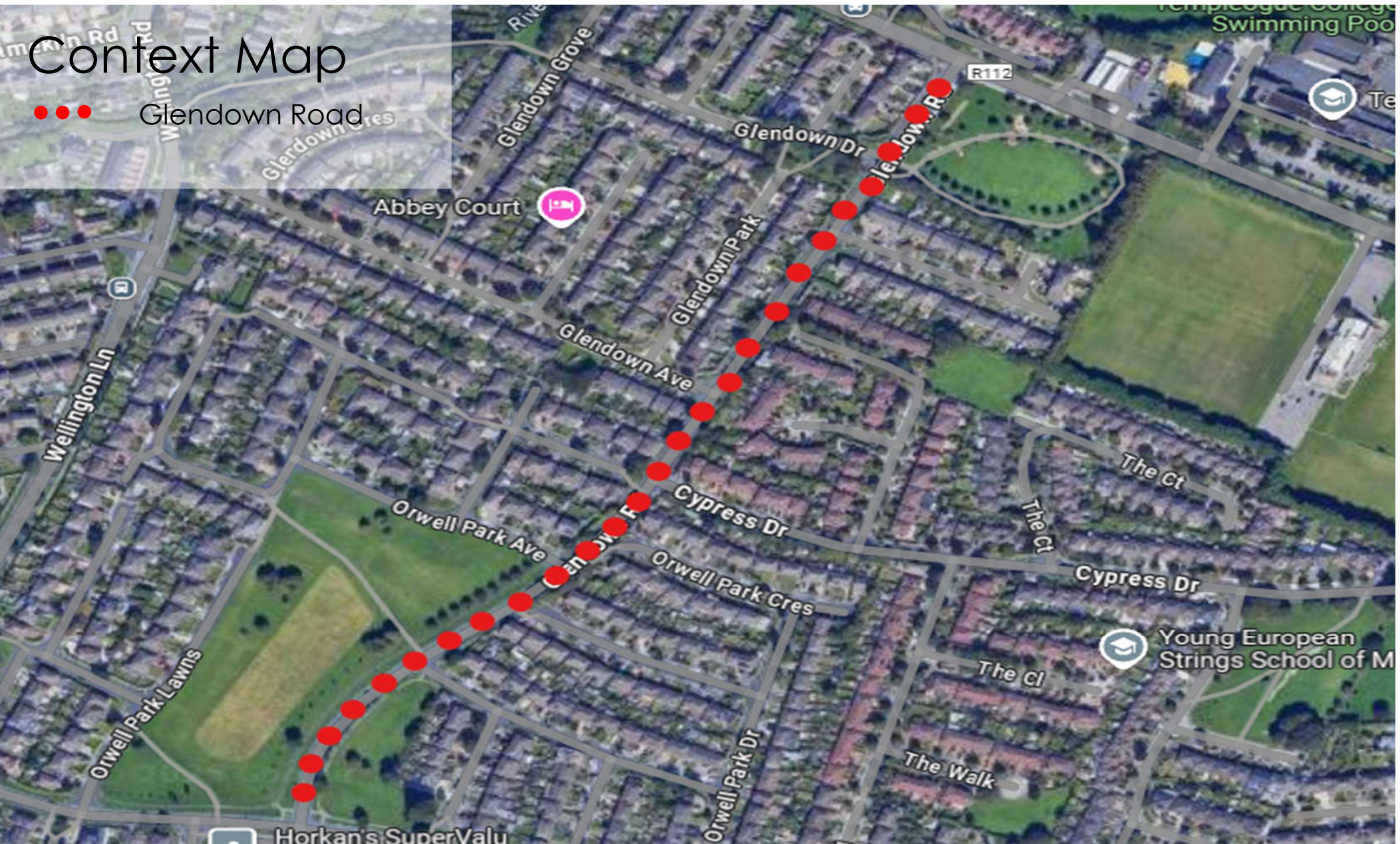

Consultation Summary

Templeville Road

These works will progress under a Section 38 of the Road Traffic Act 1994, however a non-statutory public consultation was held for 4 weeks between April 05th 2024 – May 03rd 2024

Total Responses:

- 30 Individual Observations/Submissions

Glendown Road

These works too will progress under a Section 38 of the Road Traffic Act 1994, a non-statutory public consultation was held for 4 weeks between 20th September 2023 – 03rd October 2023

Total Responses:

- 51 Individual Observations/Submissions

Summary of issues raised

- Strong local support for the scheme
- Junction design
- Traffic Congestion
- Narrowing road lanes
- Impact on emergency services
- Construction traffic
- Loss of trees

Key issue – Traffic and narrowing road lanes

The proposed scheme will not reduce the capacity of the road.

The existing carriageways are on average 9 metres wide which includes an advisory cycle lane on both sides of templeville Road.

The scheme proposed to repurpose the grass verges and advisory cycle lanes

There is no reduction in capacity

As the proposed road does not have a reduction capacity and the kerbs are standard height, emergency will be able to access and move along Templeville Road and Glendown Road as they previously have.

Other issues –

Construction Traffic – The Council acknowledges that the construction of the Templeville and Glendown Road resulted in traffic congestion. Whilst it will not be possible to resolve this issue completely, the Council will more carefully plan the construction programme to mitigate this

Suggested public realm improvements – several locations were identified where enhancements to the public realm works could be delivered to remove street clutter and this was assessed at the detailed design stage

Artist Impression



Existing

Proposed

Existing Wainsfort Roundabout

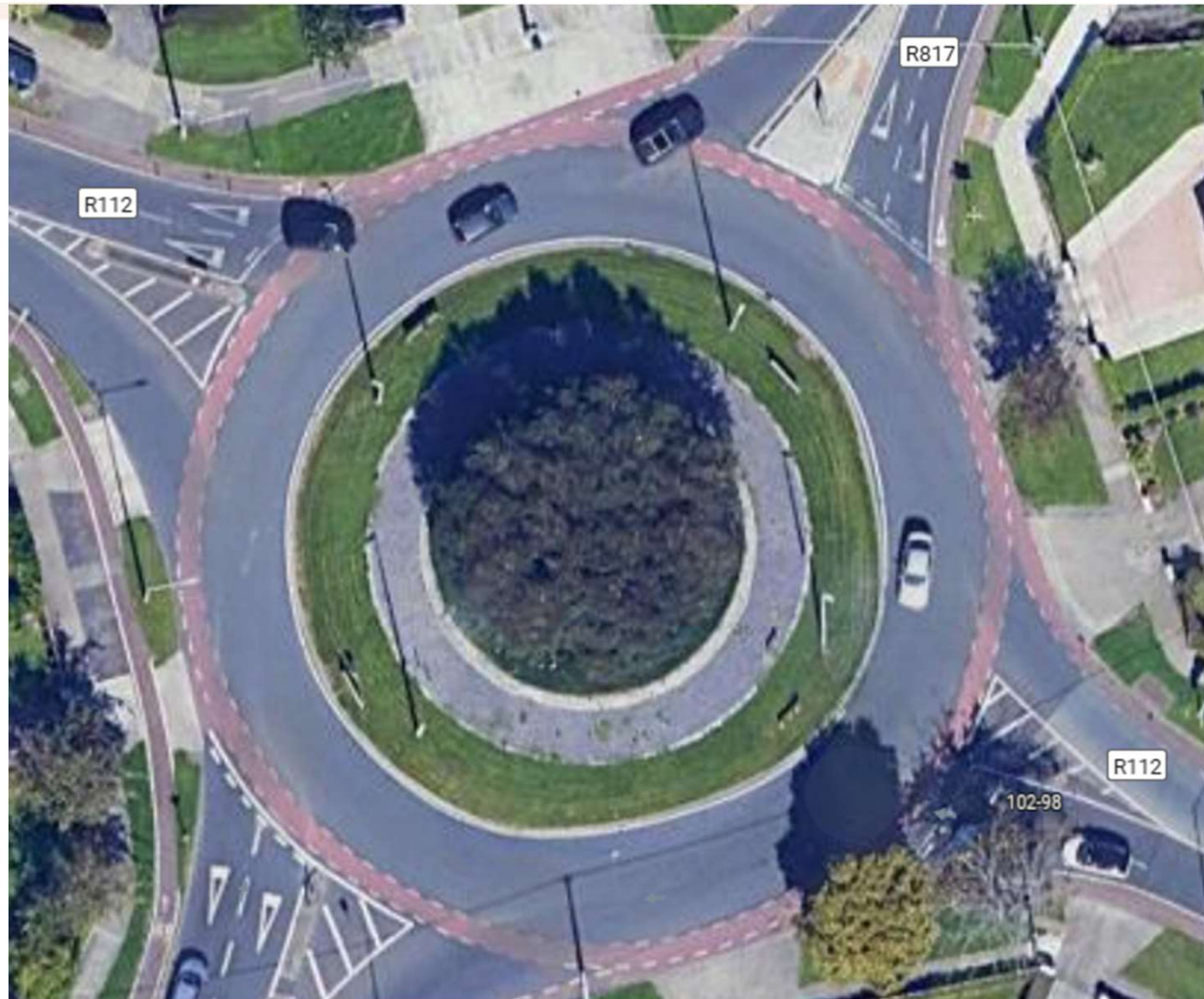

Proposed Wainsfort Roundabout

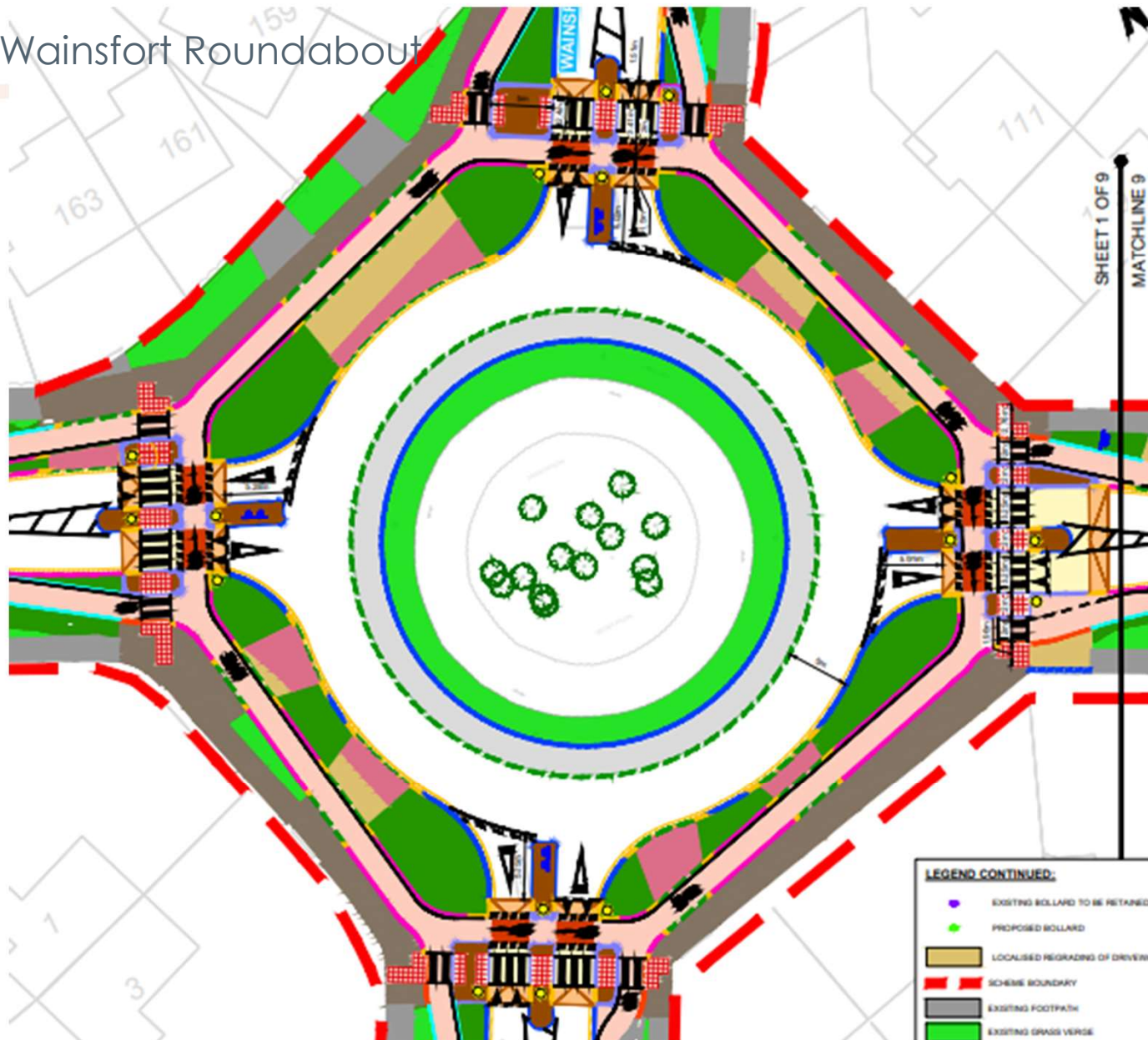

Any Questions ?

Thank you