

Wellington Lane Active Travel Scheme (Whitehall Road)

Rathfarnham / Templeogue ACM Meeting

12.11.24



Schemes Proposed in South Dublin

The **Wellington Lane Scheme** forms an integral part of a new and comprehensive cycle network being progressed by SDCC.

The Cycle South Dublin programme has the main objective of providing a comprehensive and connected cycle network across South Dublin as well as making cycling a more achievable mode of transport for adults and children.

The Wellington Lane Scheme will contribute to providing key links and connections to other cycle routes proposed within the County.

The junction proposal was developed in consultation with DCC.

The layout of the Whitehall Road Trial is shown the slides below

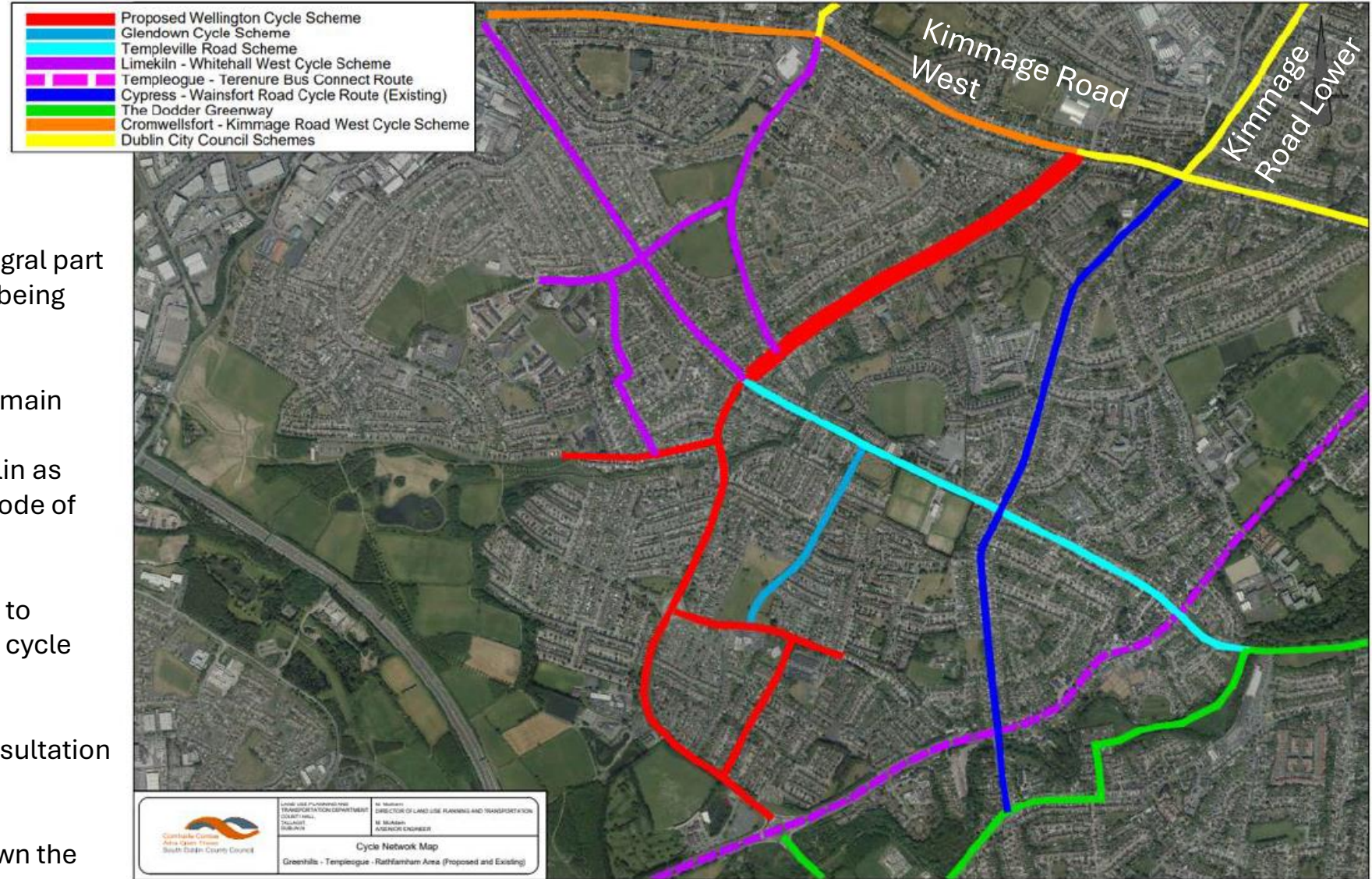

Location of proposed works

The Whitehall Road Trial Scheme forms part of the Wellington Lane - Wellington Road - Whitehall Road corridor and is part of the Cycle South Dublin Network.

Part 8 Consultation was carried out in September and October of 2022. A trial scheme will be provided.



Location of proposed works

The Whitehall Road Trial Scheme runs from north of the Greentrees Road Roundabout to the junction with Kimmage Road West located on the DCC Boundary

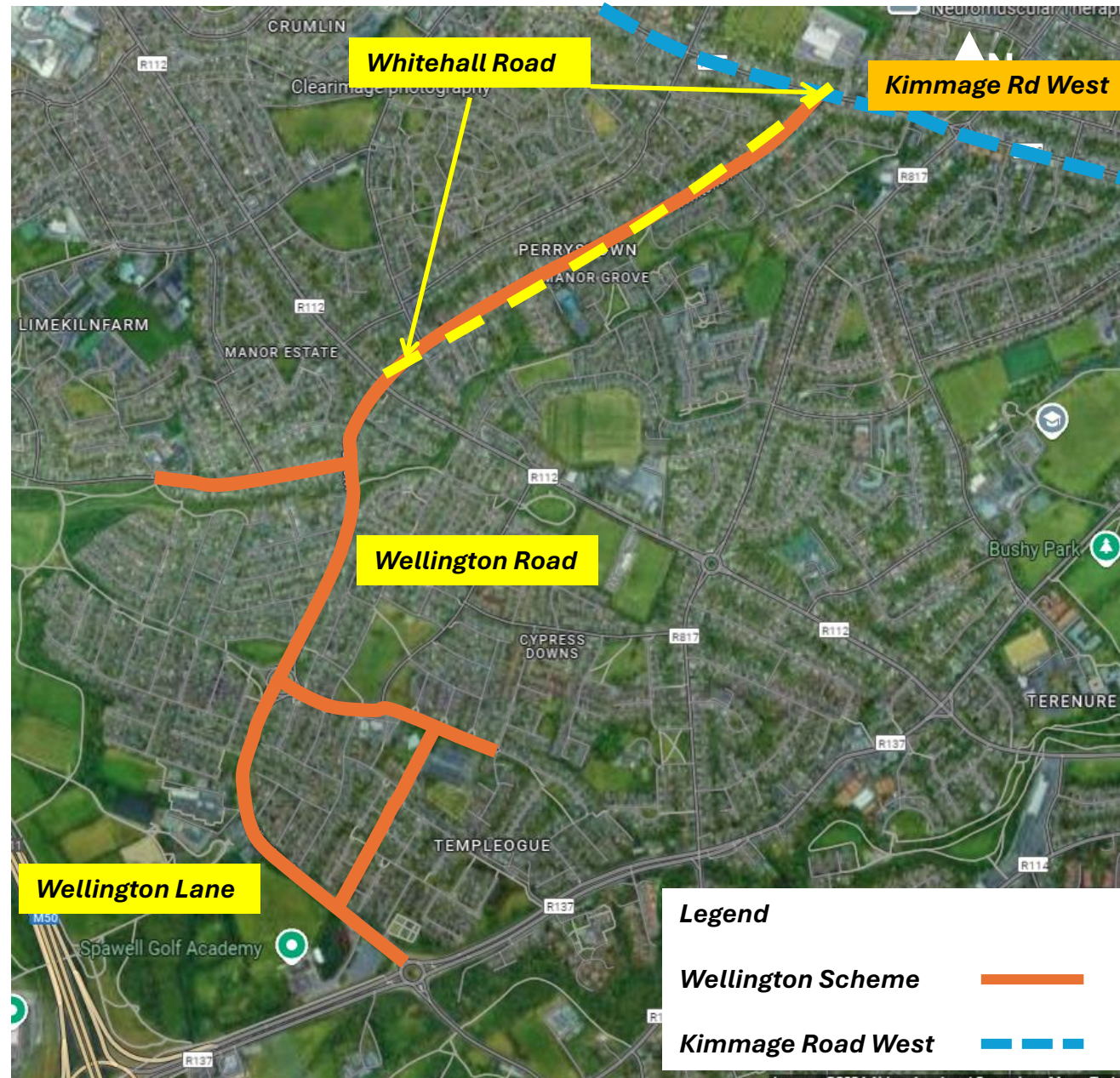

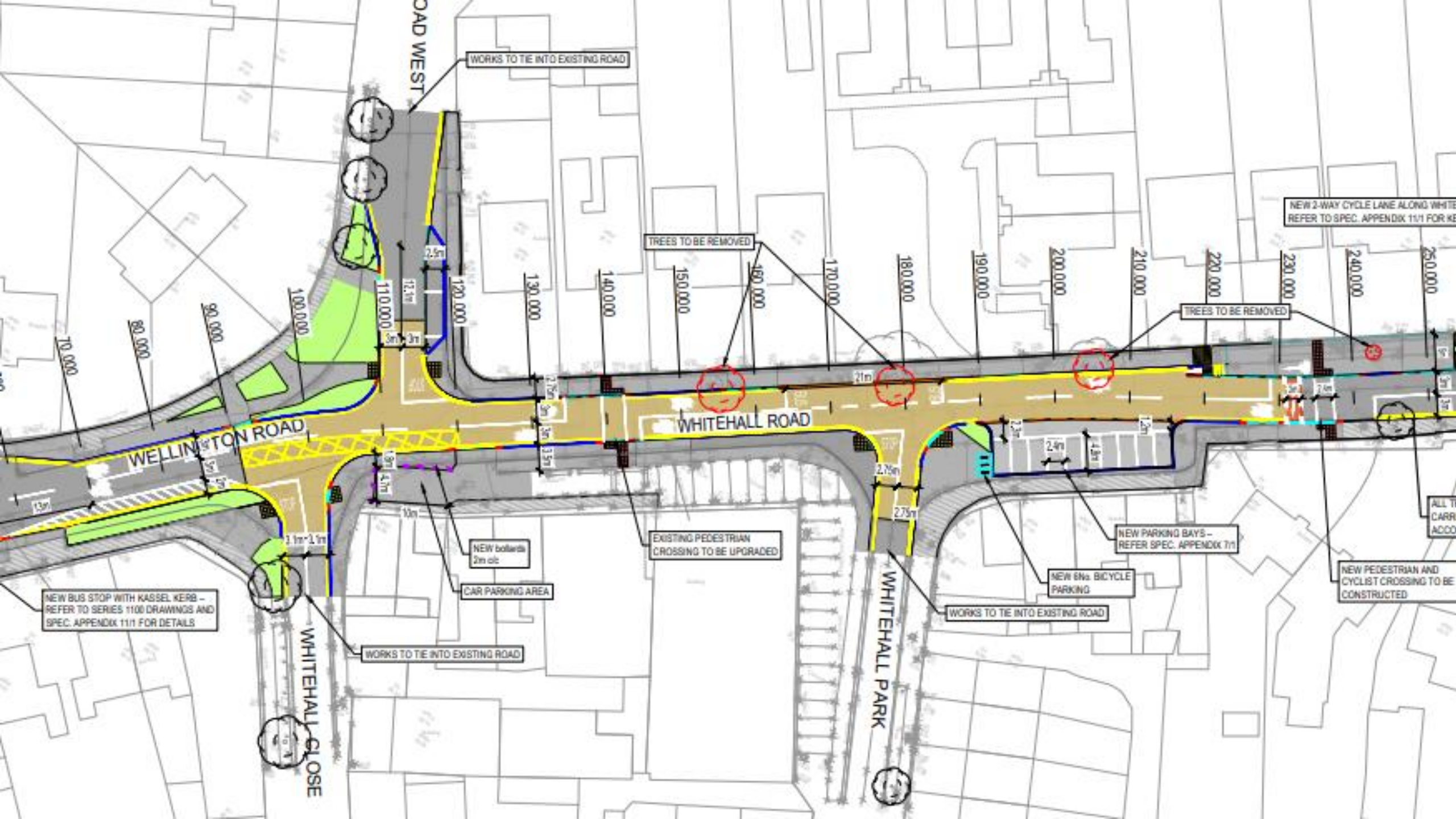

ROAD WEST

WORKS TO TIE INTO EXISTING ROAD

TREES TO BE REMOVED

NEW 2-WAY CYCLE LANE ALONG WHITEHALL ROAD
REFER TO SPEC. APPENDIX 11/1 FOR KE

TREES TO BE REMOVED

WELLINGTON ROAD

WHITEHALL ROAD

ALL T
CARR
ACCO

NEW BUS STOP WITH KASSEL KERB -
REFER TO SERIES 1100 DRAWINGS AND
SPEC. APPENDIX 11/1 FOR DETAILS

EXISTING PEDESTRIAN
CROSSING TO BE UPGRADED

NEW PARKING BAYS -
REFER SPEC. APPENDIX 7/1

NEW bollards
2m c/c

CAR PARKING AREA

NEW 6No. BICYCLE
PARKING

NEW PEDESTRIAN AND
CYCLIST CROSSING TO BE
CONSTRUCTED

WORKS TO TIE INTO EXISTING ROAD

WORKS TO TIE INTO EXISTING ROAD

WHITEHALL CLOSE

WHITEHALL PARK

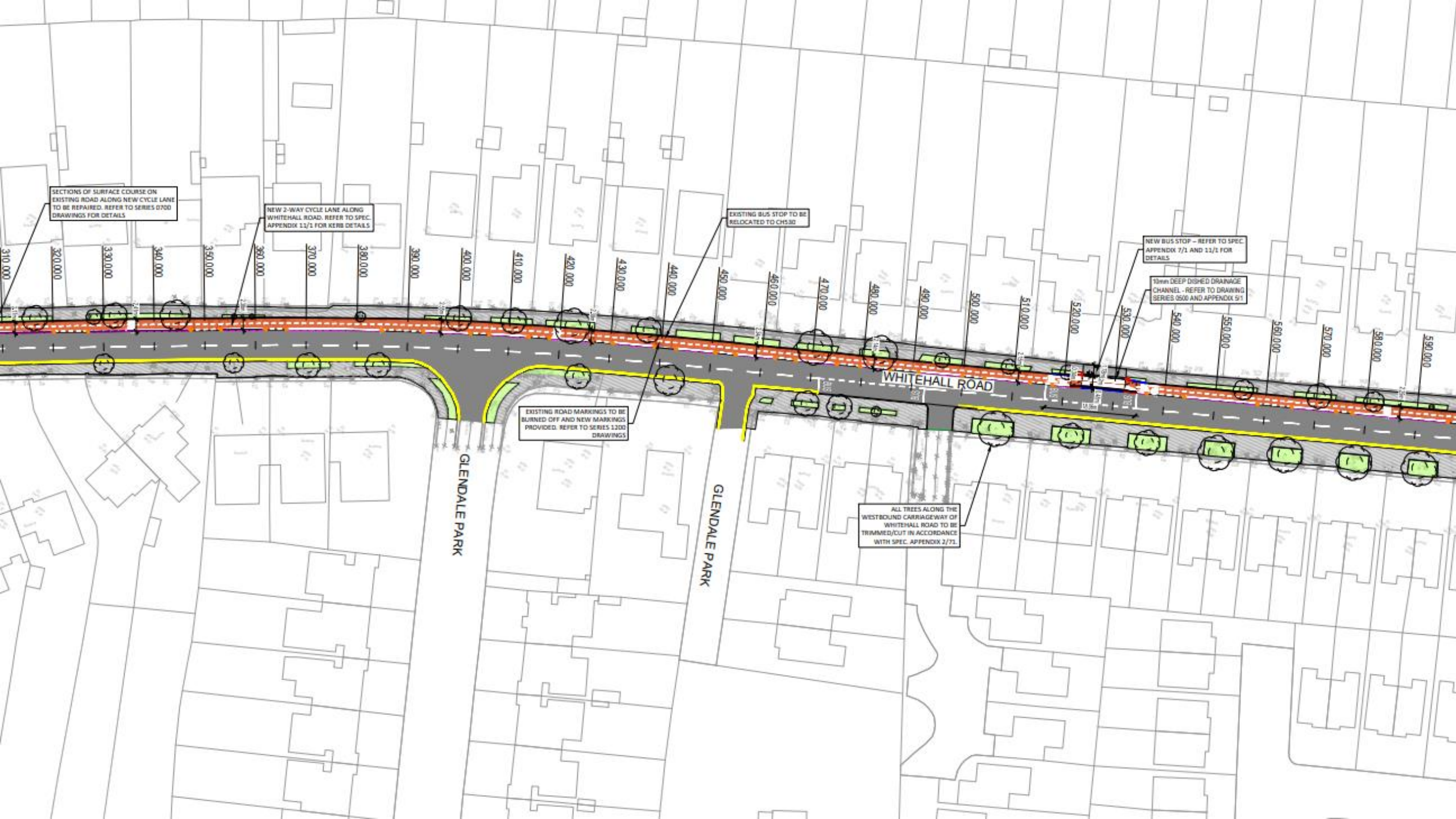

SECTIONS OF SURFACE COURSE ON EXISTING ROAD ALONG NEW CYCLE LANE TO BE REPAIRED. REFER TO SERIES 0700 DRAWINGS FOR DETAILS

NEW 2-WAY CYCLE LANE ALONG WHITEHALL ROAD. REFER TO SPEC. APPENDIX 11/1 FOR KERB DETAILS

EXISTING BUS STOP TO BE RELOCATED TO CH53D

NEW BUS STOP - REFER TO SPEC. APPENDIX 7/1 AND 11/1 FOR DETAILS

10mm DEEP DISHED DRAINAGE CHANNEL - REFER TO DRAWING SERIES 0500 AND APPENDIX 9/1

EXISTING ROAD MARKINGS TO BE BURNED OFF AND NEW MARKINGS PROVIDED. REFER TO SERIES 1200 DRAWINGS

ALL TREES ALONG THE WESTBOUND CARRIAGEWAY OF WHITEHALL ROAD TO BE TRIMMED/CUT IN ACCORDANCE WITH SPEC. APPENDIX 2/71.

GLENDALE PARK

GLENDALE PARK

WHITEHALL ROAD

310.000
320.000
330.000
340.000
350.000
360.000
370.000
380.000
390.000
400.000
410.000
420.000
430.000
440.000
450.000
460.000
470.000
480.000
490.000
500.000
510.000
520.000
530.000
540.000
550.000
560.000
570.000
580.000
590.000



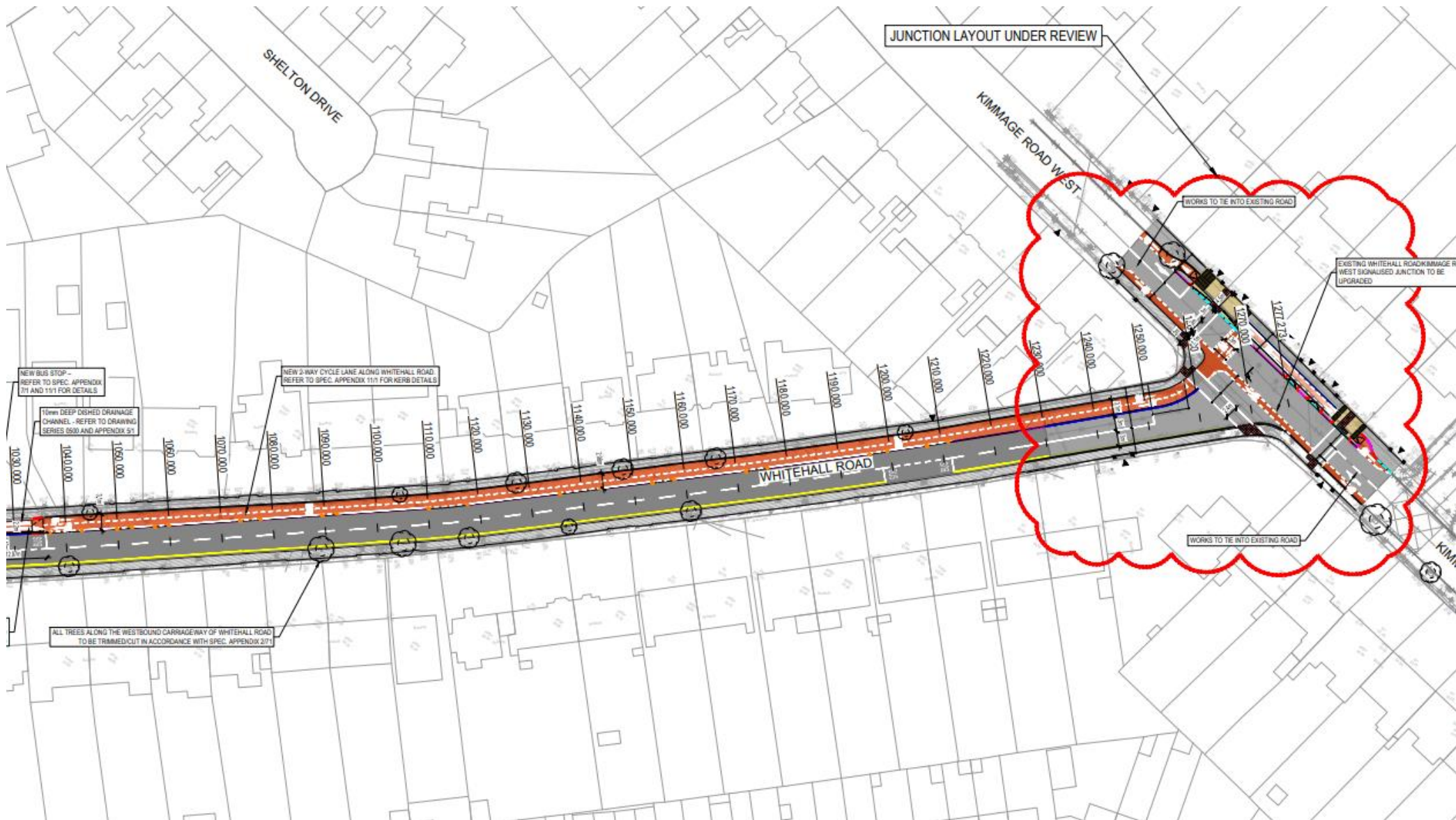

Proposed Whitehall Rd / Kimmage Rd West Junction

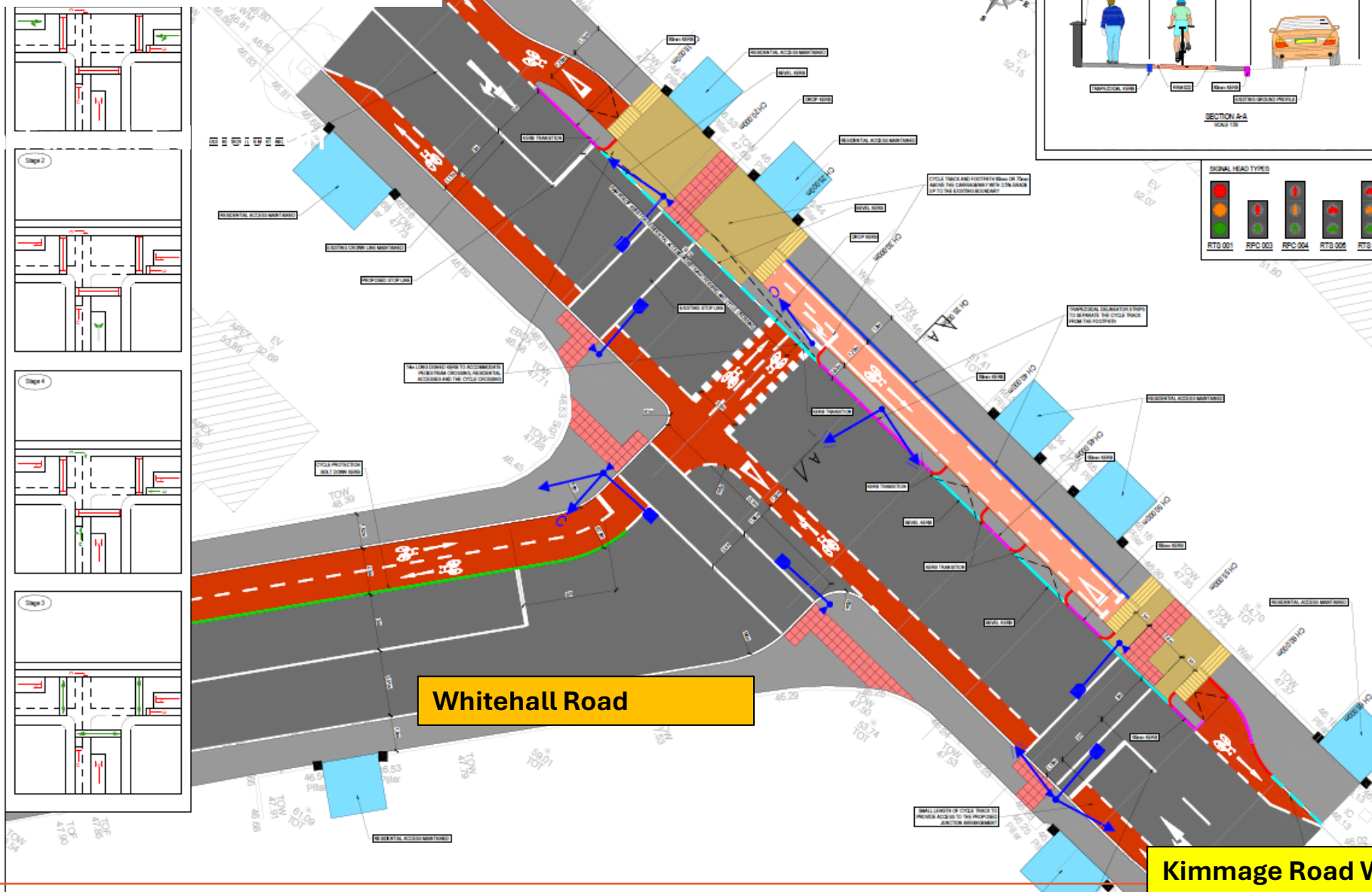

Whitehall Road

Kimmage Road West

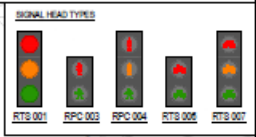
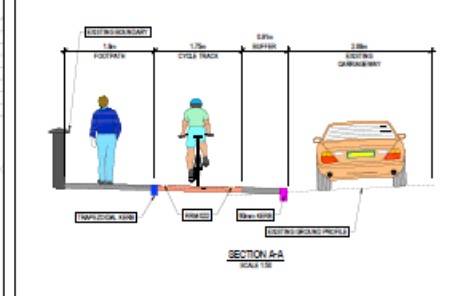

- NOTES:**
1. ALL WORKS TO BE CONSTRUCTED IN ACCORDANCE WITH THE TSI SPECIFICATION FOR ROAD WORKS (AS ISSUED) AND LOCAL ORDERING AND NOTIFICATION PROCEDURES.
 2. ALL ROADWORKERS AND SIGNAGE SHALL COMPLY WITH THE TRAFFIC SIGNS MANUAL PUBLISHED BY THE DEPARTMENT OF TRANSPORT.
 3. SIGNAGE MANUFACTURER CONTRACTOR TO CONFORM WITH THE TSI SPECIFICATION FOR ROAD WORKS (AS ISSUED) AND LOCAL ORDERING AND NOTIFICATION PROCEDURES.
 4. ALL TRAFFIC MANAGEMENT TO COMPLY WITH THE TSI SPECIFICATION FOR ROAD WORKS (AS ISSUED) AND LOCAL ORDERING AND NOTIFICATION PROCEDURES.
 5. ALL CO-ORDINATORS AND TO SIGN TRANSPORTATION.

- LEGEND:**
- ROAD
 - FOOTPATH
 - SHARED FOOTPATH
 - CYCLE TRACK
 - OFF-ROAD CYCLE TRACK
 - ON-ROAD CYCLE LANE
 - RESIDENTIAL ACCESS TO BE RETAINED
 - RESIDENTIAL ACCESS MAINTENANCE
 - TRANSVERSE DRAINAGE STRUCTURE
 - TRANSVERSE DRAINAGE
 - IN-STRIP CROSSING
 - PRE-CROSSING CROSSING
 - IN-STRIP CROSSING (PARKING ACCESS)
 - Blue SIGN
 - CYCLE PROTECTION BELT
 - DOWN SIGN
 - RESIDENTIAL ACCESS MAINTENANCE
 - CONCRETE TACTILE PAVING
 - CORNER TACTILE PAVING
 - CYCLE RAMP



DBFL CONSULTING ENGINEERS
 7-11 100 4000 | Dublin | Cork | Galway | Waterford

| | | | |
|--|------------------|-----------|------------|
| WHITEHALL ROAD - KIMMAGE ROAD JUNCTION OPTION 05 | | | |
| SOUTH DUBLIN COUNTY COUNCIL | | | |
| Project No: | 18021-18021-0135 | Sheet No: | 01 |
| Scale: | 1:500 | Date: | 01/10/2018 |

Opportunities & Constraints of the Proposals

| Opportunities | Constraints |
|---|---|
| Higher level of service for pedestrians & cyclists along Whitehall Road | Vehicular capacity is not expanded as significant new capacity is provided for pedestrian and cyclists movements |
| Aligns with NTA/SDCC/DCC Policies for active travel enhancements | No-Right-Turn from Whitehall Road into Rockfield Drive. Traffic from Kimmage Road West destined for Rockfield Avenue must enter from Shelton Grove. |
| Forms a connection between SDCC/DCC proposed active travel schemes | |
| Improved junction at Kimmage Road West | |
| Easier to see pedestrian and cyclists due to modification of junction geometry / layout | |