



A PRESENTATION FOR ENVIRONMENT,
WATER & CLIMATE CHANGE SPC

STRATEGY FOR THE PROVISION OF LOCAL COMMUNITY BASED RECYCLING FACILITIES IN SOUTH DUBLIN COUNTY 2023-2029



DATE: 6th November 2023

Aim of 2023 – 2029 Strategy

To create a more sustainable and environmentally conscious community within South Dublin County.

Advantages

1. Reduction of Waste
2. Resource Conservation
3. Energy Savings
4. Greenhouse Gas Emissions
5. Job Creation
6. Education and Awareness
7. Community Engagement
8. Enhancement
9. Localised Solutions
10. Long-term Sustainability

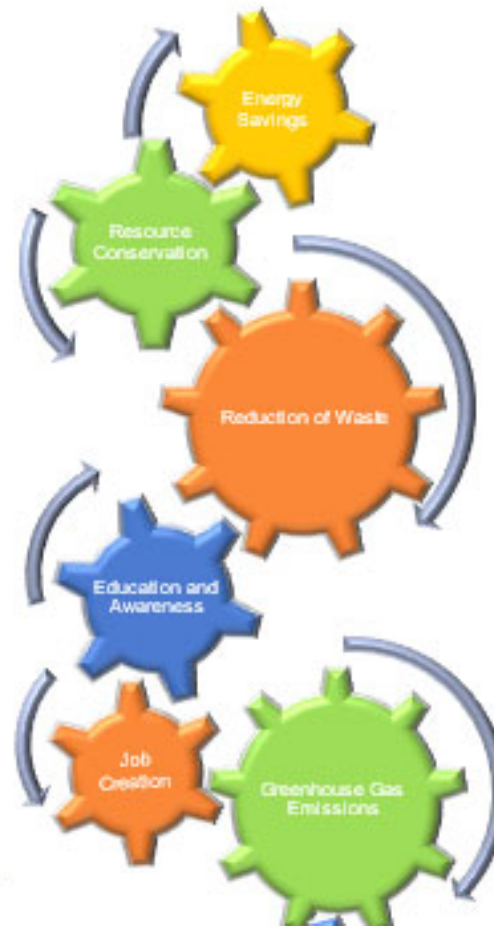

Recycling Household Waste in SDCC

SDCC / Private Waste Collectors

- Green Bin Service – Dry Recyclables
- Brown Bin Service – Organic and food waste
- Bring Bank network (both publicly and privately owned sites)
- Civic Amenity Centres (both public and private). [Ballymount 2022: 135,000 visitors & 26,000 tonnes deposited]
- Waste Electrical & Electronic Equipment Collection Points
- Future: Household Textile Collections
- Future: Deposit Return Scheme (Plastic & Cans)

Information service - <https://www.mywaste.ie/>



Alignment with Policies

National Policies

- Waste Action Plan for a Circular Economy - Ireland's National Waste Policy 2020-2025
- EU Strategy for Sustainable and Circular Textiles 2022
- National Waste Management Plan for Circular Economy 2023-2029 (Draft Stage)

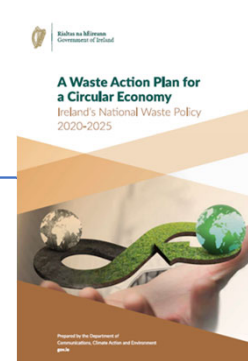

Regional / Local Policies

- South Dublin County Development Plan 2022-2028
- Draft South Dublin County Council Climate Action Plan 2024 – 2029



New Strategy Objectives and Actions

Objective 1: Increase the number of locations of recycling facilities

1A: Review all Council owned locations for compliance with Siting Criteria, prioritising areas of recycling deficit.

1B: Seek to include recycling facilities in all publicly funded projects, which meet the siting criteria

1C: Engage with communities, elected representatives, and members of the public to identify possible locations

1D: Support the implementation of the Deposit Return Scheme (DRS) within the county. (IE7 Objective 1)

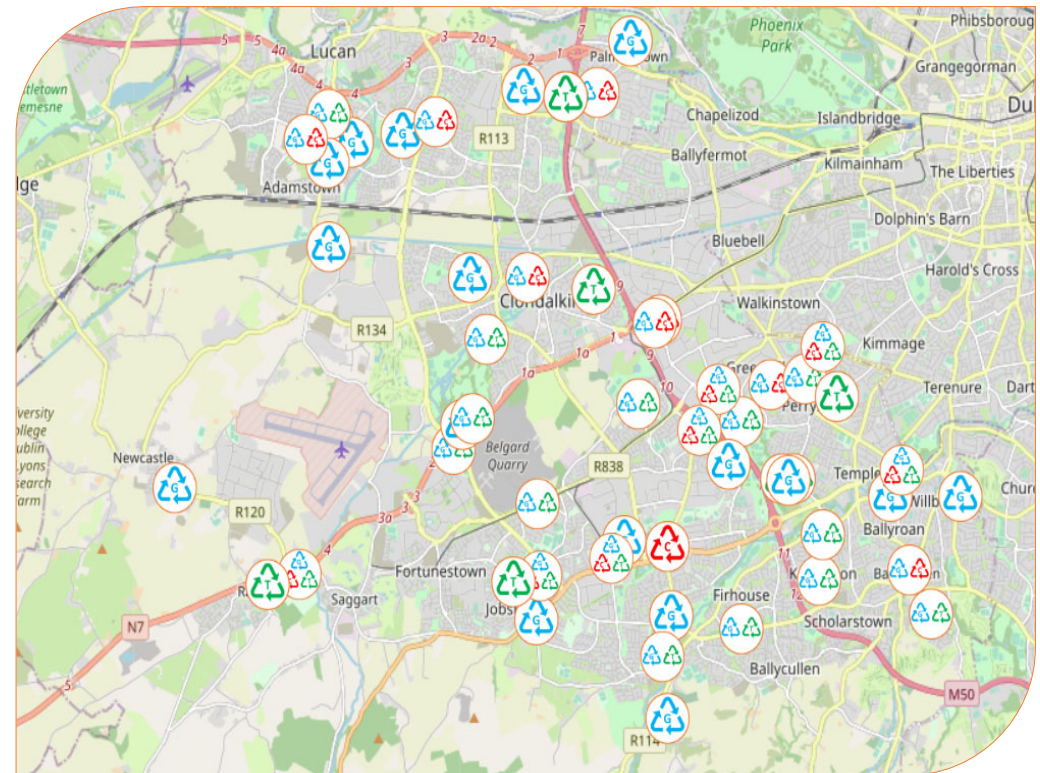

New Strategy Objectives and Actions

Objective 2: Seek to include recycling facilities in new developments

Action 2A: Ensure provision of public recycling facilities in new commercial developments and extensions of existing developments.

Action 2B: Require suitable waste management provisions in all developments.

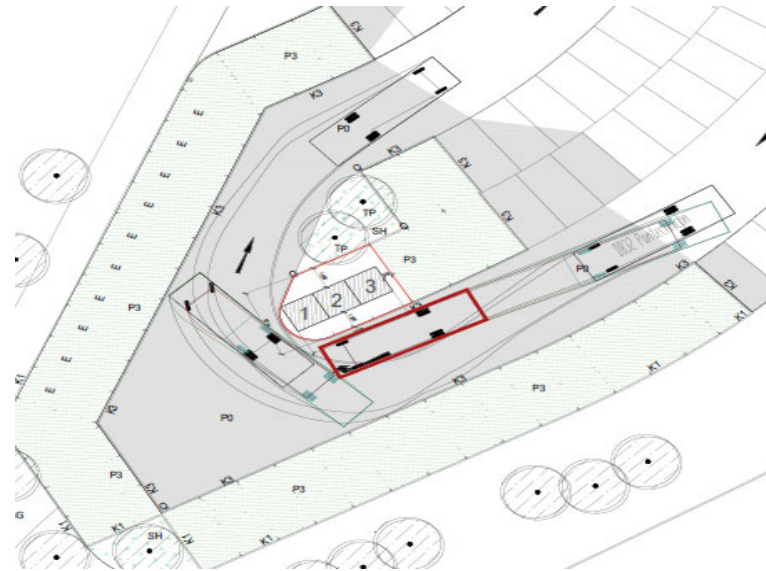

New Strategy Objectives and Actions

Objective 3: Retain and improve existing recycling sites

Action 3A: Implement an improved inspection and maintenance program for bring centre sites.

Action 3B: Create a register of clothes bank sites and collect information on tonnages collected.

Action 3C: Explore proposals for new service contracts for site improvements (e.g., painting and signage).

Action 3D: Implement a monitoring program to penalize misuse of recycling facilities.

Action 3E: Engage with relevant bodies on the recommendations of the 2020 National Review of Civic Amenity Sites.

Action 3F: Review potential for service expansion in line with the Waste Action Plan for a Circular Economy.

Action 3G: Examine innovative solutions for locations requiring new types of bring bank facilities, considering disability access.

New Strategy Objectives and Actions

Objective 3: Retain and improve existing recycling sites

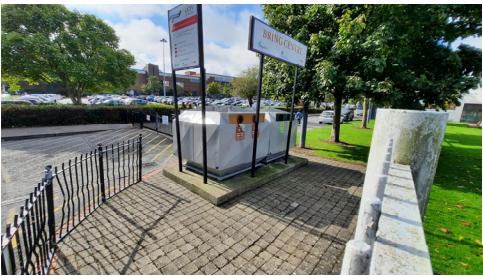

New Strategy Objectives and Actions

Objective 4: Increase the usage of recycling facilities

Action 4A: Implement a communication program to increase awareness of recycling facilities.

Action 4B: Improve community awareness of the recycling network via the council's online platforms.

Objective 5: Contract Provision

Action 5A: Collaborate with Dublin Local Authorities on awarding and managing a new regional glass collection contract.

Action 5B: Explore potential service contracts for textile collection

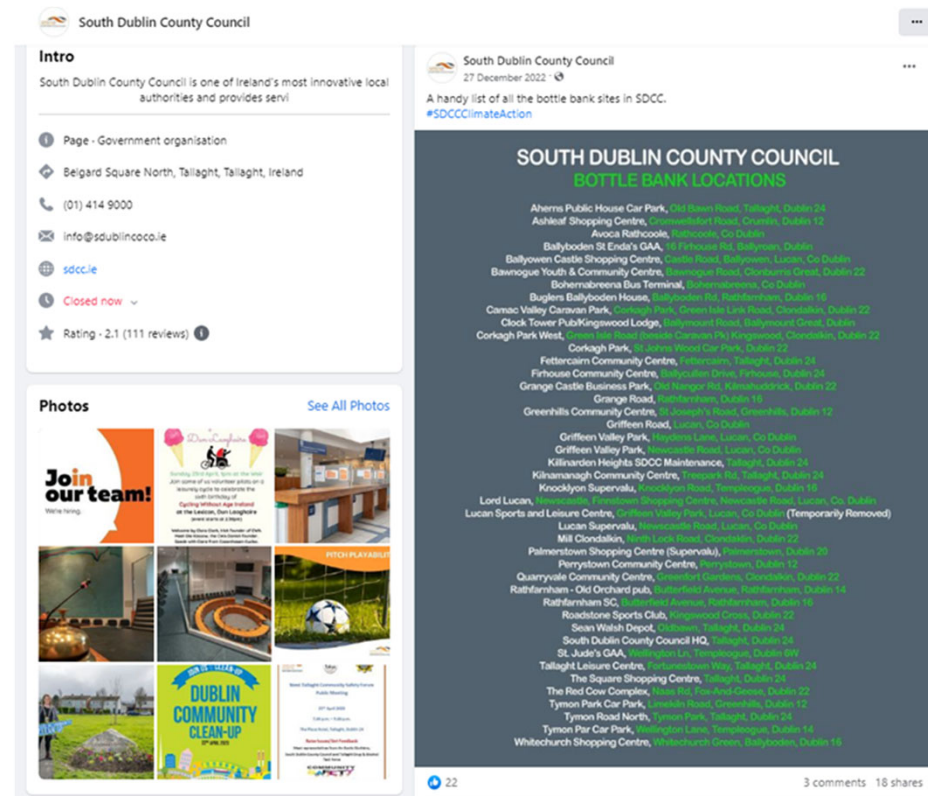

South Dublin County Council

Intro
South Dublin County Council is one of Ireland's most innovative local authorities and provides servi

Page - Government organisation
Belgard Square North, Tallaght, Tallaght, Ireland
(01) 414 9000
info@sdbcoco.ie
sdcclie
Closed now
Rating - 2.1 (111 reviews)

Photos See All Photos

Join our team!
We're hiring

DUBLIN COMMUNITY CLEAN-UP

SOUTH DUBLIN COUNTY COUNCIL BOTTLE BANK LOCATIONS

A handy list of all the bottle bank sites in SDCC. #SDCCClimateAction

- Aherms Public House Car Park, Old Bawn Road, Tallaght, Dublin 24
- Ashleaf Shopping Centre, Ballyboden Road, Clonsilla, Dublin 12
- Arcadia Rathcoole, Rathcoole, Co Dublin
- Ballyboden St Enda's GAA, 16 Firhouse Rd, Ballyowen, Dublin
- Ballyowen Castle Shopping Centre, Castle Road, Ballyowen, Lucan, Co Dublin
- Bawogwee Youth & Community Centre, Bawogwee Road, Clonsilla, Dublin 22
- Bohemian Bus Terminal, Bohemian, Co Dublin
- Buglins Ballyboden House, Ballyowen Rd, Rathfarnham, Dublin 16
- Canac Valley Caravan Park, Corlough Park, Green Isle Link Road, Clonsilla, Dublin 22
- Clock Tower Pub/Kingswood Lodge, Ballymount Road, Ballymount Great, Dublin
- Corlough Park West, Green Isle Road, Clonsilla, Co Dublin
- Corlough Park, Green Wood Car Park, Dublin 22
- Fettercairn Community Centre, Fettercairn, Tallaght, Dublin 24
- Firhouse Community Centre, Ballyowen Drive, Firhouse, Dublin 24
- Grange Castle Business Park, Old Manor Rd, Kilmacudick, Dublin 22
- Grange Road, Rathfarnham, Dublin 16
- Greenhills Community Centre, 21 Donaghil Road, Greenhills, Dublin 12
- Griffen Road, Lucan, Co Dublin
- Griffen Valley Park, Leyside Lane, Lucan, Co Dublin
- Griffen Valley Park, Newcastle Road, Lucan, Co Dublin
- Kilnarden Heights SDCC Maintenance, Tallaght, Dublin 24
- Kilnamanagh Community Centre, Hespalee Rd, Tallaght, Dublin 24
- Knocklyon Supervalue, Knocklyon Road, Templeogue, Dublin 16
- Lord Lucan, Newcastle, Peninsular Shopping Centre, Newcastle Road, Lucan, Co Dublin
- Lucan Sports and Leisure Centre, Griffen Valley Park, Lucan, Co Dublin (Temporarily Removed)
- Lucan Supervalue, Newcastle Road, Lucan, Co Dublin
- Mill Clonsilla, Mill Lane Road, Clonsilla, Dublin 22
- Palmerstown Shopping Centre (Supervalue), Palmerstown, Dublin 26
- Perrystown Community Centre, Perrystown, Dublin 12
- Quarryvale Community Centre, Greenfort Gardens, Clonsilla, Dublin 22
- Rathfarnham - Old Orchard pub, Satterfield Avenue, Rathfarnham, Dublin 14
- Rathfarnham SC, Satterfield Avenue, Rathfarnham, Dublin 16
- Roadstone Sports Club, Kingswood Cross, Dublin 22
- Sevan Walsh Depot, Dún Laoghaire, Tallaght, Dublin 24
- South Dublin County Council HQ, Tallaght, Dublin 24
- St. Jude's GAA, Warrington Ln, Templeogue, Dublin 16
- Tallaght Leisure Centre, Finnerlinn Way, Tallaght, Dublin 24
- The Square Shopping Centre, Tallaght, Dublin 24
- The Red Cow Complex, Main Rd, Fox-And-Cross, Dublin 22
- Tymon Park Car Park, Lonsdale Road, Clonsilla, Dublin 12
- Tymon Road North, Tymon Park, Tallaght, Dublin 24
- Tymon Park Car Park, Warrington Lane, Templeogue, Dublin 16
- Whitechurch Shopping Centre, Whitechurch Green, Ballyboden, Dublin 16

22 3 comments 18 shares

New Strategy Objectives and Actions

Objective 6: Database Management

Action 6A: Develop and maintain a database of all recycling facilities within the county.

Action 6B: Maintain an online directory of recycling services available to the public.

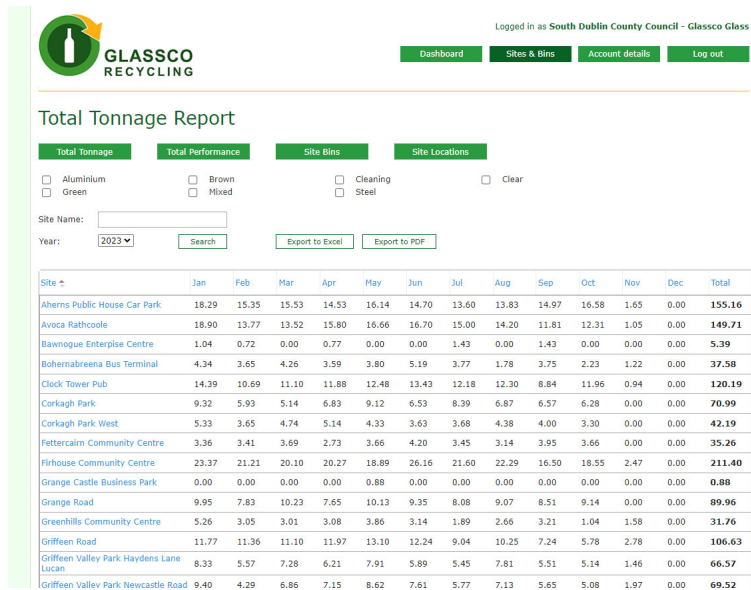

GLASSCO RECYCLING
Total Tonnage Report

Logged in as South Dublin County Council - Glassco Glass

Dashboard Sites & Bins Account details Log out

Total Tonnage Total Performance Site Bins Site Locations

Aluminium Brown Cleaning Clear
 Green Mixed Steel

Site Name:

Year: 2023

Site	Jan	Feb	Mar	Apr	May	Jun	Jul	Aug	Sep	Oct	Nov	Dec	Total
Aherns Public House Car Park	18.29	15.35	15.53	14.53	16.14	14.70	13.60	13.83	14.97	16.58	1.65	0.00	155.16
Avoca Rathcoole	18.90	13.77	13.52	15.80	16.66	16.70	15.00	14.20	11.81	12.31	1.05	0.00	149.71
Bawnogue Enterprise Centre	1.04	0.72	0.00	0.77	0.00	0.00	1.43	0.00	1.43	0.00	0.00	0.00	5.39
Bohemabreena Bus Terminal	4.34	3.65	4.26	3.59	3.80	5.19	3.77	1.78	3.75	2.23	1.22	0.00	37.58
Clock Tower Pub	14.39	10.69	11.10	11.88	12.48	13.43	12.18	12.30	8.84	11.96	0.94	0.00	120.19
Corkagh Park	9.32	5.93	5.14	6.83	9.12	6.53	8.39	6.87	6.57	6.28	0.00	0.00	70.99
Corkagh Park West	5.33	3.65	4.74	5.14	4.33	3.63	3.68	4.38	4.00	3.30	0.00	0.00	42.19
Fettercaim Community Centre	3.36	3.41	3.69	2.73	3.66	4.20	3.45	3.14	3.95	3.66	0.00	0.00	35.26
Firhouse Community Centre	23.37	21.21	20.10	20.27	18.89	26.16	21.60	22.29	16.50	18.55	2.47	0.00	211.40
Grange Castle Business Park	0.00	0.00	0.00	0.00	0.88	0.00	0.00	0.00	0.00	0.00	0.00	0.00	0.88
Grange Road	9.95	7.83	10.23	7.65	10.13	9.35	8.08	9.07	8.51	9.14	0.00	0.00	89.96
Greenhills Community Centre	5.26	3.05	3.01	3.08	3.86	3.14	1.89	2.66	3.21	1.04	1.58	0.00	31.76
Griffen Road	11.77	11.36	11.10	11.97	13.10	12.24	9.04	10.25	7.24	5.78	2.78	0.00	106.63
Griffen Valley Park Haydens Lane Lucan	8.33	5.57	7.28	6.21	7.91	5.89	5.45	7.81	5.51	5.14	1.46	0.00	66.57
Griffen Valley Park Newcastle Road	9.40	4.29	6.86	7.15	8.62	7.61	5.77	7.13	5.65	5.08	1.97	0.00	69.52

ID	Bank Icon Code	Bring Bank Sites	Address	Private or SDCC	Public / Restricted Access
1	Glass	Bohemabreena Bus Terminal	Bohemabreena, Co. Dublin	SDCC	Yes
2	Glass & Textile	Corkagh Park	8-18 St John's Green, Commons, Dublin 22	SDCC	Yes
3	Glass, Cans & Textile	Griffen Valley Park, Lucan	Lucan Harriers, Newcastle Road, Lucan Co. Dublin	SDCC	Yes
4	Glass & Textile	Whitechurch Shopping Centre	Whitechurch Green, Ballyboden, Dublin 16	Private	Yes
5	Glass & Textile	Firhouse Community Centre	Ballycullen Dr, Tallaght, Firhouse, Co. Dublin, 24	SDCC	Yes
6	Glass	Grange Castle Business Park	Grange Castle IBR, New Nangor Road, Grange, Dublin 22	SDCC	Yes
7	Glass & Cans	Greenhills Community Centre	Greenhills Rd, Greenhills, Dublin	Private	Yes
8	Glass	Griffen Valley Park, Haydens Lane, Lucan	Haydens Lane, Lucan Co. Dublin	SDCC	Yes
9	Glass	Quarryvale Community Centre	Greenfort Gardens, Irishtown, Clondalkin, Co. Dublin, D22 NW54	SDCC	Yes
10	Glass & Textile	Roadstone Sports Club	R136, Kingswood Cross, Dublin	Private	Yes
11	Glass & Textile	Tymon Park, Wellington Lane	Templeogue Village, Dublin	SDCC	Yes
12	Glass & Textile	Clock Tower Pub/Kingswood Lodge	Ballymount Rd., Ballymount Great, Dublin	Private	Yes
13	Textile	Dutch Village	Knockmitten, Dublin	Private	Yes
14	Glass	Killinarden Heights SDCC Maintenance	Whitestown, Dublin	SDCC	Yes
15	Glass & Cans	Palmerstown Supervalu	Palmerstown Shopping Centre, Kennelsfort Rd Upper, Woodfarm, Dublin, D20 Y186	Private	Yes
16	Glass & Textile	Tymon Park, Limekiln Road	12 Limekiln Rd, Tymon Park, Dublin 12	SDCC	Yes
17	Glass, Cans & Textile	West Tallaght Leisure Centre	Fortunestown Way, Tallaght, Dublin, D24 KX38	SDCC	Yes
18	Glass	Camac Valley Caravan Park	Block 2 The, Village Green, Tallaght, Dublin 24	SDCC	Yes
19	Glass & Textile	Fettercaim Community Centre	Fettercaim, Dublin	SDCC	Yes
20	Glass	Griffen Road	Esker South Lucan Co. Dublin	SDCC	Yes
21	Glass & Textile	Perrystown Community Centre	Limekiln Ln, Roebuck, Dublin	SDCC	Yes
22	Textile	Jobstown Community Centre	Fortunestown Way, Tallaght, Dublin	SDCC	Yes
23	Glass	Rathfarnham - Orchard pub	74 Butterfield Ave, Rathfarnham, Dublin, D14 RF98	Private	Yes

New Strategy Objectives and Actions

OBJECTIVES

1. Increase the number of locations of recycling facilities

2. Include the provision of recycling facilities in all new developments.

3. Retain and improve existing recycling sites.

4. Increase the usage of recycling facilities.

5. Contract Provision

6. Database Management.

ACTIONS

4

2

7

2

2

2

**19 Proposed Actions across the 6 Key Objectives
(Previous Strategy had 4 Objectives & 9 Actions)**

Summary

Overall Aim of the New Strategy

To create a more sustainable and environmentally conscious community within South Dublin County:

- Enhance recycling infrastructure in South Dublin
- Encourage recycling awareness to people within South Dublin
- Various departments and stakeholders responsibilities identified.
 - ↳ Objectives and actions assigned for implementation
 - ↳ Within specified timeframes

Thank You

*Colum Fagan
Senior Executive Engineer
Waste Management & Compliance
Environment, Water and Climate Change
cfagan@sdublincoco.ie*