

CORKAGH PARK



Presentation to Elected Members
08.11.2021

INTRODUCTION



Mehron Kirk
Landscape and Urbanism Director



Kevin McGann
Snr. Landscape Architect CMLI

BDP.

An international multi-discipline practice. As Landscape Architects and placemakers we specialise in the concept, detailed design and delivery of public realm and parks projects across the Ireland and the UK.



TYRÉNS MASTERPLAN

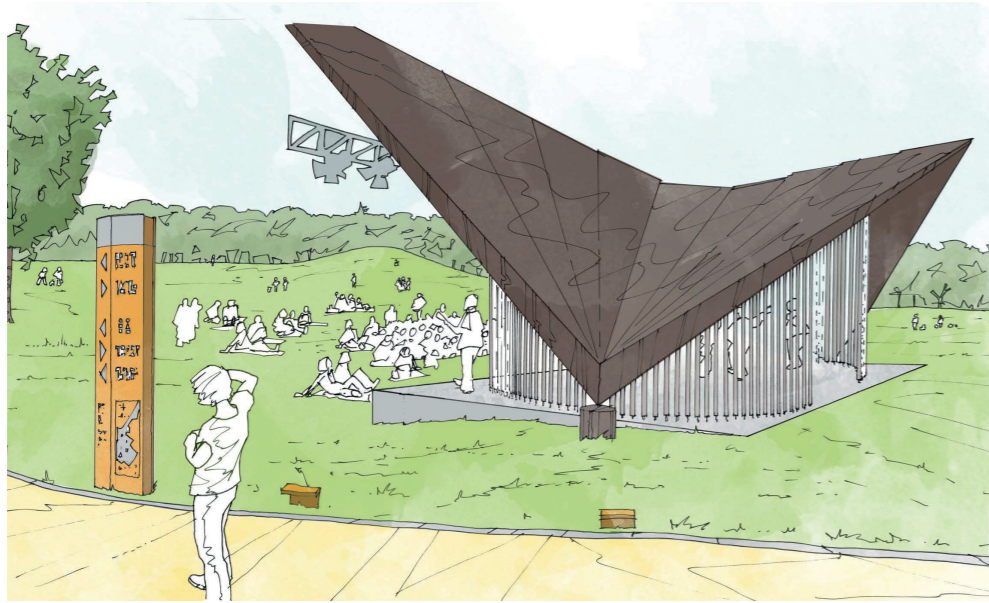

OBJECTIVES AND OPPORTUNITIES

- 1. To enhance the Visitor Experience.**
- 2. To Engage with Local and Regional Visitors to bring the Projects in Line with Aspirations.**
- 3. Promote Health and Well-being Facilities.**
- 4. Create All-Season Destination for Events as well as Recreations.**
- 5. Increase Revenue Opportunities for SDCC to facilitate future investment in the park.**
- 6. Enhance Legibility and Wayfinding in the Park while Promoting Universal Accessibility.**
- 7. Deliver a Destination, Multi-scale Events Space.**
- 8. Take Care to Enhance and Promote the Natural Assets of the Park while Increasing Local Biodiversity and Heritage.**

OVERALL APPROACH AND SCOPE



THE HUB ZONE

'defining a new centre for Corkagh Park'

- Creating a new Events Space and Café north of the Rose Garden.
- New Wayfinding and Signage linking the park's entrances with new and existing destinations throughout the park.
- Enhanced park entrances.
- Enhancements to walking and cycling infrastructure.

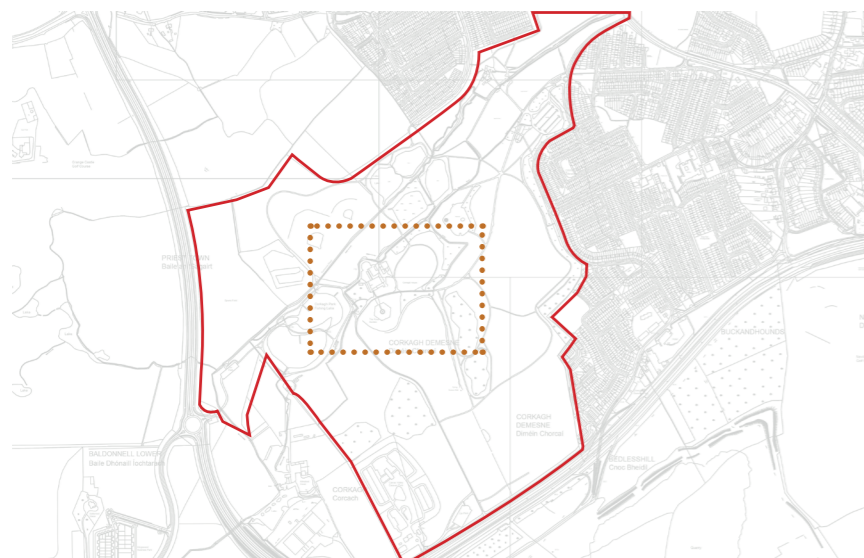
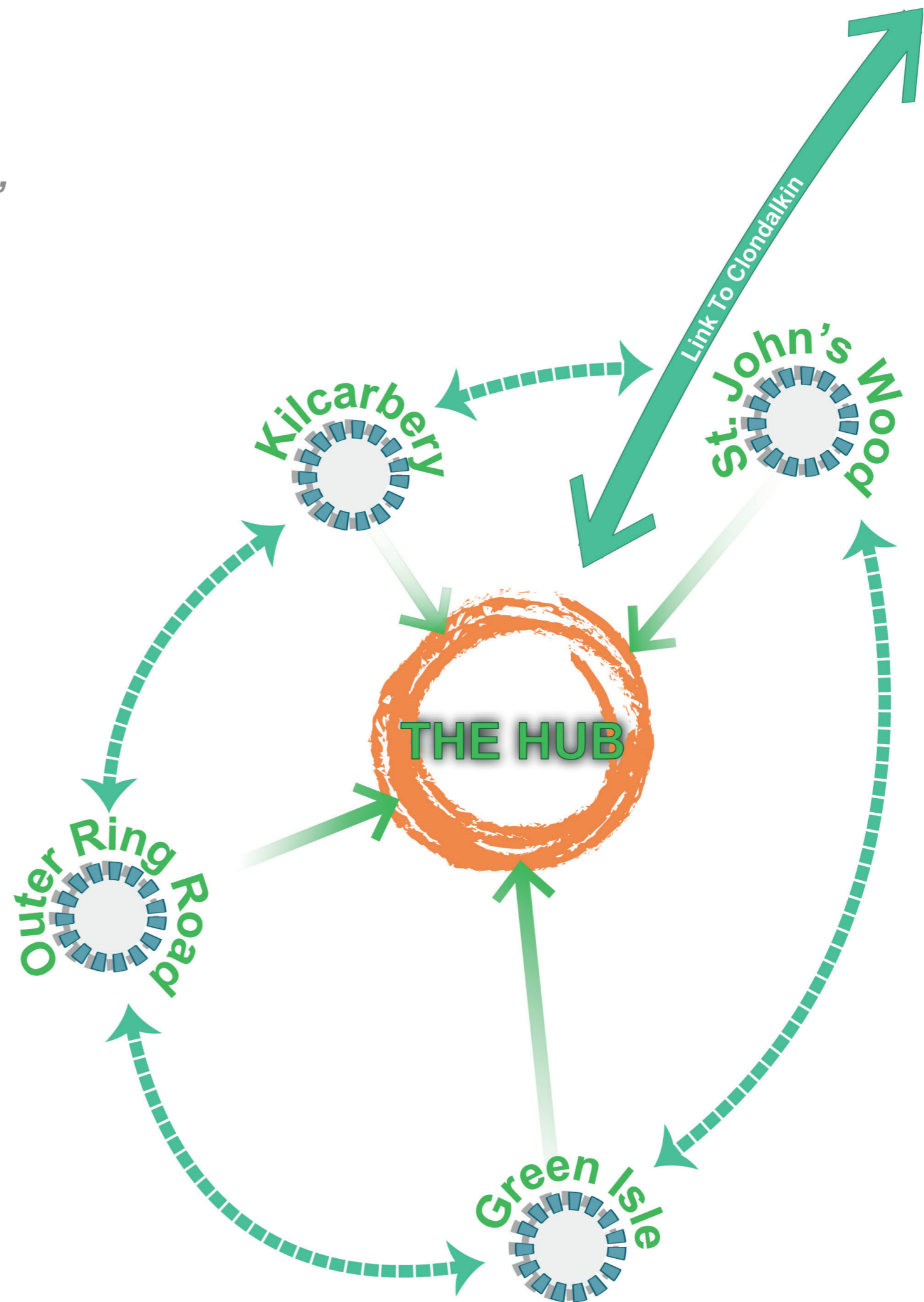

WAYFINDING AND SIGNAGE - OVERALL APPROACH



WAYFINDING AND SIGNAGE - FAMILY OF COHERENT SIGNAGE

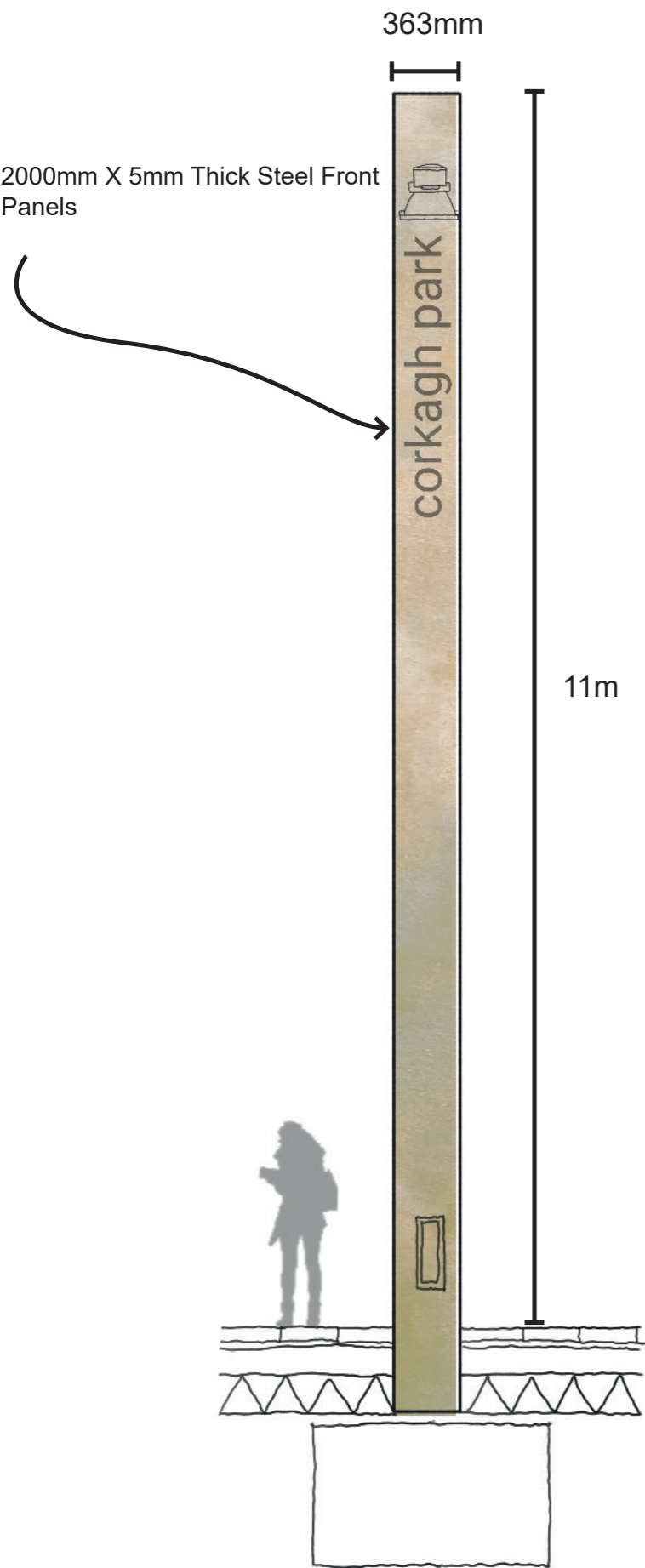

To be manufactured as 10 to 50mm plates (subject to detail design.)

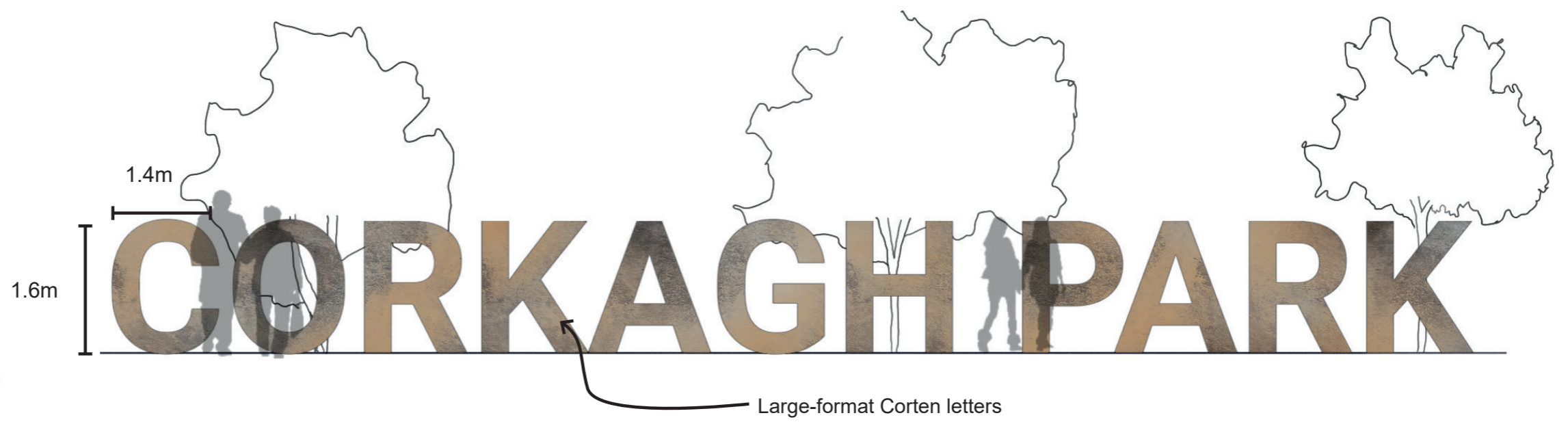

WAYFINDING AND SIGNAGE - FAMILY OF COHERENT SIGNAGE

Destinations

- | | |
|-------------------------------|---------------------------------------|
| 1. Camac Valley Camping Park. | 10. Famine Arboretum. |
| 2. Green Isle Car Park. | 11. Playground. |
| 3. Cycle Track. | 12. St. John's Wood Car Park. |
| 4. Corkagh Park Dog Run. | 13. Clondalkin Village. |
| 5. Adamstown Cricket Club. | 14. Fairy Woodland Trail |
| 6. Fishing Lakes. | 15. Sport Pavilion and Sports Pitches |
| 7. Walled Garden. | 16. Allotments |
| 8. Baseball Fields. | 17. Corkagh Urban Market |
| 9. Cafe. | |

10mm Corten Panel mounted to Cumaru timber post with Textured Map and Destinations.
100mm wide gravel strip at base.

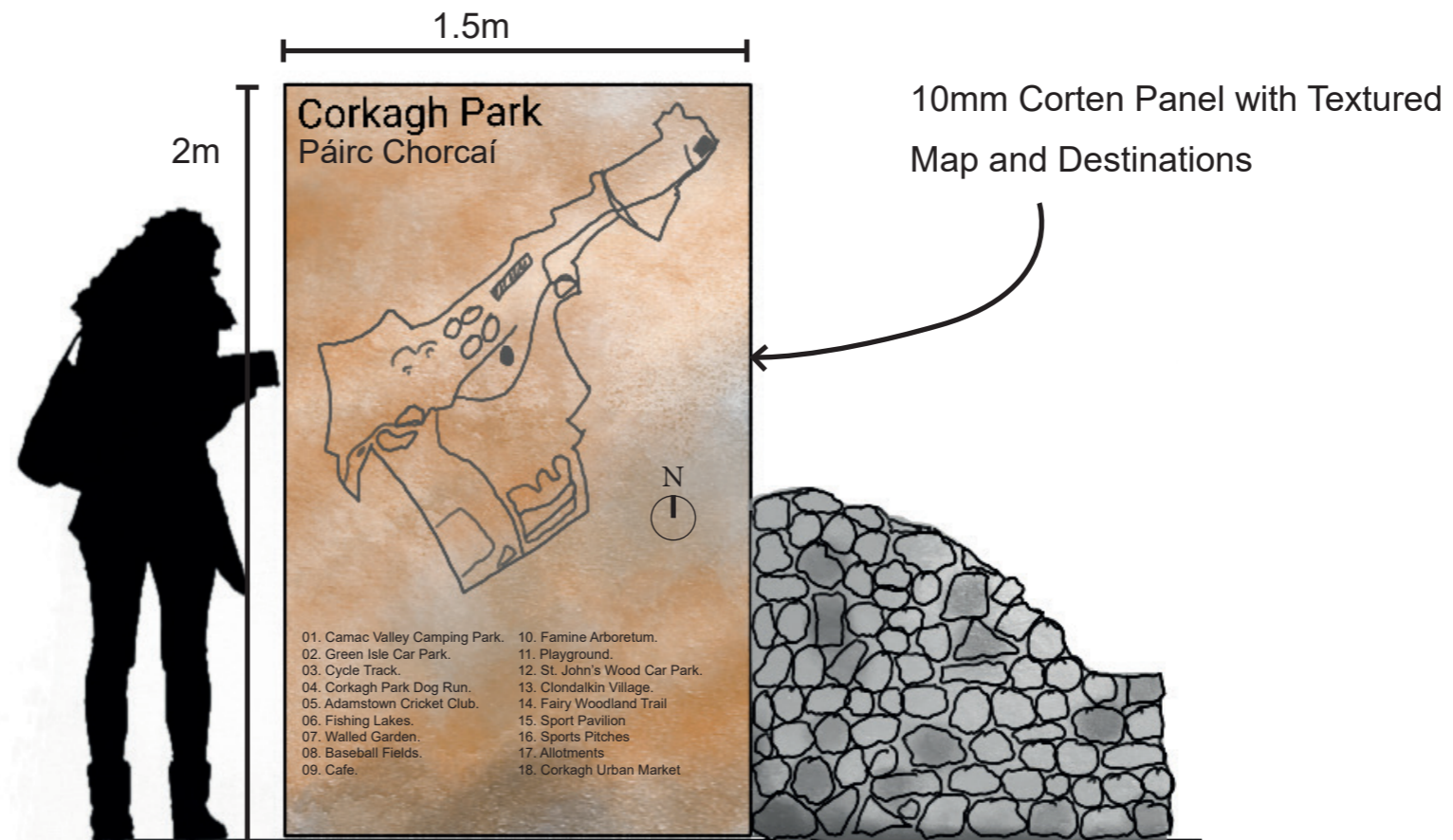
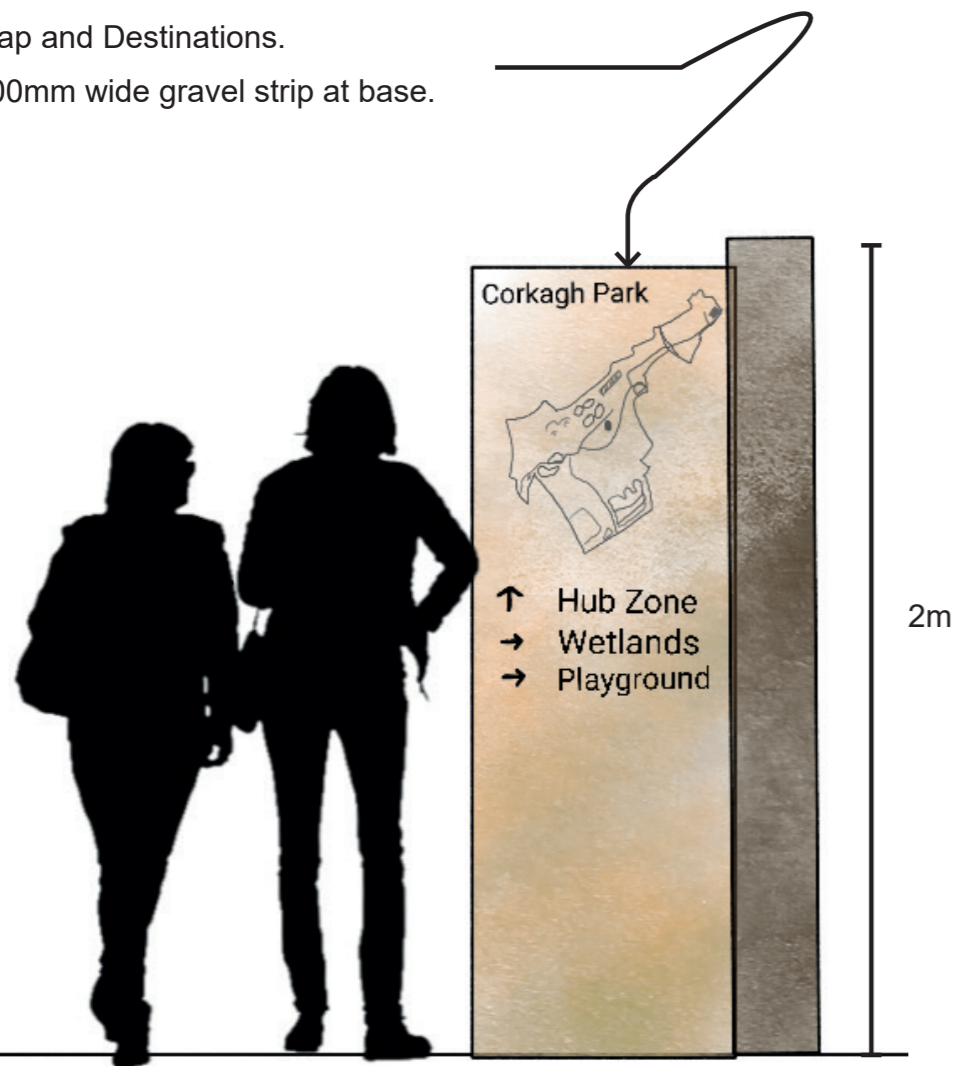

10mm Corten Panel with Textured Map and Destinations

THE HUB ZONE - CONCEPT



THE HUB ZONE - ARTIST'S IMPRESSION

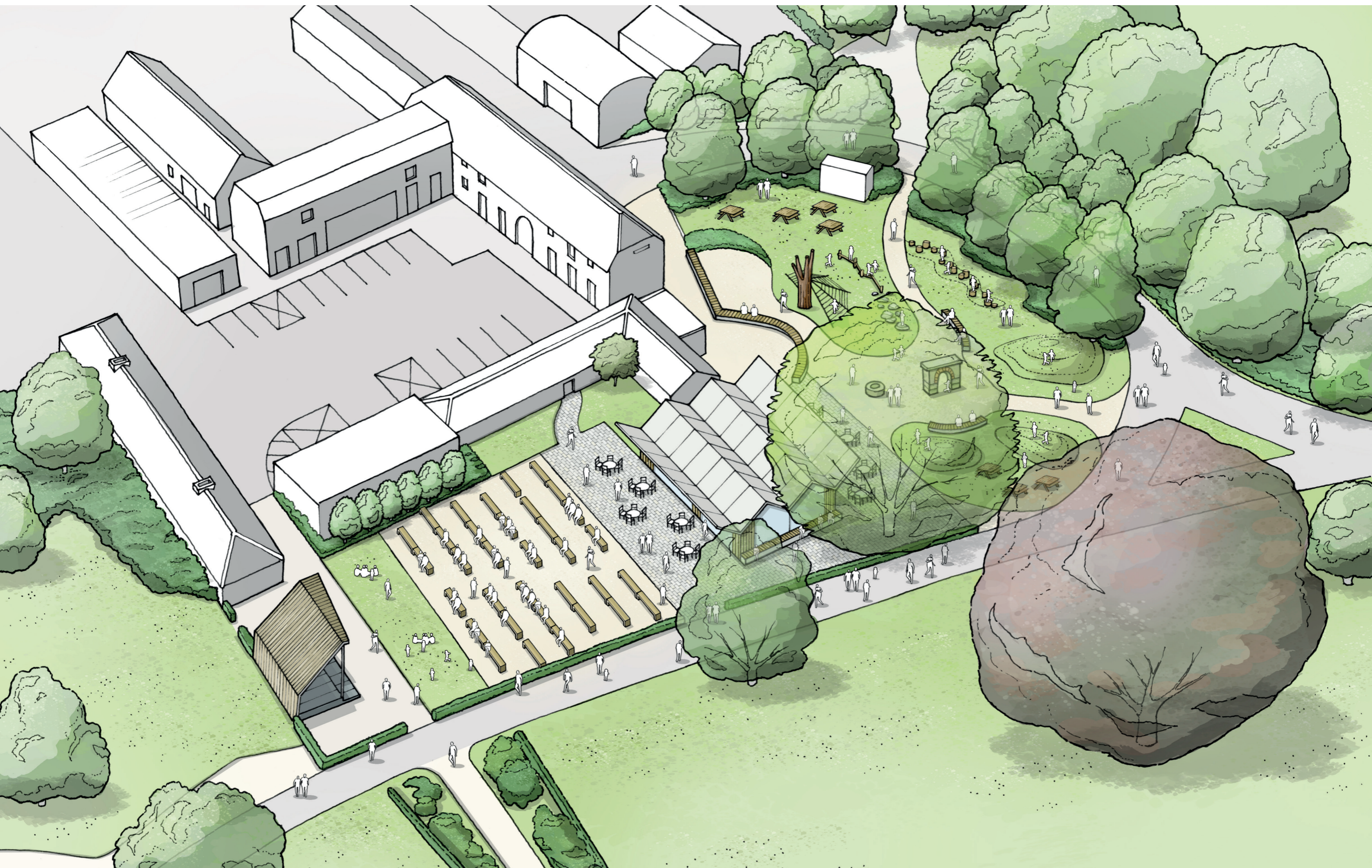

THE HUB ZONE - EMERGING DESIGN

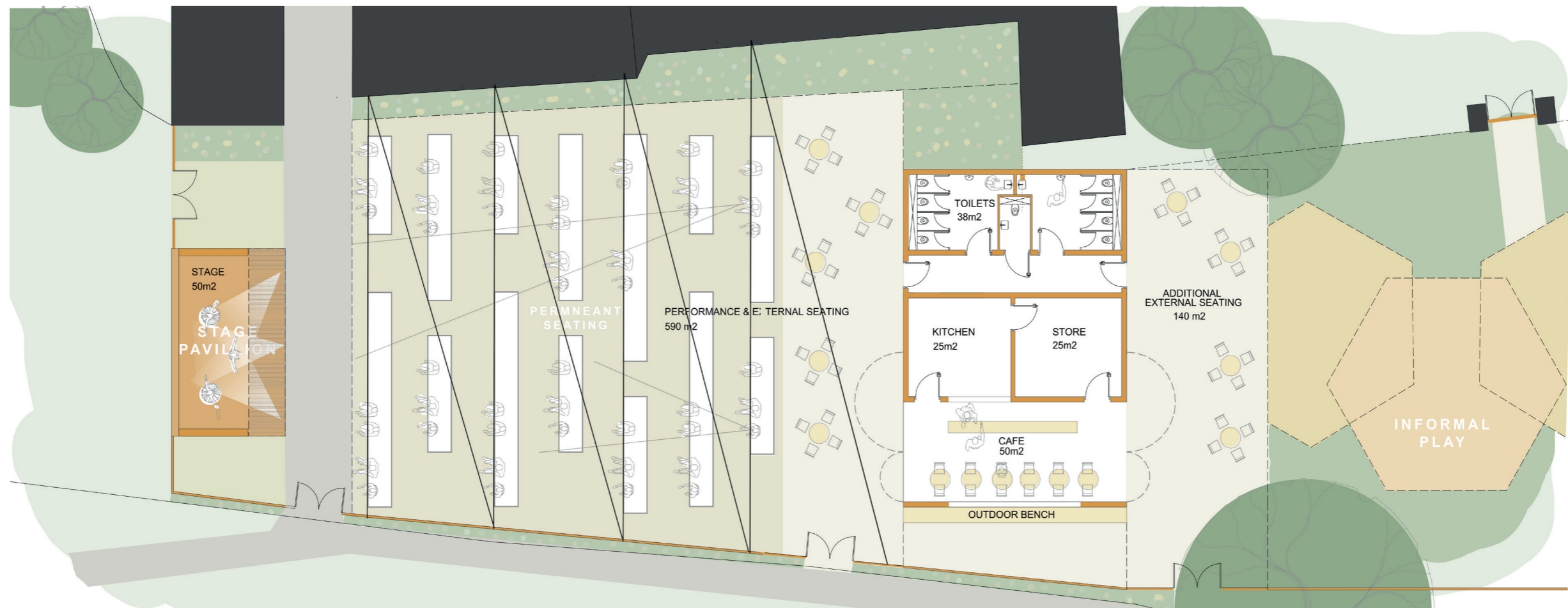

THE HUB ZONE - EMERGING DESIGN

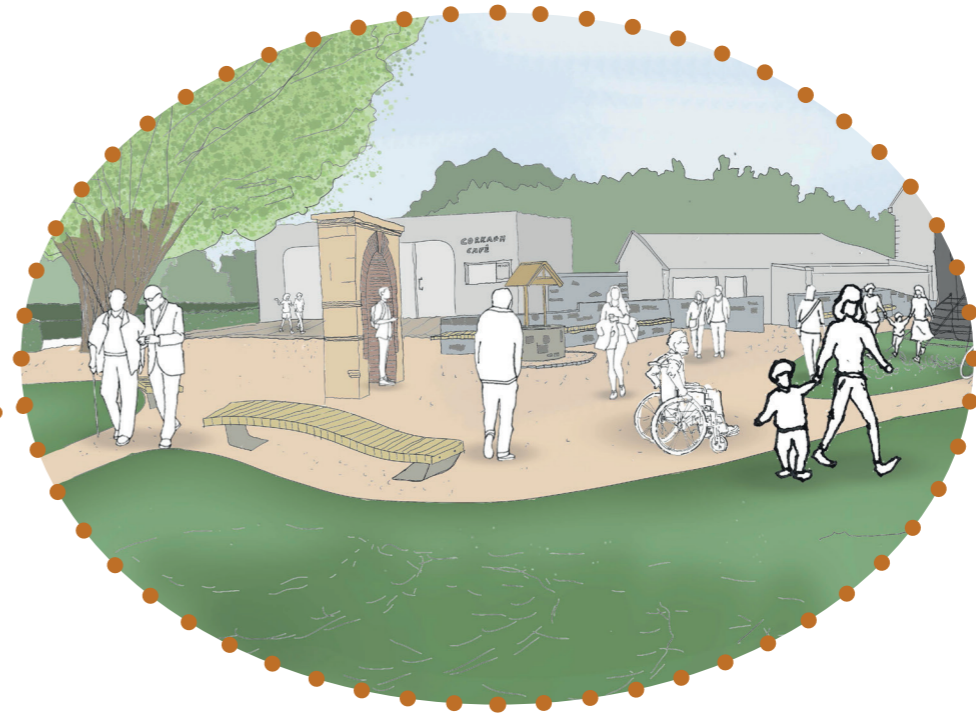
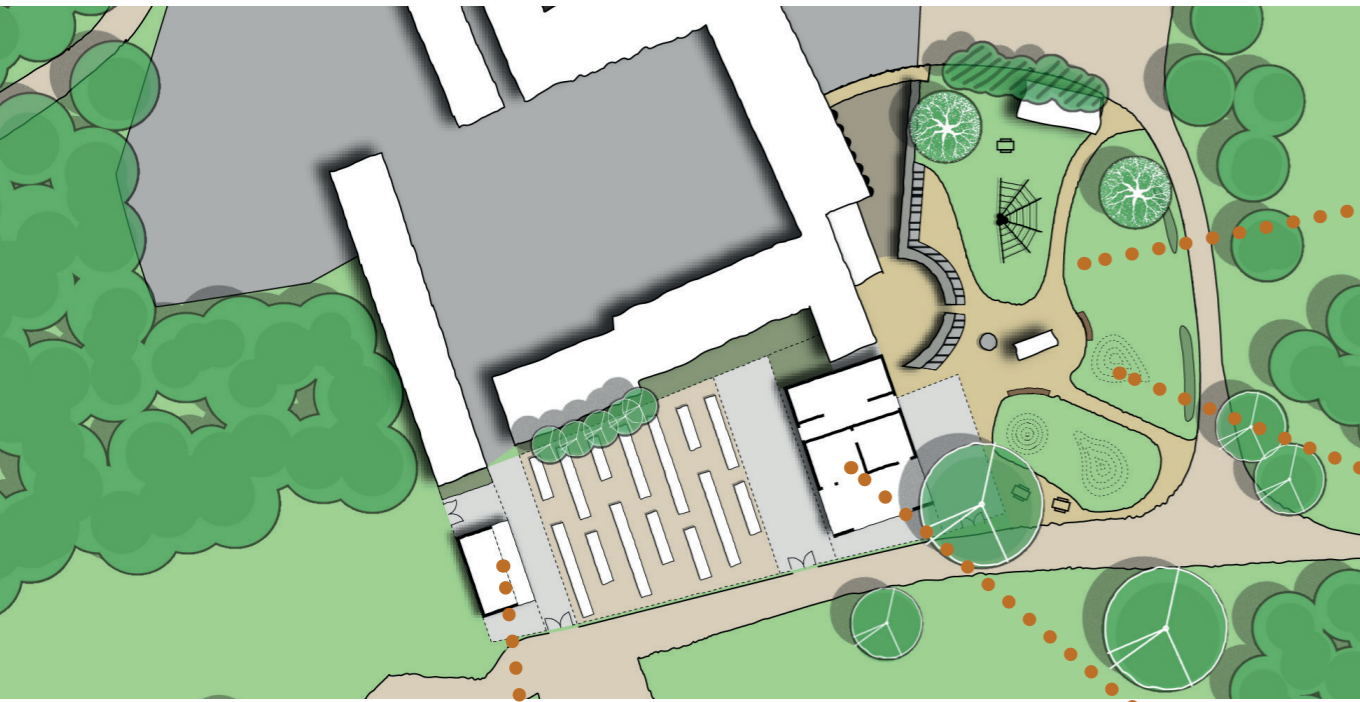

CAR PARKS AND KEY ENTRANCES



CAR PARK ENHANCEMENTS - ST. JOHN'S WOOD CAR PARK

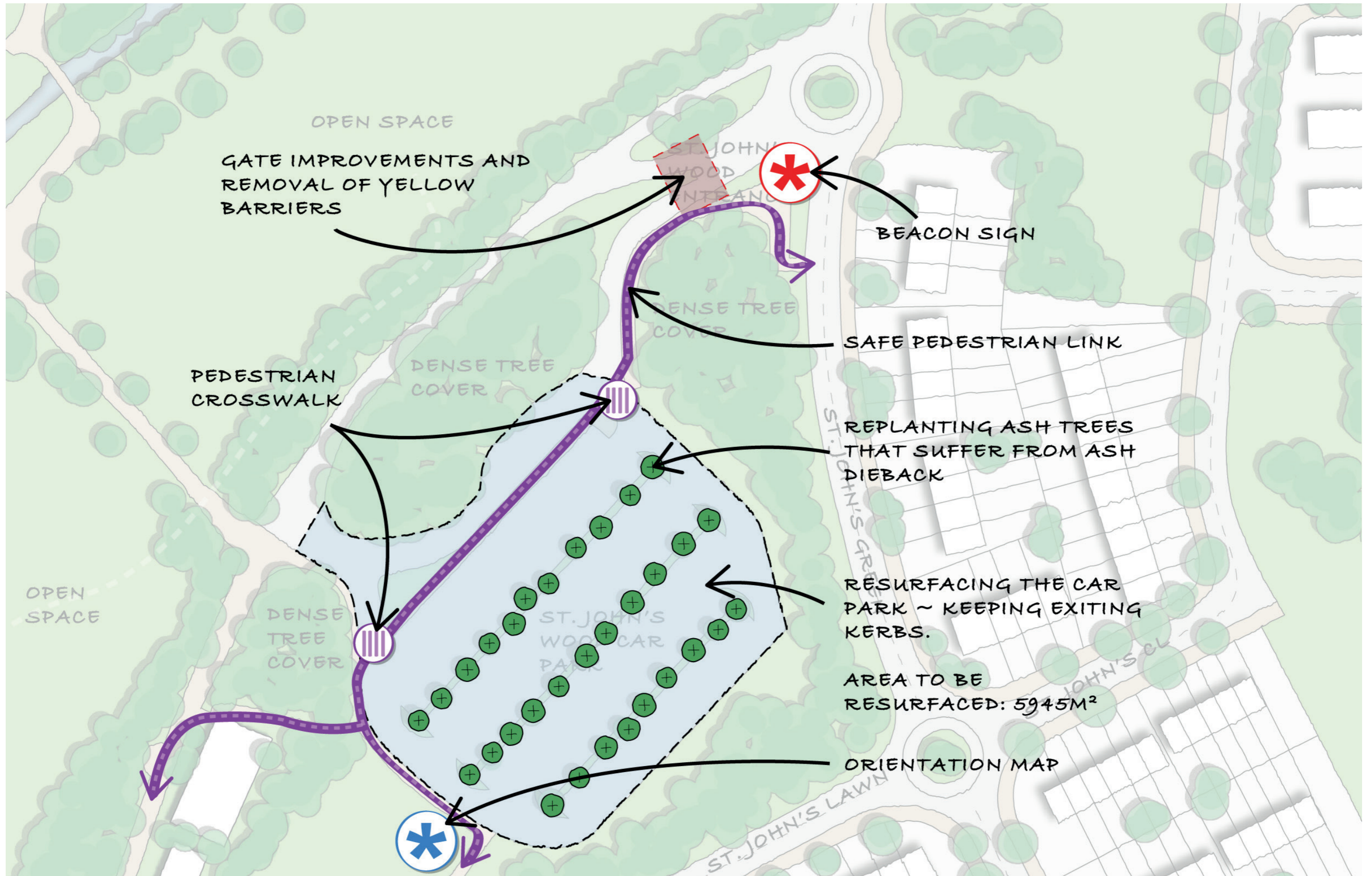

CAR PARK ENHANCEMENTS - ST. JOHN'S WOOD ENTRANCE



CAR PARK ENHANCEMENTS - GREEN ISLE CAR PARK

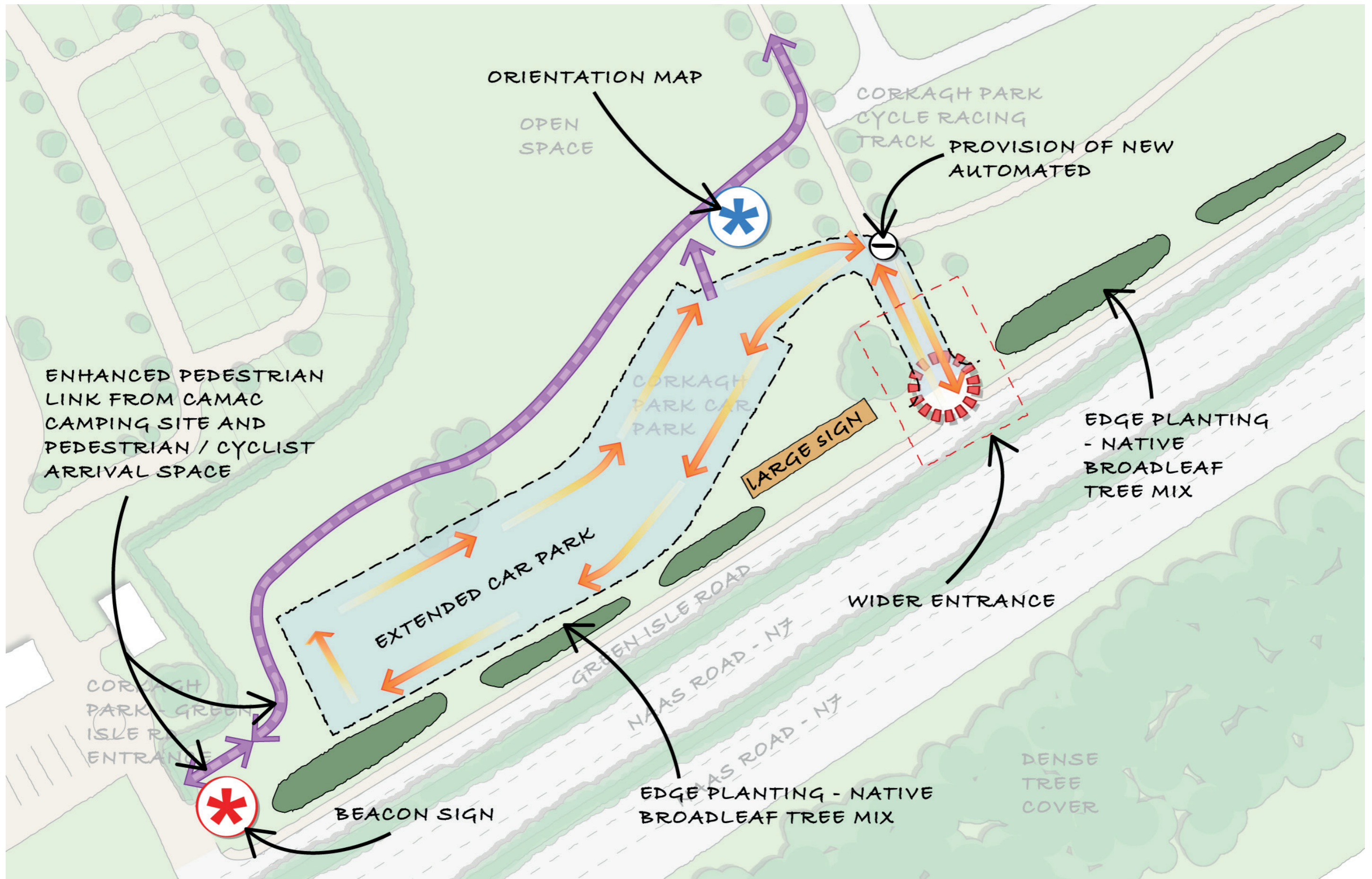



CORKAGH PARK

CAR PARK ENHANCEMENTS - OUTER RING ROAD

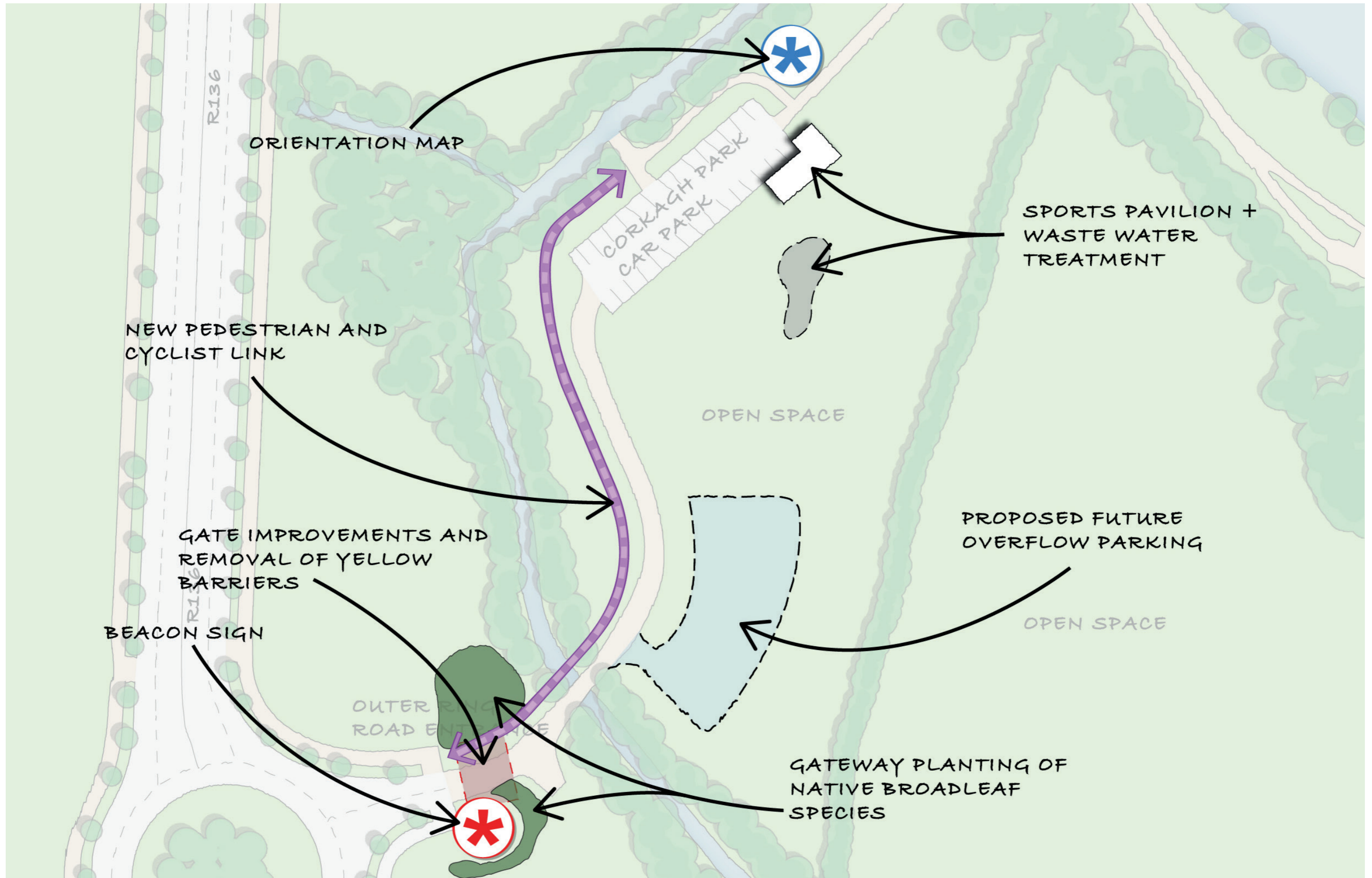

PRIMARY AND SECONDARY ROUTES

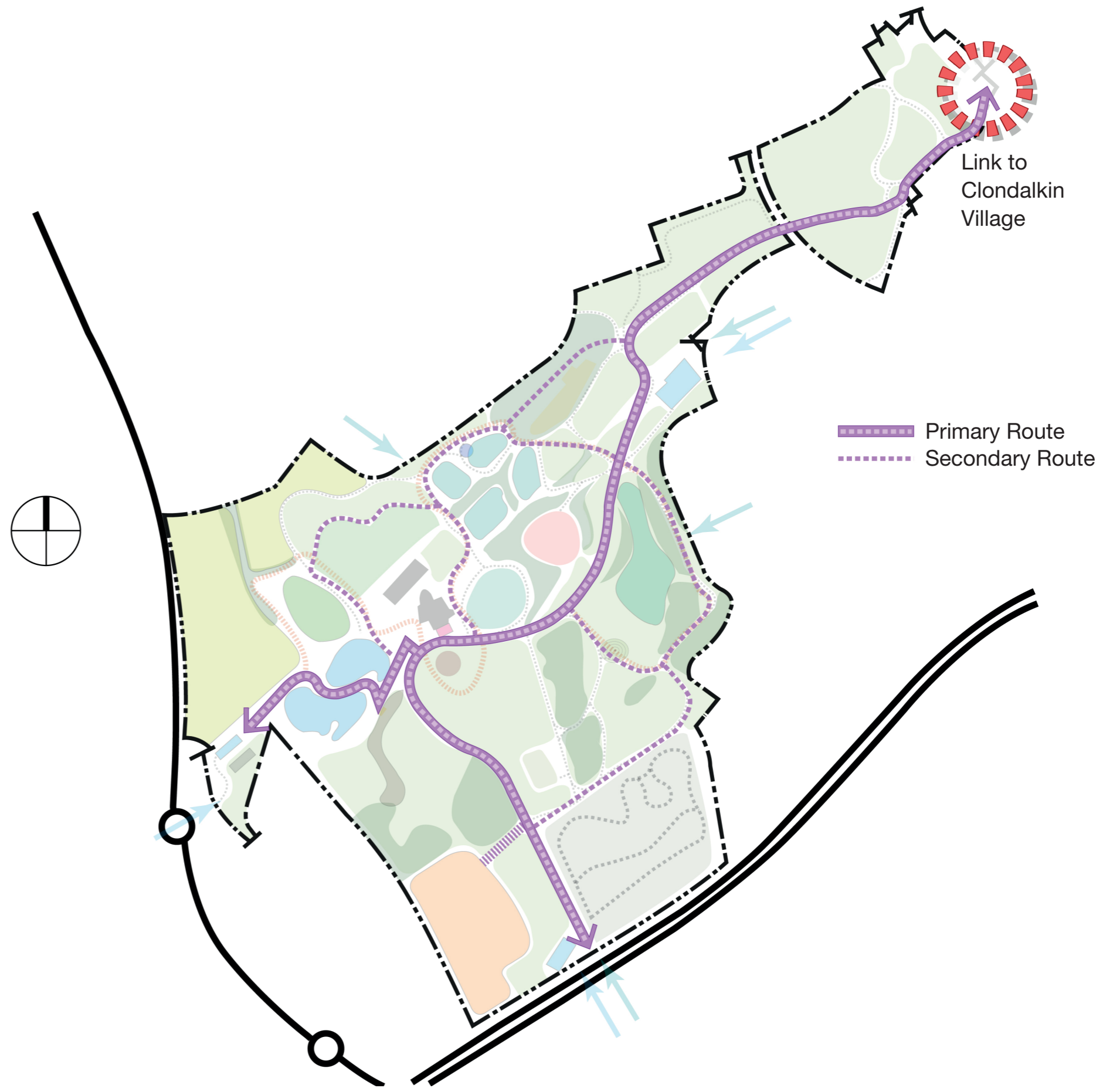

FAIRY WOODLAND TRAIL

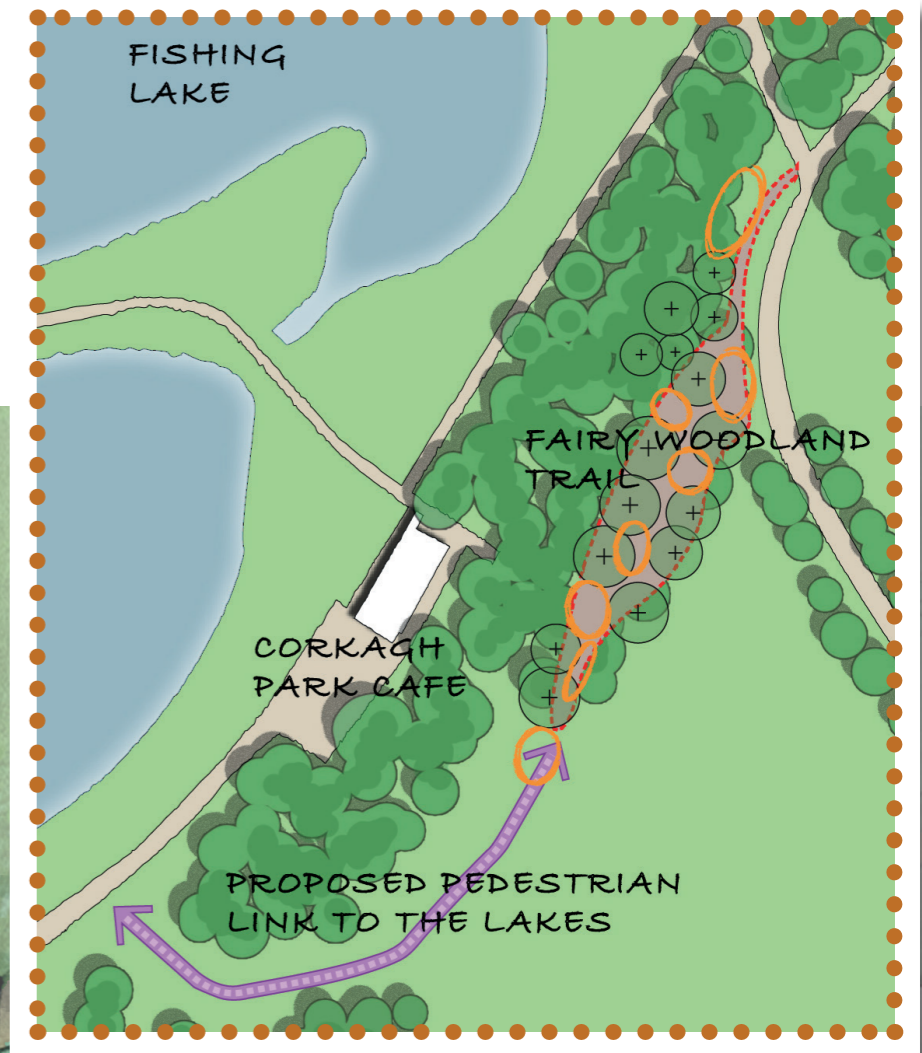

PART VIII APPLICATION CONTENTS

Park Entrances (Pedestrian and Vehicular)

Car Parks

Primary Paths, Secondary Paths and Tertiary Links

Wayfinding and Signage

Hub Zone Café, Events Space and Formal Landscaped Area

Fairy Woodland Trail

Enhanced Lake Viewing Platforms

Enhanced Planting throughout the Park

All required reports such as:

- AA Screening**
- EIA Screening**
- Conservation and Heritage**
- Flood Risk**

NEXT STEPS

1. Update to Elected Members.
2. Informal Pre-Part VIII Public Consultation.
 - Event Day in Park (subject to Govt. Guidance).
 - Online Teams Webinar.
3. Website Display of Information with Link / Email Address to Post Comments.
4. Initiate Part VIII following initial feedback and amendments early December.
5. Part VIII Information will be available on SDCC portal.



SHARE YOUR THOUGHTS

corkaghpark@bdp.com or
kevin.mcgann@bdp.com



BDP.