

AECOM
Roughan & O'Donovan

PROJECT
 GRANGE ROAD
 CYCLE ROUTE
 PHASE 2

CLIENT
 Comhairle Contae
 Átha Cliath Theas
 South Dublin County Council

Udarás
 Náisiúnta Iompair
 National Transport Authority

CONSULTANT
 AECOM
 4th Floor, Adelphi Plaza,
 George's Street Upper, Dun Laoghaire
 Co. Dublin, Ireland
 Tel:+353(0)1 2383100 Fax:+353(0)1 2383199
 www.aecom.com

NOTES:

- THIS DRAWING IS TO BE READ IN CONJUNCTION WITH ALL OTHER RELEVANT ENGINEERING DRAWINGS. ANY DISCREPANCIES, ERRORS OR OMISSIONS TO BE BROUGHT TO THE ATTENTION OF THE EMPLOYER.
- ALL DIMENSIONS TO BE CHECKED BY THE CONTRACTOR ON SITE PRIOR TO COMMENCEMENT OF WORKS.
- EMPLOYER'S REPRESENTATIVE TO BE INFORMED BY THE CONTRACTOR OF ANY DISCREPANCIES PRIOR TO THE COMMENCEMENT OF WORKS ON SITE.
- DIMENSIONS OF ALL BOUNDARIES AND ADJOINING ROADS TO BE CHECKED ON SITE PRIOR TO COMMENCEMENT OF WORKS.
- ALL MEASUREMENTS AND COORDINATES TO BE CHECKED ON SITE.
- REFER TO SPECIFICATION APPENDICES 12/1, 12/3 AND 12/70.

ISSUE/REVISION

NO.	DATE	DESCRIPTION
A	12/06/2020	ISSUED FOR TENDER
I/R		

KEY PLAN

PROJECT NUMBER
 60587303

SHEET TITLE
 TRAFFIC SIGNS AND
 ROAD MARKINGS
 SHEET 1 OF 4

SHEET NUMBER
 60587303_DD_1200.1

A TRAFFIC SIGNS AND ROAD MARKINGS
 Scale: 1:250

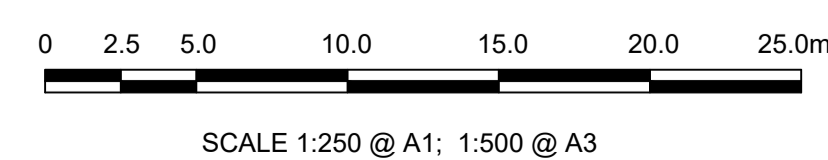

This drawing has been prepared for the use of AECOM's client. It may not be used, modified, reproduced or relied upon by third parties, except as agreed by AECOM or as required by law. AECOM accepts no responsibility, and denies any liability whatsoever, to any party that uses or relies on this drawing without AECOM's express written consent. Do not scale this document. All measurements must be obtained from the stated dimensions.

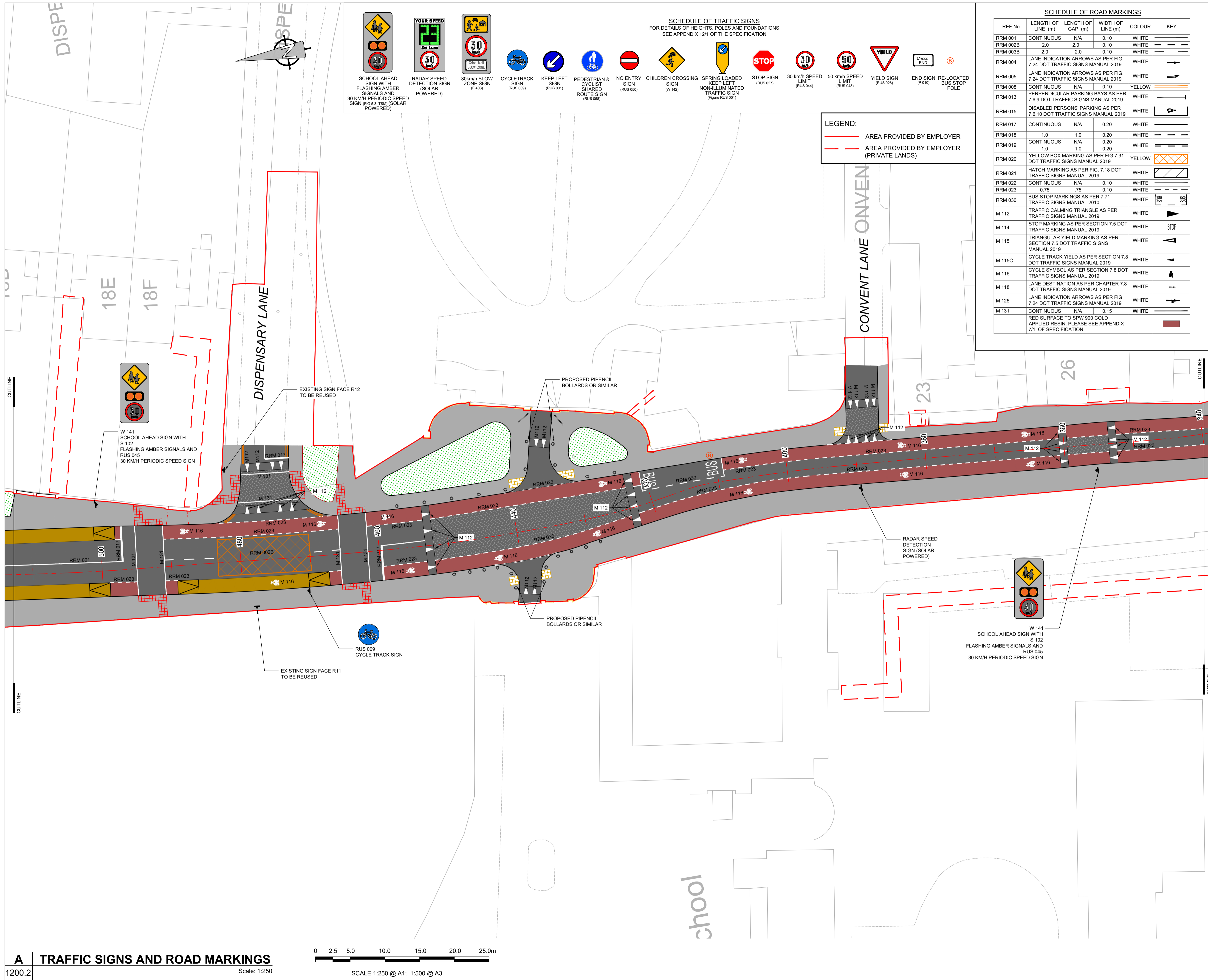

SCHEDULE OF TRAFFIC SIGNS
FOR DETAILS OF HEIGHTS, POLES AND FOUNDATIONS SEE APPENDIX 12/1 OF THE SPECIFICATION

SCHOOL AHEAD SIGN WITH FLASHING AMBER SIGNALS AND 30 KM/H PERIODIC SPEED SIGN (FIG 5.3. TSM) (SOLAR POWERED)	RADAR SPEED DETECTION SIGN (SOLAR POWERED)	30km/h SLOW ZONE SIGN (P 403)	CYCLETRACK SIGN (RUS 009)	KEEP LEFT SIGN (RUS 001)	PEDESTRIAN & CYCLIST SHARED ROUTE SIGN (RUS 008)	NO ENTRY SIGN (RUS 050)	CHILDREN CROSSING SIGN (W 142)	SPRING LOADED KEEP LEFT NON-ILLUMINATED TRAFFIC SIGN (Figure RUS 001)	STOP SIGN (RUS 027)	30 km/h SPEED LIMIT (RUS 044)	50 km/h SPEED LIMIT (RUS 043)	YIELD SIGN (RUS 028)	END SIGN (P 010)	RE-LOCATED BUS STOP POLE

LEGEND:
 - - - - - AREA PROVIDED BY EMPLOYER
 - - - - - AREA PROVIDED BY EMPLOYER (PRIVATE LANDS)

SCHEDULE OF ROAD MARKINGS

REF No.	LENGTH OF LINE (m)	LENGTH OF GAP (m)	WIDTH OF LINE (m)	COLOUR	KEY
RRM 001	CONTINUOUS	N/A	0.10	WHITE	---
RRM 002B	2.0	2.0	0.10	WHITE	--- ---
RRM 003B	2.0	2.0	0.10	WHITE	--- ---
RRM 004	LANE INDICATION ARROWS AS PER FIG. 7.24 DOT TRAFFIC SIGNS MANUAL 2019			WHITE	→
RRM 005	LANE INDICATION ARROWS AS PER FIG. 7.24 DOT TRAFFIC SIGNS MANUAL 2019			WHITE	→
RRM 008	CONTINUOUS	N/A	0.10	YELLOW	---
RRM 013	PERPENDICULAR PARKING BAYS AS PER 7.6.9 DOT TRAFFIC SIGNS MANUAL 2019			WHITE	⊥
RRM 015	DISABLED PERSONS' PARKING AS PER 7.6.10 DOT TRAFFIC SIGNS MANUAL 2019			WHITE	♿
RRM 017	CONTINUOUS	N/A	0.20	WHITE	---
RRM 018	1.0	1.0	0.20	WHITE	--- ---
RRM 019	CONTINUOUS	N/A	0.20	WHITE	---
RRM 020	YELLOW BOX MARKINGS AS PER FIG 7.31 DOT TRAFFIC SIGNS MANUAL 2019			YELLOW	⊠
RRM 021	HATCH MARKINGS AS PER FIG. 7.18 DOT TRAFFIC SIGNS MANUAL 2019			WHITE	▨
RRM 022	CONTINUOUS	N/A	0.10	WHITE	---
RRM 023	0.75	75	0.10	WHITE	--- ---
RRM 030	BUS STOP MARKINGS AS PER 7.71 TRAFFIC SIGNS MANUAL 2019			WHITE	⊥
M 112	TRAFFIC CALMING TRIANGLE AS PER TRAFFIC SIGNS MANUAL 2019			WHITE	▲
M 114	STOP MARKING AS PER SECTION 7.5 DOT TRAFFIC SIGNS MANUAL 2019			WHITE	■
M 115	TRIANGULAR YIELD MARKING AS PER SECTION 7.5 DOT TRAFFIC SIGNS MANUAL 2019			WHITE	▲
M 115C	CYCLE TRACK YIELD AS PER SECTION 7.8 DOT TRAFFIC SIGNS MANUAL 2019			WHITE	▲
M 116	CYCLE SYMBOL AS PER SECTION 7.8 DOT TRAFFIC SIGNS MANUAL 2019			WHITE	♻
M 118	LANE DESTINATION AS PER CHAPTER 7.8 DOT TRAFFIC SIGNS MANUAL 2019			WHITE	→
M 125	LANE INDICATION ARROWS AS PER FIG 7.24 DOT TRAFFIC SIGNS MANUAL 2019			WHITE	→
M 131	CONTINUOUS	N/A	0.15	WHITE	---
	RED SURFACE TO SPW 900 COLD APPLIED RESIN. PLEASE SEE APPENDIX 7/1 OF SPECIFICATION.				■



PROJECT

GRANGE ROAD CYCLE ROUTE PHASE 2

CLIENT



CONSULTANT

AECOM
 4th Floor, Adelphi Plaza,
 George's Street Upper, Dun Laoghaire
 Co. Dublin, Ireland
 Tel:+353(0)1 2383100 Fax:+353(0)1 2383199
 www.aecom.com

- NOTES:**
- THIS DRAWING IS TO BE READ IN CONJUNCTION WITH ALL OTHER RELEVANT ENGINEERING DRAWINGS. ANY DISCREPANCIES, ERRORS OR OMISSIONS TO BE BROUGHT TO THE ATTENTION OF THE EMPLOYER.
 - ALL DIMENSIONS TO BE CHECKED BY THE CONTRACTOR ON SITE PRIOR TO COMMENCEMENT OF WORKS.
 - EMPLOYER'S REPRESENTATIVE TO BE INFORMED BY THE CONTRACTOR OF ANY DISCREPANCIES PRIOR TO THE COMMENCEMENT OF WORKS ON SITE.
 - DIMENSIONS OF ALL BOUNDARIES AND ADJOINING ROADS TO BE CHECKED ON SITE PRIOR TO COMMENCEMENT OF WORKS.
 - ALL MEASUREMENTS AND COORDINATES TO BE CHECKED ON SITE.
 - REFER TO SPECIFICATION APPENDICES 12/1, 12/3 AND 12/70.

ISSUE/REVISION

I/R	DATE	DESCRIPTION
A	12/06/2020	ISSUED FOR TENDER

KEY PLAN

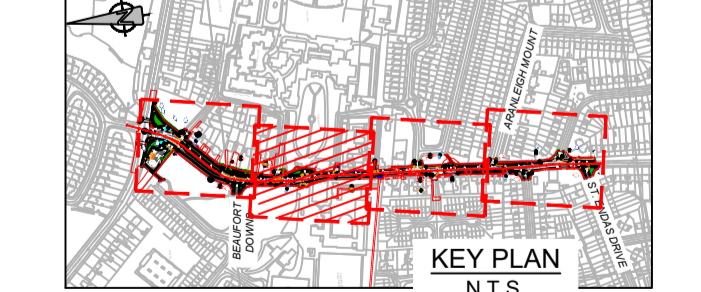

PROJECT NUMBER

60587303

SHEET TITLE

TRAFFIC SIGNS AND ROAD MARKINGS SHEET 2 OF 4

SHEET NUMBER

60587303_DD_1200.2

A TRAFFIC SIGNS AND ROAD MARKINGS

1200.2 Scale: 1:250



SCALE 1:250 @ A1; 1:500 @ A3

This drawing has been prepared for the use of AECOM's client. It may not be used, modified, reproduced or relied upon by third parties, except as agreed by AECOM or as required by law. AECOM accepts no responsibility, and denies any liability whatsoever, to any party that uses or relies on this drawing without AECOM's express written consent. Do not scale this document. All measurements must be obtained from the stated dimensions.

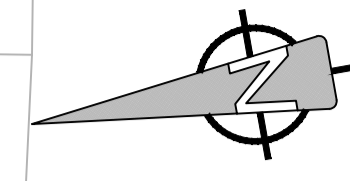

SCHEDULE OF TRAFFIC SIGNS
FOR DETAILS OF HEIGHTS, POLES AND FOUNDATIONS SEE APPENDIX 12/1 OF THE SPECIFICATION

SCHOOL AHEAD SIGN WITH FLASHING AMBER SIGNALS AND 30 KM/H PERIODIC SPEED SIGN (FIG 5.3.1.1) (SOLAR POWERED)	RADAR SPEED DETECTION SIGN (SOLAR POWERED)	30km/h SLOW ZONE SIGN (F 403)	CYCLETRACK SIGN (RUS 009)	KEEP LEFT SIGN (RUS 001)	PEDESTRIAN & CYCLIST SHARED ROUTE SIGN (RUS 058)	NO ENTRY SIGN (RUS 050)	CHILDREN CROSSING SIGN (W 142)	SPRING LOADED KEEP LEFT NON-ILLUMINATED TRAFFIC SIGN (Figure RUS 001)	STOP SIGN (RUS 027)	30 km/h SPEED LIMIT (RUS 044)	50 km/h SPEED LIMIT (RUS 043)	YIELD SIGN (RUS 026)	END SIGN (P 010)	RE-LOCATED BUS STOP POLE

SCHEDULE OF ROAD MARKINGS

REF No.	LENGTH OF LINE (m)	LENGTH OF GAP (m)	WIDTH OF LINE (m)	COLOUR	KEY
RRM 001	CONTINUOUS	N/A	0.10	WHITE	
RRM 002B	2.0	2.0	0.10	WHITE	
RRM 003B	2.0	2.0	0.10	WHITE	
RRM 004	LANE INDICATION ARROWS AS PER FIG. 7.24 DOT TRAFFIC SIGNS MANUAL 2019				WHITE
RRM 005	LANE INDICATION ARROWS AS PER FIG. 7.24 DOT TRAFFIC SIGNS MANUAL 2019				WHITE
RRM 008	CONTINUOUS	N/A	0.10	YELLOW	
RRM 013	PERPENDICULAR PARKING BAYS AS PER 7.6.9 DOT TRAFFIC SIGNS MANUAL 2019				WHITE
RRM 015	DISABLED PERSONS' PARKING AS PER 7.6.10 DOT TRAFFIC SIGNS MANUAL 2019				WHITE
RRM 017	CONTINUOUS	N/A	0.20	WHITE	
RRM 018	1.0	1.0	0.20	WHITE	
RRM 019	CONTINUOUS	N/A	0.20	WHITE	
RRM 020	YELLOW BOX MARKING AS PER FIG. 7.31 DOT TRAFFIC SIGNS MANUAL 2019				YELLOW
RRM 021	HATCH MARKING AS PER FIG. 7.18 DOT TRAFFIC SIGNS MANUAL 2019				WHITE
RRM 022	CONTINUOUS	N/A	0.10	WHITE	
RRM 023	0.75	75	0.10	WHITE	
RRM 030	BUS STOP MARKINGS AS PER 7.71 TRAFFIC SIGNS MANUAL 2019				WHITE
M 112	TRAFFIC CALMING TRIANGLE AS PER TRAFFIC SIGNS MANUAL 2019				WHITE
M 114	STOP MARKING AS PER SECTION 7.5 DOT TRAFFIC SIGNS MANUAL 2019				WHITE
M 115	TRIANGULAR YIELD MARKING AS PER SECTION 7.5 DOT TRAFFIC SIGNS MANUAL 2019				WHITE
M 115C	CYCLE TRACK YIELD AS PER SECTION 7.8 DOT TRAFFIC SIGNS MANUAL 2019				WHITE
M 116	CYCLE SYMBOL AS PER SECTION 7.8 DOT TRAFFIC SIGNS MANUAL 2019				WHITE
M 118	LANE DESTINATION AS PER CHAPTER 7.8 DOT TRAFFIC SIGNS MANUAL 2019				WHITE
M 125	LANE INDICATION ARROWS AS PER FIG. 7.24 DOT TRAFFIC SIGNS MANUAL 2019				WHITE
M 131	CONTINUOUS	N/A	0.15	WHITE	
	RED SURFACE TO SPW 900 COLD APPLIED RESIN. PLEASE SEE APPENDIX 7/1 OF SPECIFICATION.				

LEGEND:
 AREA PROVIDED BY EMPLOYER
 AREA PROVIDED BY EMPLOYER (PRIVATE LANDS)

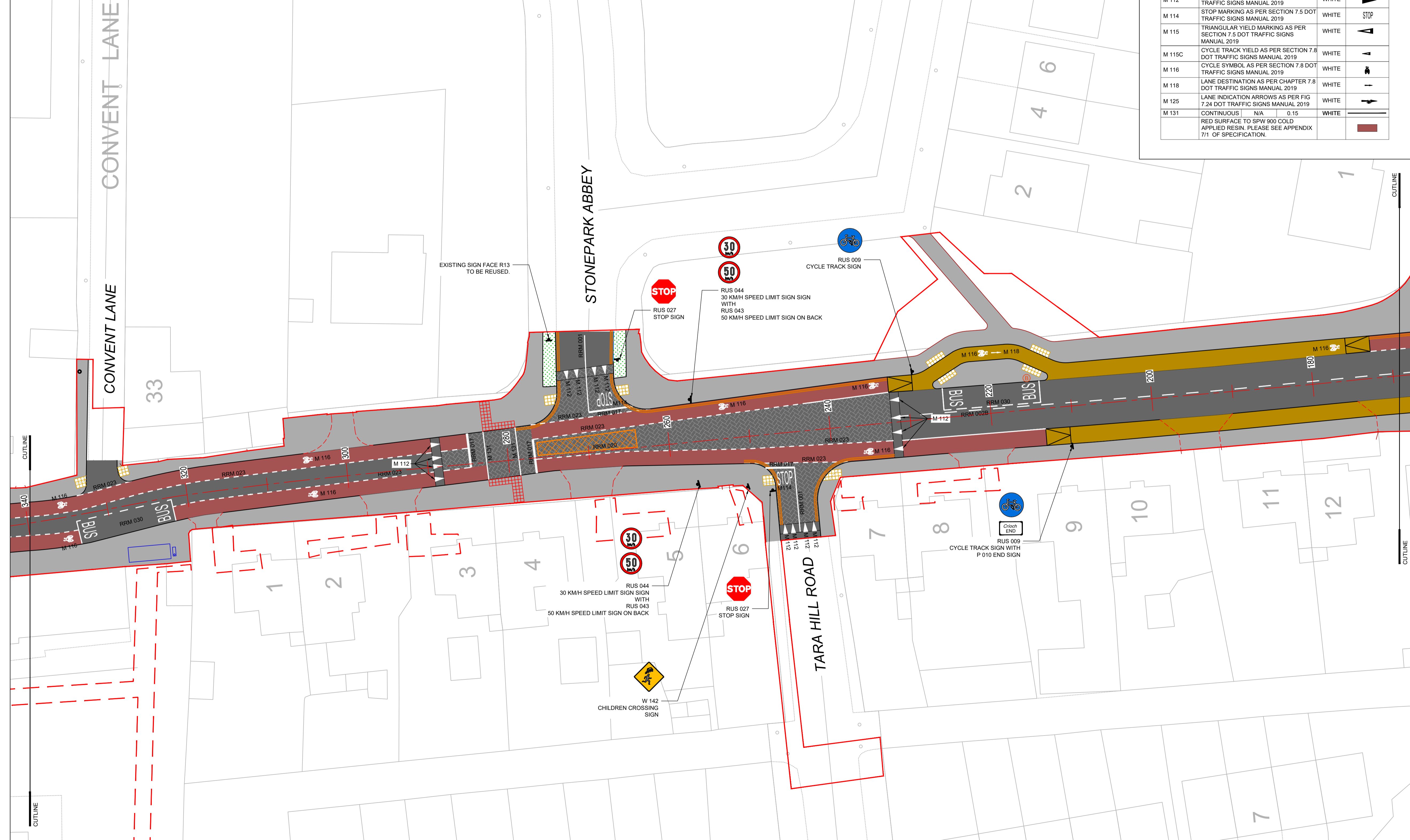

This drawing has been prepared for the use of AECOM's client. It may not be used, modified, reproduced or relied upon by third parties, except as agreed by AECOM or as required by law. AECOM accepts no responsibility, and denies any liability whatsoever, to any party that uses or relies on this drawing without AECOM's express written consent. Do not scale this document. All measurements must be obtained from the stated dimensions.

AECOM
Roughan & O'Donovan

PROJECT
GRANGE ROAD CYCLE ROUTE PHASE 2

CLIENT
 Comhairle Contae Átha Cliath Theas
 South Dublin County Council

CONSULTANT
 Udarás Náisiúnta Iompair
 National Transport Authority

AECOM
 4th Floor, Adelphi Plaza,
 George's Street Upper, Dun Laoghaire
 Co. Dublin, Ireland
 Tel:+353(0)1 2383100 Fax:+353(0)1 2383199
 www.aecom.com

- NOTES:**
- THIS DRAWING IS TO BE READ IN CONJUNCTION WITH ALL OTHER RELEVANT ENGINEERING DRAWINGS. ANY DISCREPANCIES, ERRORS OR OMISSIONS TO BE BROUGHT TO THE ATTENTION OF THE EMPLOYER.
 - ALL DIMENSIONS TO BE CHECKED BY THE CONTRACTOR ON SITE PRIOR TO COMMENCEMENT OF WORKS.
 - EMPLOYER'S REPRESENTATIVE TO BE INFORMED BY THE CONTRACTOR OF ANY DISCREPANCIES PRIOR TO THE COMMENCEMENT OF WORKS ON SITE.
 - DIMENSIONS OF ALL BOUNDARIES AND ADJOINING ROADS TO BE CHECKED ON SITE PRIOR TO COMMENCEMENT OF WORKS.
 - ALL MEASUREMENTS AND COORDINATES TO BE CHECKED ON SITE.
 - REFER TO SPECIFICATION APPENDICES 12/1, 12/3 AND 12/70.

ISSUE/REVISION

I/R	DATE	DESCRIPTION
A	12/06/2020	ISSUED FOR TENDER

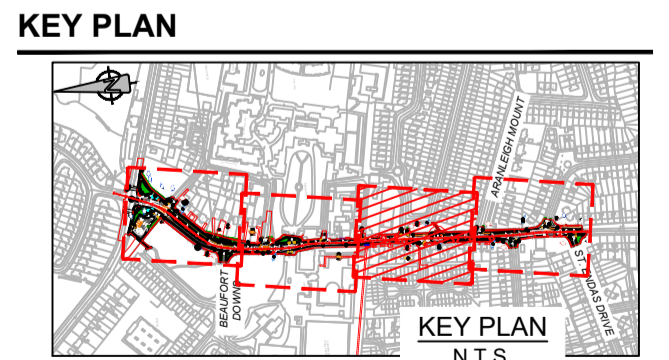

PROJECT NUMBER
60587303

SHEET TITLE
TRAFFIC SIGNS AND ROAD MARKINGS
SHEET 3 OF 4

SHEET NUMBER
60587303_DD_1200.3

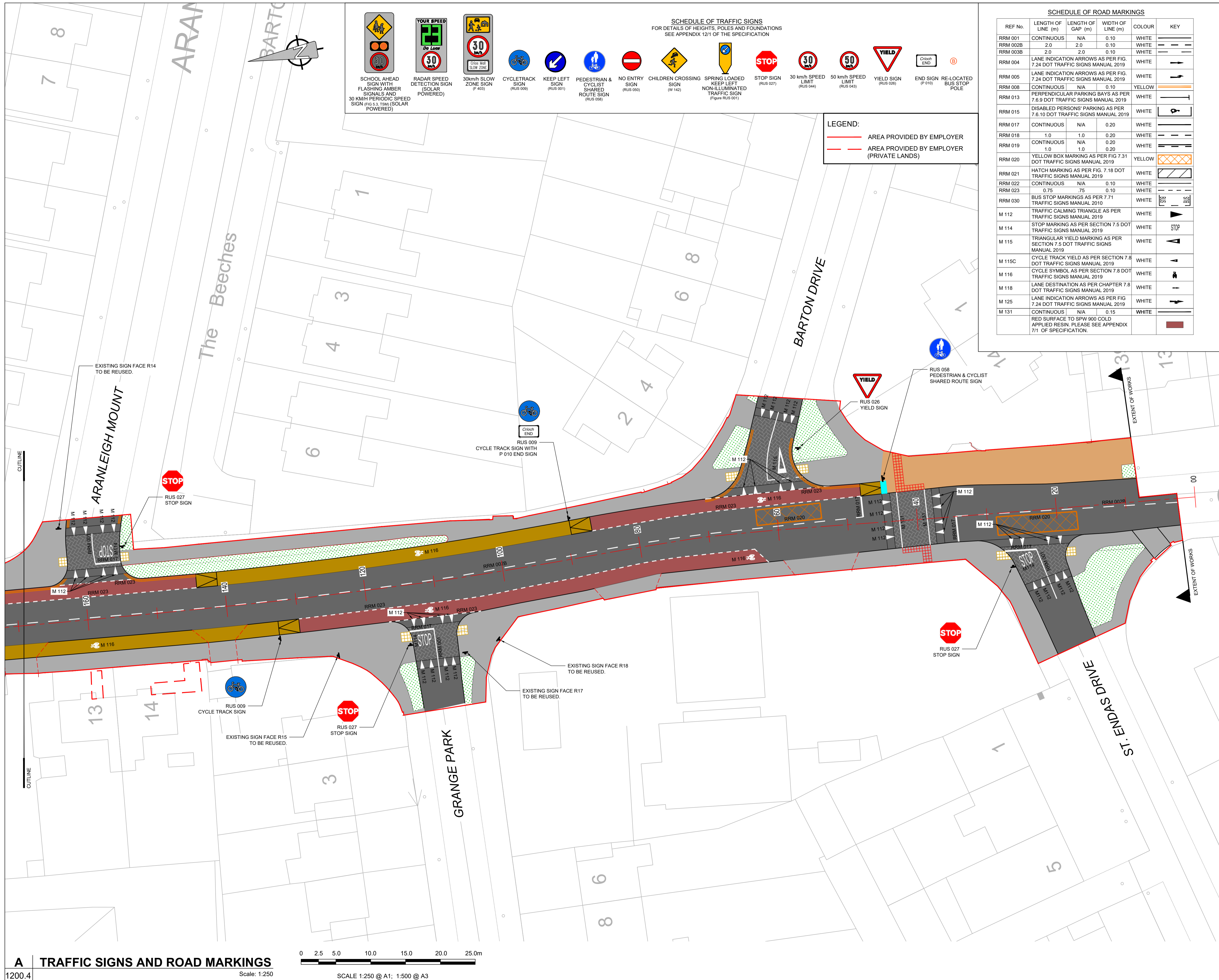

SCHEDULE OF TRAFFIC SIGNS
FOR DETAILS OF HEIGHTS, POLES AND FOUNDATIONS SEE APPENDIX 12/1 OF THE SPECIFICATION

SCHOOL AHEAD SIGN WITH FLASHING AMBER SIGNALS AND 30 KM/H PERIODIC SPEED SIGN (RUS 033) (SOLAR POWERED)	RADAR SPEED DETECTION SIGN (SOLAR POWERED)	30km/h SLOW ZONE SIGN (F 403)	CYCLETRACK SIGN (RUS 009)	KEEP LEFT SIGN (RUS 001)	PEDESTRIAN & CYCLIST SHARED ROUTE SIGN (RUS 058)	NO ENTRY SIGN (RUS 050)	CHILDREN CROSSING SIGN (W 142)	SPRING LOADED KEEP LEFT NON-ILLUMINATED TRAFFIC SIGN (Figure RUS 001)	STOP SIGN (RUS 027)	30 km/h SPEED LIMIT (RUS 044)	50 km/h SPEED LIMIT (RUS 043)	YIELD SIGN (RUS 026)	END SIGN (P 019)	RE-LOCATED BUS STOP POLE

LEGEND:
 - - - AREA PROVIDED BY EMPLOYER
 - - - AREA PROVIDED BY EMPLOYER (PRIVATE LANDS)

SCHEDULE OF ROAD MARKINGS

REF No.	LENGTH OF LINE (m)	LENGTH OF GAP (m)	WIDTH OF LINE (m)	COLOR	KEY
RRM 001	CONTINUOUS	N/A	0.10	WHITE	---
RRM 002B	2.0	2.0	0.10	WHITE	--- ---
RRM 003B	2.0	2.0	0.10	WHITE	--- ---
RRM 004	LANE INDICATION ARROWS AS PER FIG. 7.24 DOT TRAFFIC SIGNS MANUAL 2019			WHITE	→
RRM 005	LANE INDICATION ARROWS AS PER FIG. 7.24 DOT TRAFFIC SIGNS MANUAL 2019			WHITE	→
RRM 008	CONTINUOUS	N/A	0.10	WHITE	---
RRM 013	PERPENDICULAR PARKING BAYS AS PER 7.6.9 DOT TRAFFIC SIGNS MANUAL 2019			WHITE	⊥
RRM 015	DISABLED PERSONS' PARKING AS PER 7.6.10 DOT TRAFFIC SIGNS MANUAL 2019			WHITE	♿
RRM 017	CONTINUOUS	N/A	0.20	WHITE	---
RRM 018	1.0	1.0	0.20	WHITE	--- ---
RRM 019	CONTINUOUS	N/A	0.20	WHITE	---
RRM 020	YELLOW BOX MARKING AS PER FIG 7.31 DOT TRAFFIC SIGNS MANUAL 2019			YELLOW	⊠
RRM 021	HATCH MARKING AS PER FIG. 7.18 DOT TRAFFIC SIGNS MANUAL 2019			WHITE	▨
RRM 022	CONTINUOUS	N/A	0.10	WHITE	---
RRM 023	0.75	75	0.10	WHITE	--- ---
RRM 030	BUS STOP MARKINGS AS PER 7.71 DOT TRAFFIC SIGNS MANUAL 2019			WHITE	⊥
M 112	TRAFFIC CALMING TRIANGLE AS PER TRAFFIC SIGNS MANUAL 2019			WHITE	▲
M 114	STOP MARKING AS PER SECTION 7.5 DOT TRAFFIC SIGNS MANUAL 2019			WHITE	■
M 115	TRIANGULAR YIELD MARKING AS PER SECTION 7.5 DOT TRAFFIC SIGNS MANUAL 2019			WHITE	▲
M 115C	CYCLE TRACK YIELD AS PER SECTION 7.8 DOT TRAFFIC SIGNS MANUAL 2019			WHITE	▲
M 116	CYCLE SYMBOL AS PER SECTION 7.8 DOT TRAFFIC SIGNS MANUAL 2019			WHITE	♻
M 118	LANE DESTINATION AS PER CHAPTER 7.8 DOT TRAFFIC SIGNS MANUAL 2019			WHITE	→
M 125	LANE INDICATION ARROWS AS PER FIG 7.24 DOT TRAFFIC SIGNS MANUAL 2019			WHITE	→
M 131	CONTINUOUS	N/A	0.15	WHITE	---
	RED SURFACE TO SPW 900 COLD APPLIED RESIN. PLEASE SEE APPENDIX 7/1 OF SPECIFICATION.				■

ISSUE/REVISION

A/R	DATE	DESCRIPTION
A	12/06/2020	ISSUED FOR TENDER

