

GRANGE CASTLE WEST ACCESS ROAD

This drawing is produced using the Irish Transverse Mercator (ITM) Geographic Coordinate System

A1

LEGEND:

| | |
|---|--|
| PROPOSED CARRIAGEWAY | |
| PROPOSED ELEVATED CARRIAGEWAY | |
| PROPOSED OVERRUN | |
| PROPOSED OFF ROAD CYCLE TRACK | |
| PROPOSED ON ROAD CYCLE LANE | |
| PROPOSED FOOTPATH | |
| PROPOSED SHARED SURFACE | |
| PROPOSED BLISTER TACTILE PAVING (BUFF) | |
| PROPOSED BLISTER TACTILE PAVING (RED) | |
| PROPOSED SEGREGATED SHARED CYCLE TRACK/FOOTWAY TACTILE PAVING | |

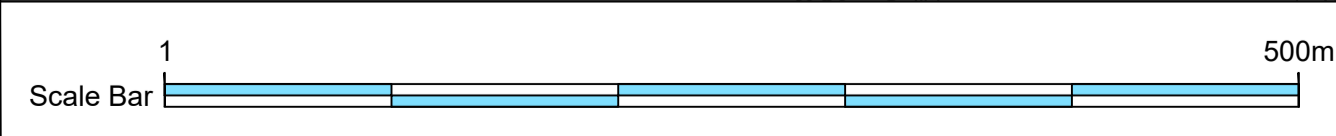
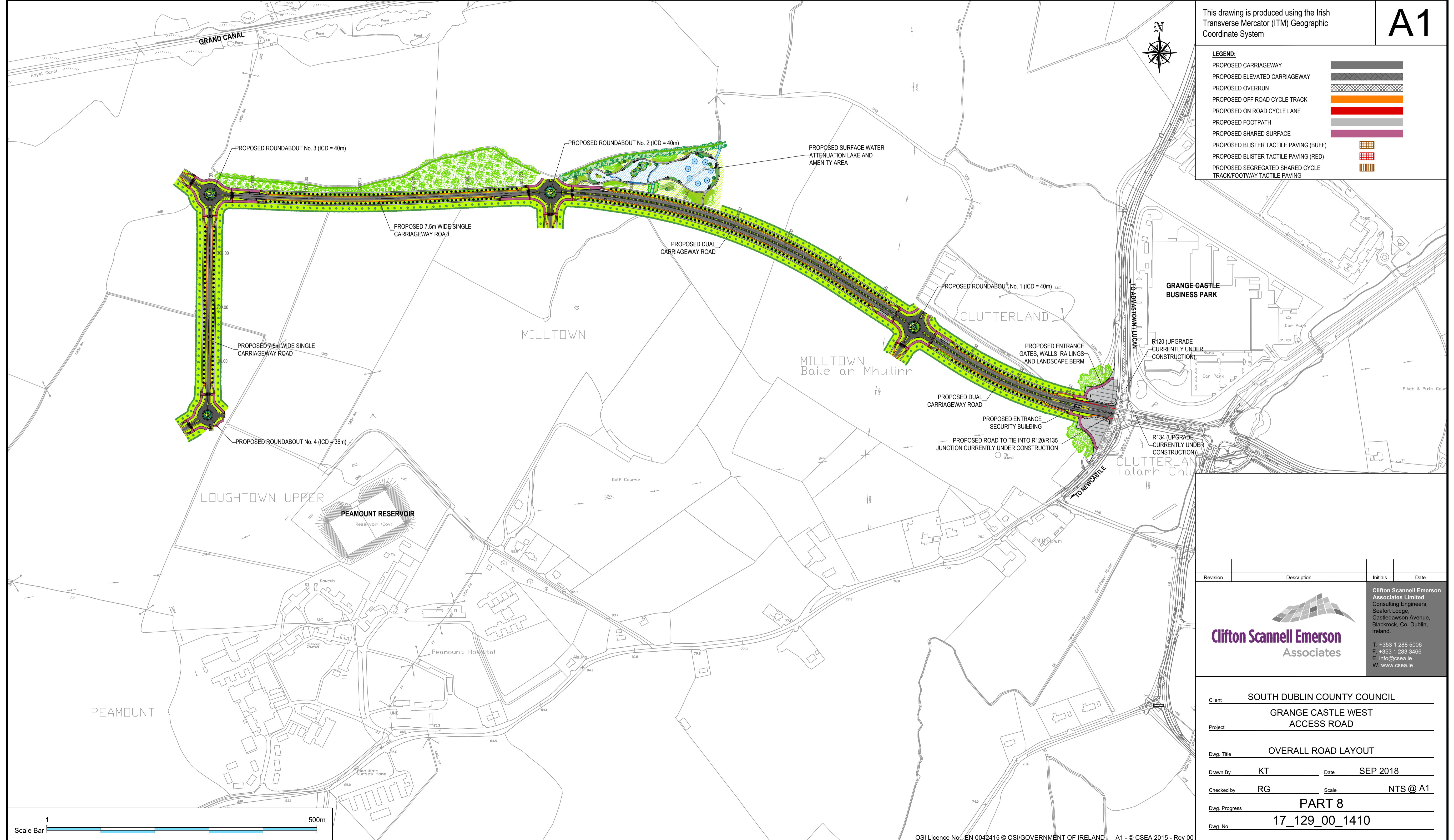

| Revision | Description | Initials | Date |
|----------|-------------|----------|------|
| | | | |

Clifton Scannell Emerson Associates Limited
 Consulting Engineers,
 Seafort Lodge,
 Castledawson Avenue,
 Blackrock, Co. Dublin,
 Ireland.
 T. +353 1 288 5006
 F. +353 1 283 3466
 E. info@csea.ie
 W. www.csea.ie

| | | | |
|---------------|--------------------------------|-------|----------|
| Client | SOUTH DUBLIN COUNTY COUNCIL | | |
| Project | GRANGE CASTLE WEST ACCESS ROAD | | |
| Dwg. Title | OVERALL ROAD LAYOUT | | |
| Drawn By | KT | Date | SEP 2018 |
| Checked by | RG | Scale | NTS @ A1 |
| Dwg. Progress | PART 8 | | |
| Dwg. No. | 17_129_00_1410 | | |