

All dimensions are in metres unless otherwise stated

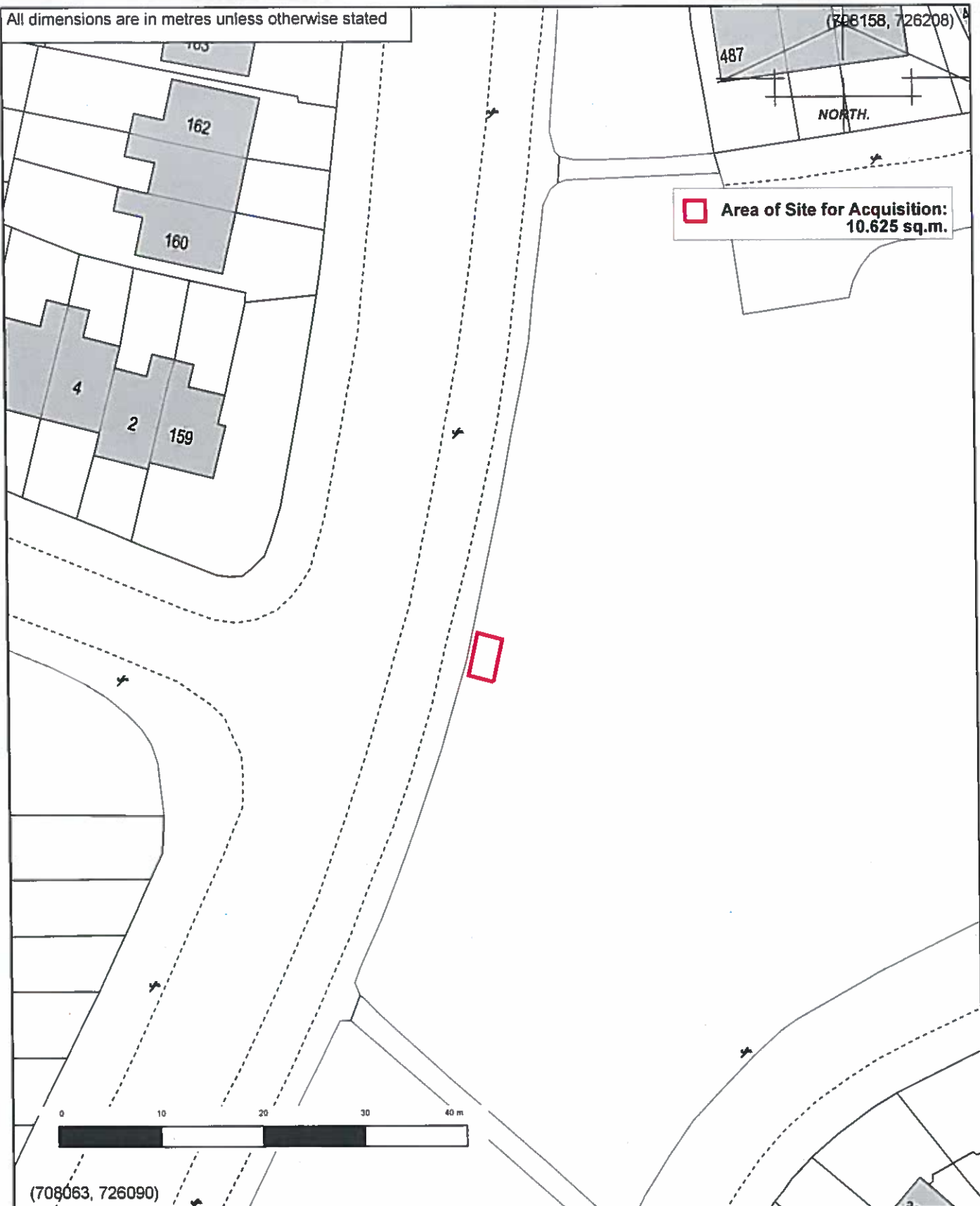

 Area of Site for Acquisition:
10.625 sq.m.



Design Department - DUBLIN

| | | | | |
|---|--------------|--|-----------|----------------|
| PROJECT | | DRI site acquisition at Killinarden Heights, Dublin 24 | | |
| AREA OF SITE | 10.625 sq.m. | LAND OWNER OR REPUTED LAND OWNER South Dublin County Council, County Hall, Belgard Square North, Tallaght, Dublin 24 | | |
| LENGTH OF WAYLEAVE | N/A | | | |
| REPRODUCED FROM THE ORDNANCE SURVEY BY PERMISSION OF THE GOVERNMENT. LICENCE No. 3-3-34 | O.S. REF. | 3390-21 | SCALE | 1:500 |
| | DATE | 28/03/2017 | REV. | 2 |
| | APPR'D. | KL | PROJ. NO. | 9910058 |
| | | | DRG. NO. | 9910058/ACQ/01 |
| | | | SH | 1 of 1 |
| | | | | REV 2 |