

School Grounds

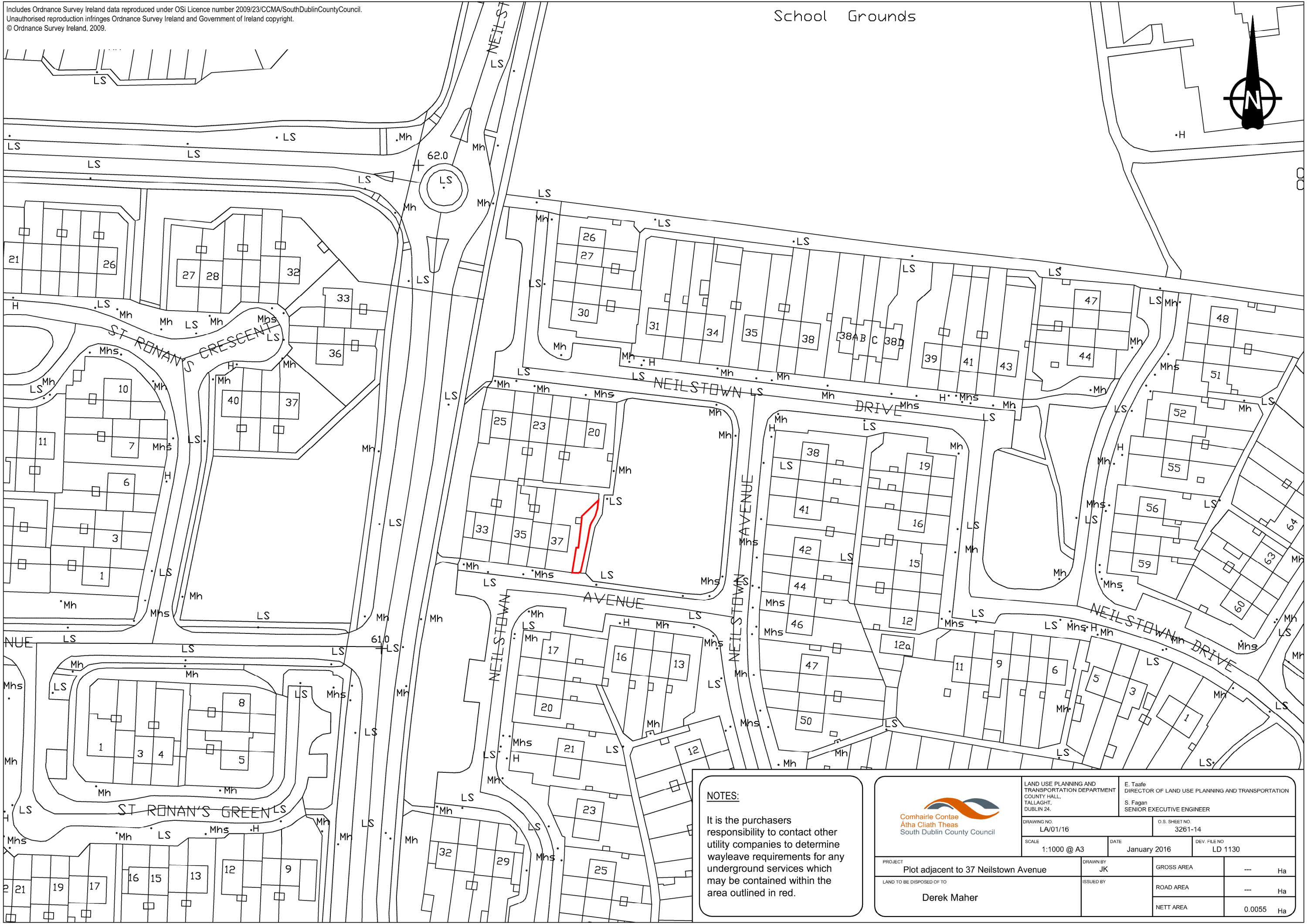

NOTES:

It is the purchasers responsibility to contact other utility companies to determine wayleave requirements for any underground services which may be contained within the area outlined in red.



LAND USE PLANNING AND TRANSPORTATION DEPARTMENT COUNTY HALL, TALLAGHT, DUBLIN 24.		E. Taaffe DIRECTOR OF LAND USE PLANNING AND TRANSPORTATION S. Fagan SENIOR EXECUTIVE ENGINEER	
DRAWING NO. LA/01/16		O.S. SHEET NO. 3261-14	
SCALE 1:1000 @ A3		DATE January 2016	DEV. FILE NO. LD 1130
PROJECT Plot adjacent to 37 Neilstown Avenue		DRAWN BY JK	GROSS AREA --- Ha
LAND TO BE DISPOSED OF TO Derek Maher		ISSUED BY	ROAD AREA --- Ha
			NETT AREA 0.0055 Ha