

Area to be deleted from
Tree Preservation Order

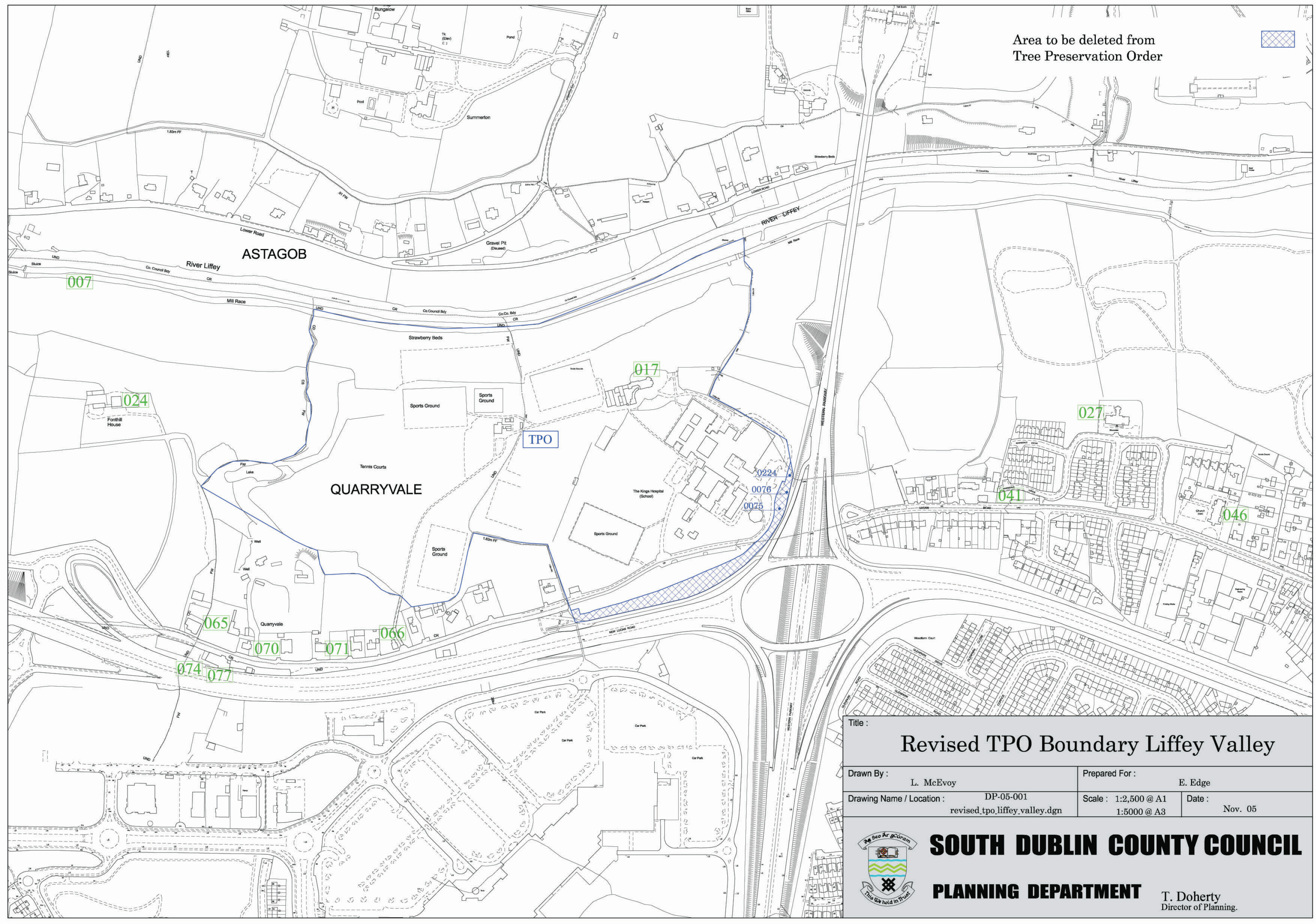

Title : Revised TPO Boundary Liffey Valley			
Drawn By :	L. McEvoy	Prepared For :	E. Edge
Drawing Name / Location :	DP-05-001 revised_tpo_liffey_valley.dgn	Scale : 1:2,500 @ A1 1:5000 @ A3	Date : Nov. 05



SOUTH DUBLIN COUNTY COUNCIL

PLANNING DEPARTMENT

T. Doherty
Director of Planning.