

This drawing is produced using the
Irish Grid
Geographic Coordinate System

A1

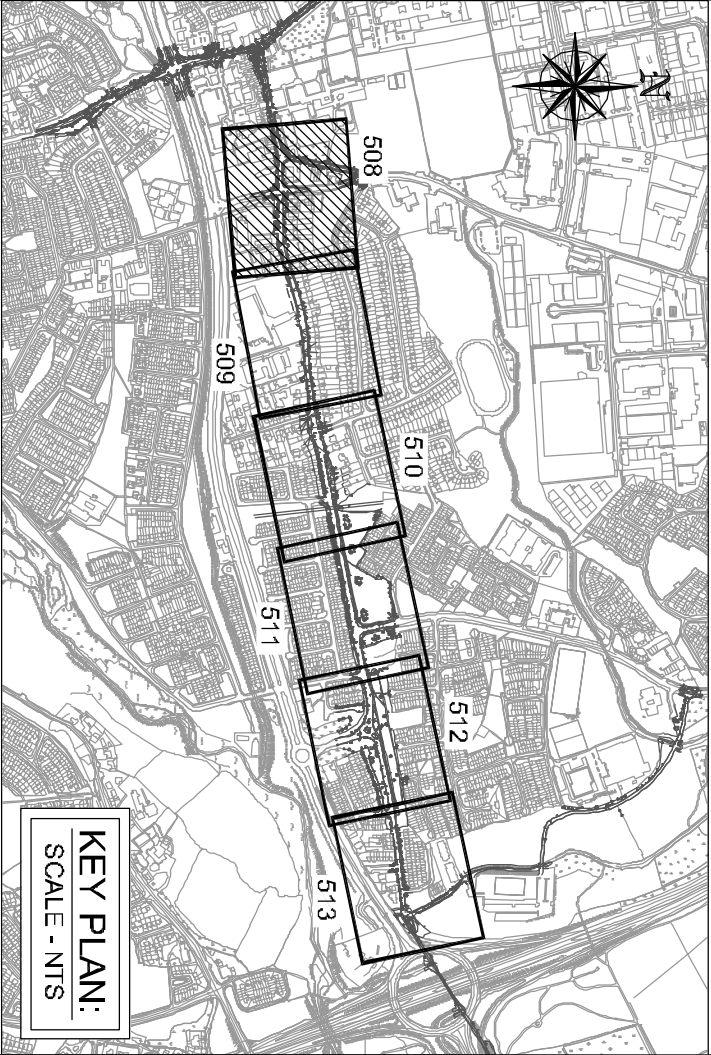

LEGEND:

EXISTING KERBLINE	---
PROPOSED 50mm UPSTAND EXTRUDED CONCRETE KERB / BEVELLED DROP KERB	---
PROPOSED 100mm UPSTAND EXTRUDED CONCRETE KERB / BEVELLED DROP KERB	---
PROPOSED 50mm UPSTAND DRAINAGE KERB / DRAINAGE DROP KERB	---
PROPOSED 100mm UPSTAND KERB BETWEEN CYCLE TRACK & FOOTPATH / BEVELLED DROP KERB	---
REINTEGRATED GRANITE KERB	---
PROPOSED KASSEL KERB	---
PROPOSED PARKLAND FENCE / GUARDRAIL	---
PAVEMENT TYPE 1	---
PAVEMENT TYPE 2	---
PAVEMENT TYPE 3	---
PROPOSED CONCRETE FOOTPATH	---
PROPOSED FOOTPATH FINISHED IN GRANITE PAVING 500 x 600mm	---
PROPOSED FOOTPATH FINISHED IN GRANITE PAVING 600 x 600mm	---
PROPOSED FOOTPATH FINISHED IN BRICK PAVING	---
PROPOSED RASBED CYCLETRACK	---
PROPOSED CONCRETE SHARED SURFACE	---
PROPOSED LANDSCAPED / GRASSED AREA	---
PROPOSED RAMP / ENTRY TREATMENT	---
PROPOSED CYCLIST RAMP	---
PROPOSED RAMP FROM ON ROAD TO RASBED OFF ROAD CYCLETRACK	---
PROPOSED TACTILE PAVING	---
PROPOSED TREE TO BE PLANTED	---
PROPOSED HEDGE PLANNING	---



Clifton Scannell Emerson
Associates

Clifton Scannell Emerson
Associates Limited
Consulting Engineers
Seaford Lodge
Castledawson Avenue,
Blackrock, Co. Dublin
Ireland
T. +353 1 288 6008
F. +353 1 288 3466
E. info@cse.ie
W. www.cse.ie

SOUTH DUBLIN COUNTY COUNCIL

Client
TALLAGHT TO TEMPLEOGUE CYCLE ROUTE SCHEME
Project
PHASE 1

Drawn By
SMP
Date
FEBRUARY 2015

Checked By
OD
Scale
1:500 @ A1

Drawn Progress
CONSTRUCTION
12_116B_508

- NOTE 1** - EXISTING Foul SEWER / SURFACE WATER CHAMBER TO BE UPGRADED TO A CARRIAGEWAY CHAMBER WITH D400 COVER AND FRAME SET TO FINISHED LEVELS AND EXISTING PIPEWORK RE-ROUTED TO CHAMBER ACCORDINGLY.
- NOTE 2** - EXISTING Foul SEWER / SURFACE WATER COVER AND FRAME TO BE RAISED / LOWERED TO PROPOSED LEVELS.
- NOTE 3** - EXISTING SARK COVER AND FRAME TO BE RAISED / LOWERED TO PROPOSED LEVELS.
- NOTE 4** - EXISTING GAS COVER AND FRAME TO BE RAISED / LOWERED TO PROPOSED LEVELS.
- NOTE 5** - EXISTING TELECOMS CHAMBER TO BE UPGRADED TO A CARRIAGEWAY CHAMBER WITH D400 COVER AND FRAME SET TO FINISHED LEVELS AND EXISTING DUCTING RE-ROUTED TO THE CHAMBER ACCORDINGLY.
- NOTE 6** - EXISTING FIRE HYDRANT COVER AND FRAME TO BE RAISED / LOWERED TO PROPOSED LEVELS.
- NOTE 7** - EXISTING TRAFFIC SIGNALS COVER AND FRAME TO BE RAISED / LOWERED TO PROPOSED LEVELS.
- NOTE 8** - EXISTING EARTH-HOOD TO BE RAISED / LOWERED TO PROPOSED LEVELS.
- NOTE 9** - EXISTING GAS COVER AND FRAME TO BE RAISED / LOWERED TO PROPOSED LEVELS.
- NOTE 10** - EXISTING GAS CHAMBER TO BE UPGRADED TO A CARRIAGEWAY CHAMBER WITH D400 COVER AND FRAME SET TO FINISHED LEVELS AND EXISTING DUCTING RE-ROUTED TO THE CHAMBER ACCORDINGLY.
- NOTE 11** - EXISTING FIRE HYDRANT COVER AND FRAME TO BE RAISED / LOWERED TO PROPOSED LEVELS.
- NOTE 12** - EXISTING FIRE HYDRANT CHAMBER TO BE UPGRADED TO A CARRIAGEWAY CHAMBER WITH D400 COVER AND FRAME SET TO FINISHED LEVELS AND EXISTING DUCTING RE-ROUTED TO THE CHAMBER ACCORDINGLY.
- NOTE 13** - EXISTING INSPECTION CHAMBER, COVER AND FRAME TO BE RAISED / LOWERED TO PROPOSED LEVELS.
- NOTE 14** - EXISTING INSPECTION CHAMBER TO BE UPGRADED TO A CARRIAGEWAY CHAMBER WITH D400 COVER AND FRAME SET TO FINISHED LEVELS AND EXISTING DUCTING RE-ROUTED TO THE CHAMBER ACCORDINGLY.
- NOTE 15** - EXISTING WATERMAIN VALVE CHAMBER, COVER AND FRAME TO BE RAISED / LOWERED TO PROPOSED LEVELS.
- NOTE 16** - EXISTING WATERMAIN VALVE CHAMBER TO BE UPGRADED TO A CARRIAGEWAY CHAMBER WITH D400 COVER AND FRAME SET TO FINISHED LEVELS AND EXISTING DUCTING RE-ROUTED TO THE CHAMBER ACCORDINGLY.

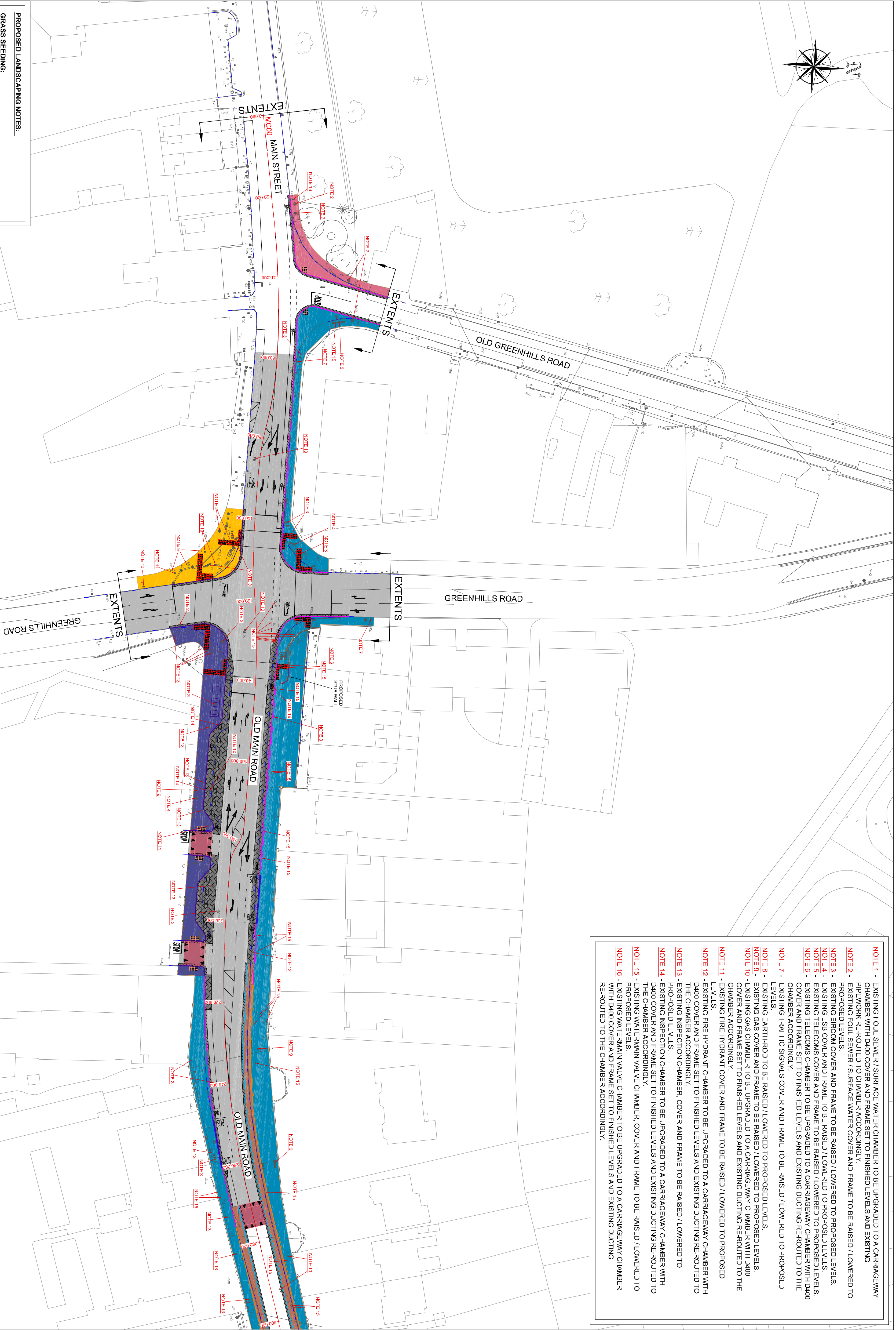

- PROPOSED LANDSCAPING NOTES:**
- GRASS SEEDING:**
- 30% TAYA DWARF PERENNIAL RYEGRASS
 - 20% GATOR DWARF PERENNIAL RYEGRASS
 - 50% CORRAL STRONG CREEPING RED FESCUE
 - APPLICATION RATE: 34-50g/m²
- HEDGING DOUBLE STAGGERED ROWS AT 6 PER LINEMETER**
- BOTANICAL NAME:**
- FEGUS SYLVANICA (BEECH HEDGING) HEDGEROW
 - SIZE: 60-90 cm BR 1+1 TRONS
- SPECIFICATION:**
- SHRUBS FOR HEDGES
 - CONSISTENT IN SPECIES
 - CULTIVAR AND CLONE TO ENSURE UNIFORM HEDGE
- PLANTING:**
- PLANT TRENCHES LARGE ENOUGH TO TAKE FULL SPREAD OF ROOT
 - WORKS TO BE CARRIED OUT IN ACCORDANCE WITH APPENDIX 6/5 AND SERIES 600