

Grange Castle Business Park Site Access Road - Part 8

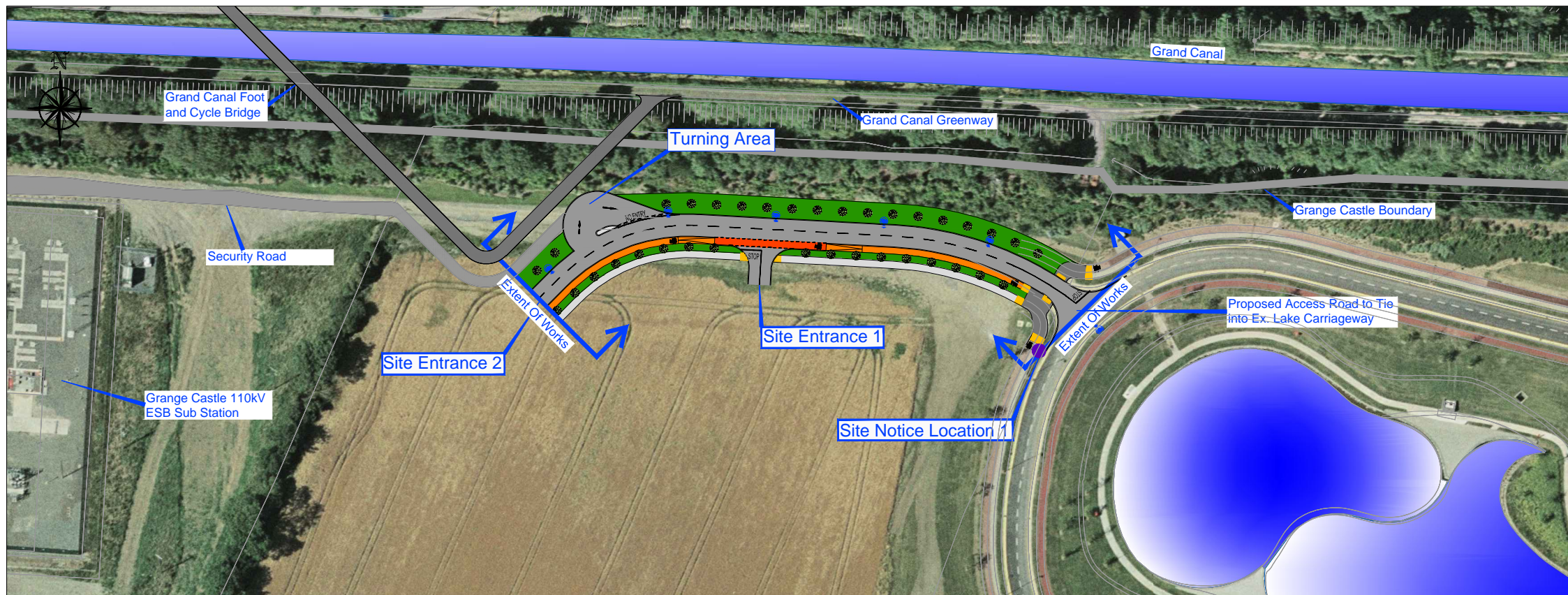

South Dublin County Council
COMHAIRLE CONTAE ÁTHA CLIATH THEAS
Planning and Development Act 2000 - 2011
Planning and Development Regulations, 2001-2013 - Part 8
Display of Proposed Development for Public Comment
PROPOSED GRANGE CASTLE BUSINESS PARK
SITE ACCESS ROAD

Pursuant to the requirements of the above, notice is hereby given of the proposal to construct a new access road in Grange Castle Business Park as detailed below:-

- Construction of 150m of 6.0m wide single carriageway road
- Construction of cycletracks, footpaths and verges
- Provision of drainage and associated features
- Provision of public lighting, road markings and signage
- Relocation of services where necessary
- Provision of other services and utilities where necessary
- Provision of landscaping finishes
- All associated site works as necessary to complete the scheme

Plans and particulars of the proposed development are available for inspection at:-
South Dublin County Council, County Hall, Tallaght, Dublin 24 - between the hours of 9:30am - 12:45pm and 2:00pm - 4:30pm Monday to Thursday and 9:00 am - 4:00 pm Friday
and
South Dublin County Council, Civic Offices, Clonsilla, Dublin 22 - between the hours of 9:30am - 12:45pm and 2:00pm - 4:30pm Monday to Thursday and 9:30 am - 4:00 pm Friday
From Friday 10th April, 2015 to Monday 25th May, 2015

Submissions and observations with respect to this matter, dealing with the proper planning and sustainable development of the area, in which the development would be situated, may be made in writing to:

The Senior Executive Officer,
Corporate Services
South Dublin County Council,
County Hall,
Tallaght,
Dublin 24.
Or by email to: info@grangecastle.ie
Closing date for receipt of submissions is up to and including 12.00 noon on Friday 15th May, 2015
It should be noted that the Freedom of Information Act, 1997-2006 applies to all records held by South Dublin County Council.
Web Site Address: www.southdublin.ie

Proposed Road Layout
Scale 1:500

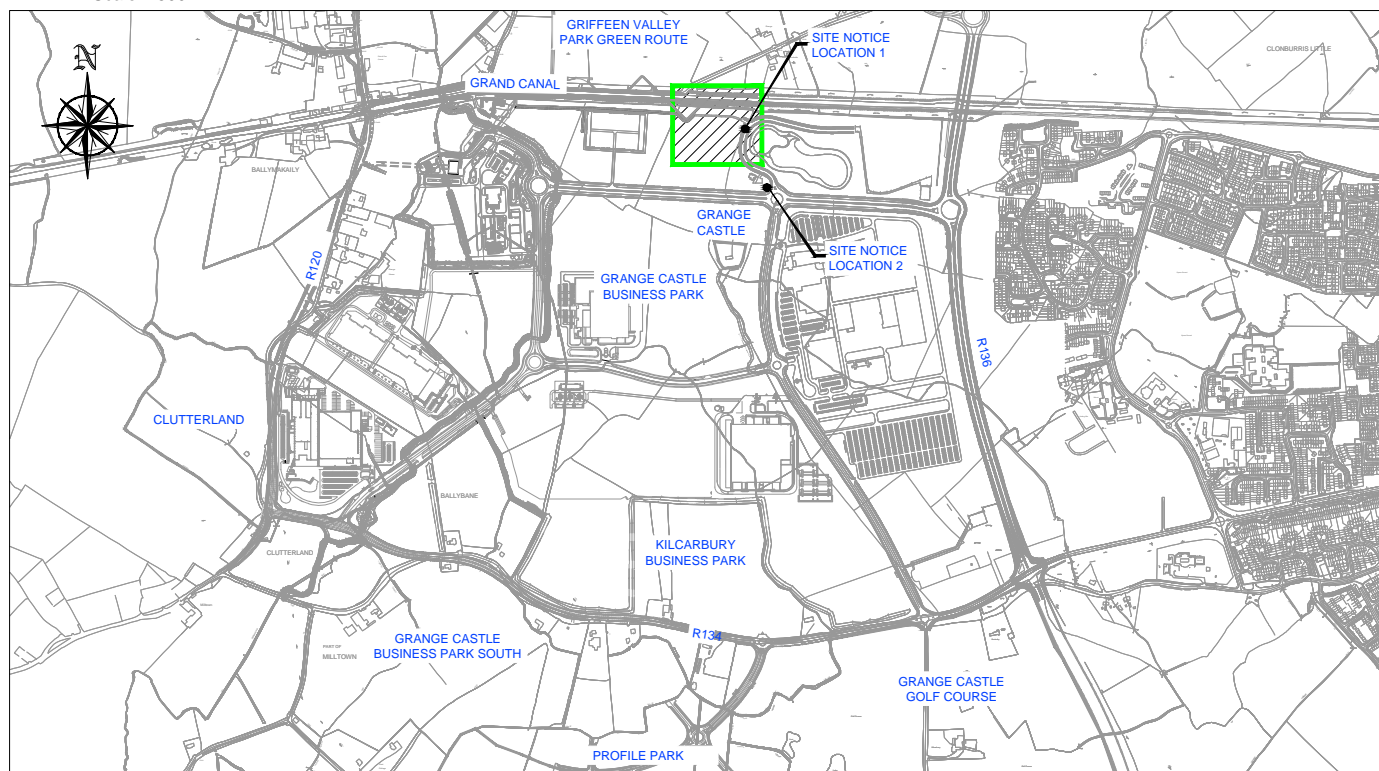

Key Plan
Scale NTS

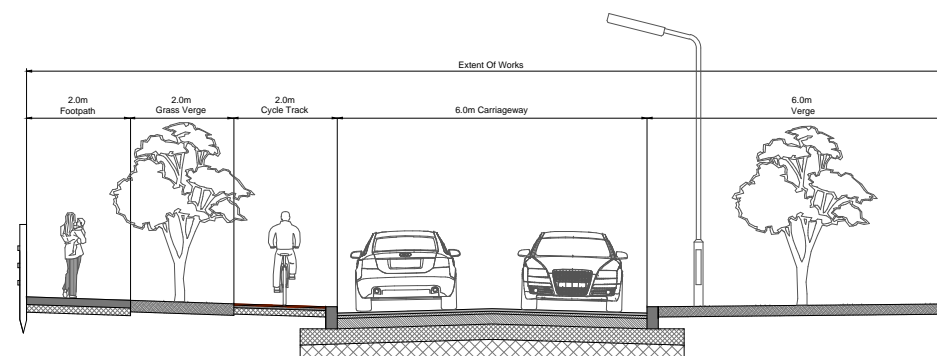

LEGEND:

PROPOSED CYCLE TRACK	
PROPOSED ON ROAD CYCLE LANE	
PROPOSED FOOTPATH	
PROPOSED CARRIAGEWAY	
PROPOSED SHARED SURFACE	
PROPOSED GRASS VERGE	
PROPOSED TREES	
PROPOSED PUBLIC LIGHTING POLE	

PUBLIC DISPLAY

SHEET 1 OF 1

Revision	Description	Initials	Date

Clifton Scannell Emerson
Associates
Client: SOUTH DUBLIN COUNTY COUNCIL
Project: GRANGE CASTLE BUSINESS PARK SITE ACCESS ROAD
Design Title: PROPOSED ACCESS ROAD
Drawn By: KT Date: MARCH 2015
Checked by: RG Scale: AS SHOWN @ A1
Disc. Progress: PLANNING
Disc. No.: 15_033_200