

Existing Elevation

(Scale 1:250)

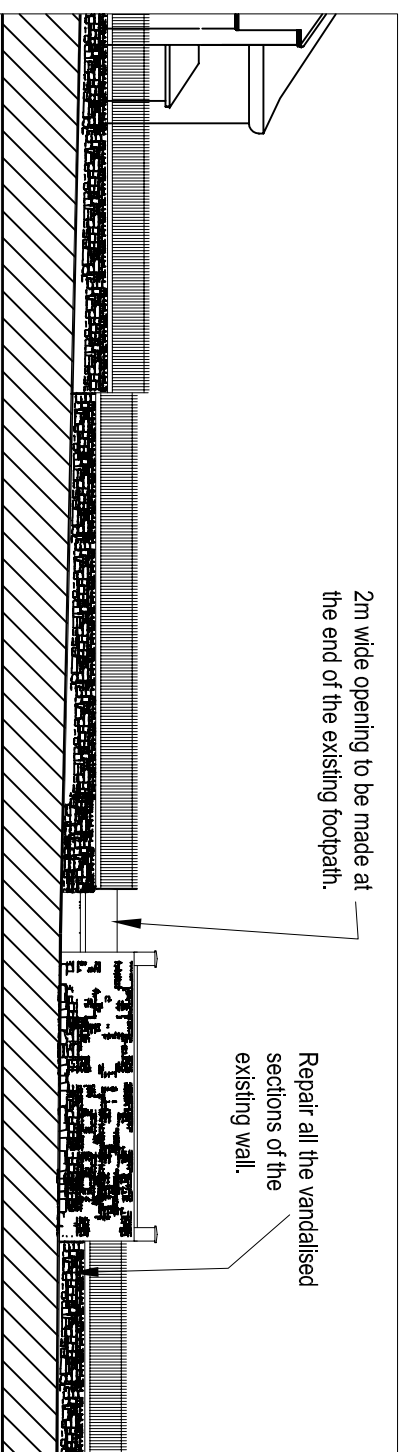

Proposed Elevation

(Scale 1:250)

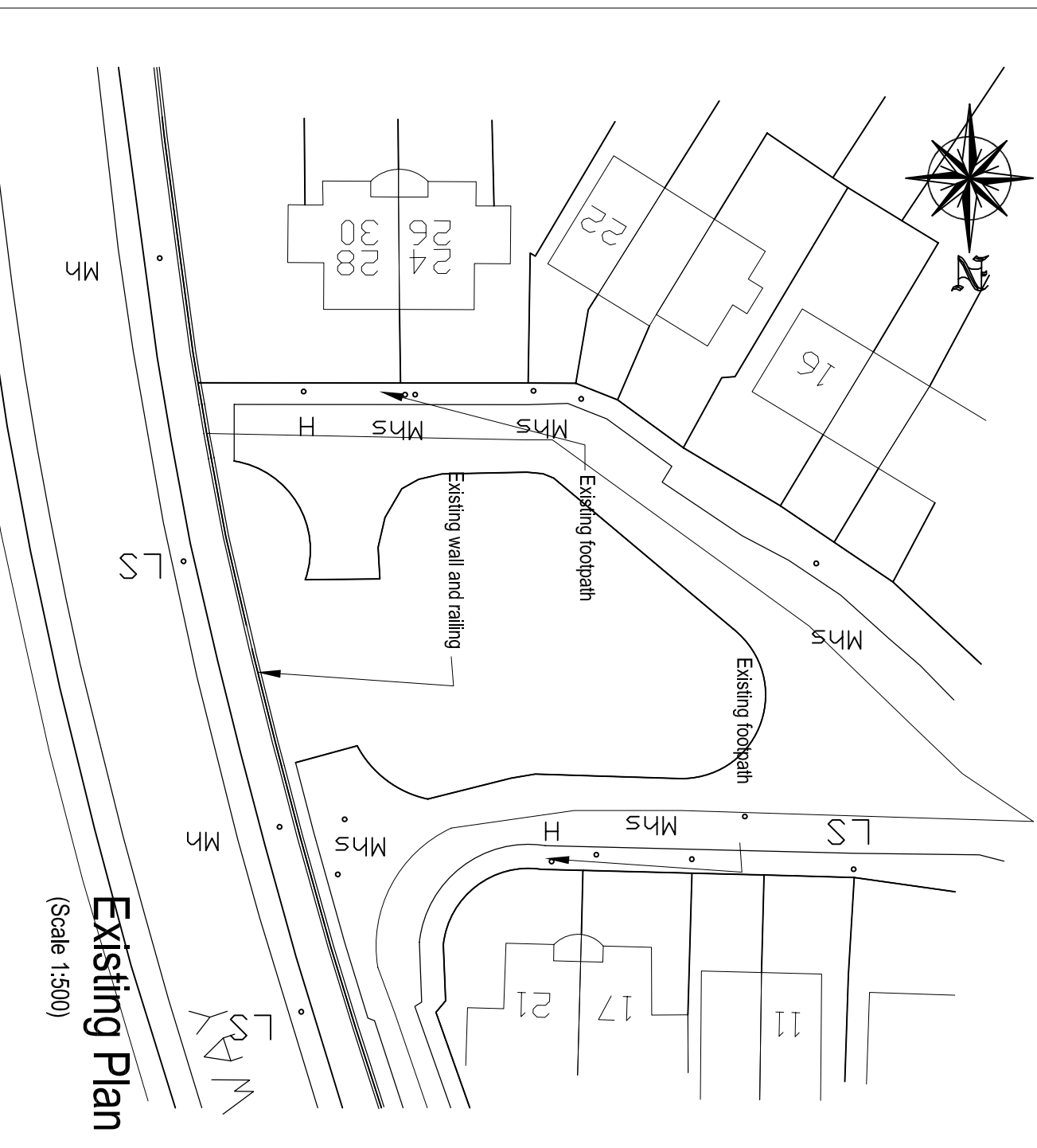

Existing Plan

(Scale 1:500)

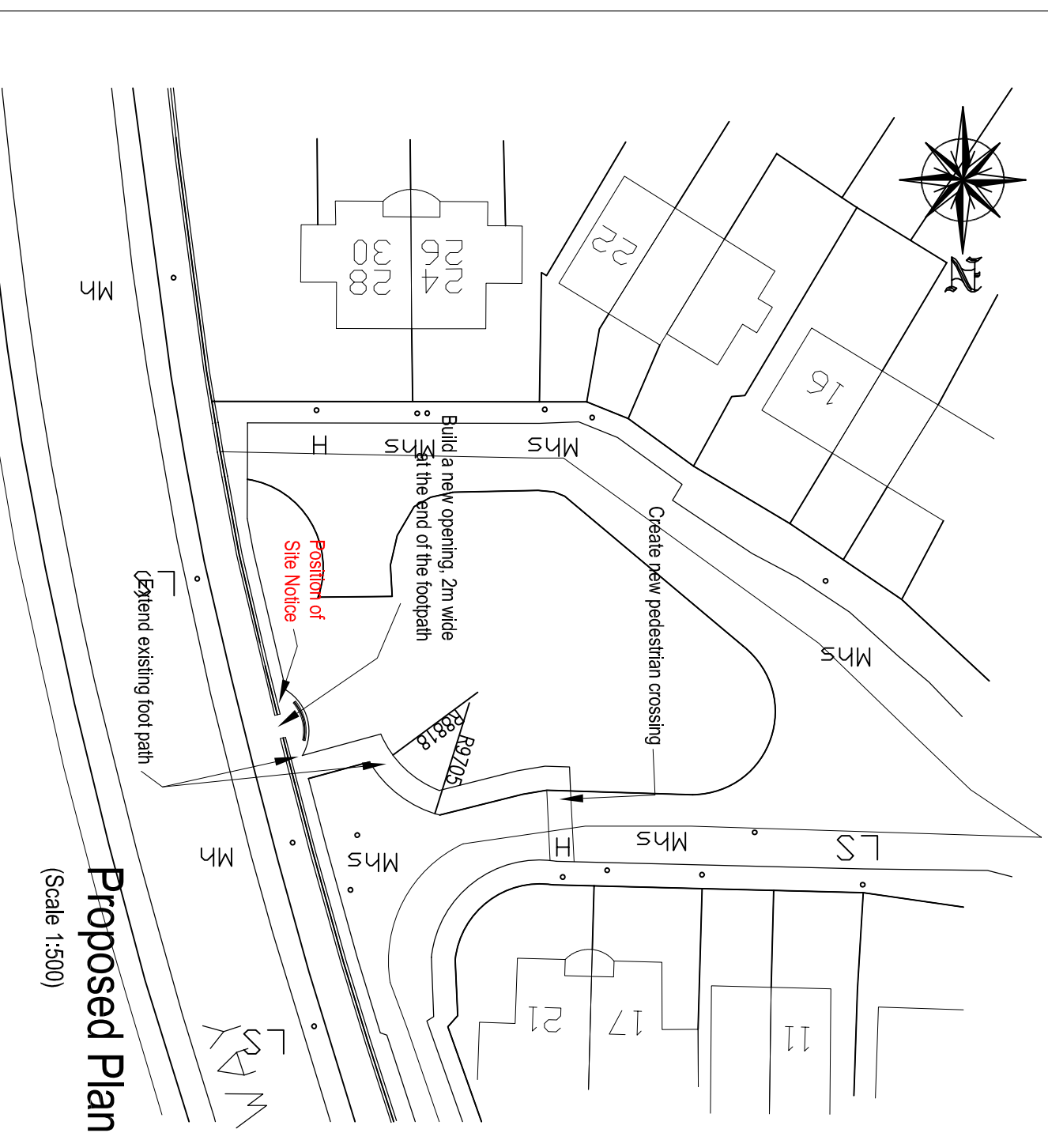

Proposed Plan

(Scale 1:500)

SOUTH DUBLIN COUNTY COUNCIL
 ARCHITECTS' DEPARTMENT
 COUNTY HALL, TALLAGHT
 DUBLIN 24. TEL:01-419500
 COUNTY ARCHITECT
 B. BRENNAN M.Sc. Arch., F.R.I.A.I.

PROJECT 3 New Openings to the Existing Stone Wall at Kiltipper Way
S.D. no. 000
TITLE Opening at 15-23 Cushlawn Drive

Date July 2005
Scale 1:500 & 1:250

PROJECT NO. 2005/0006/P8/003