

Existing Site Plan

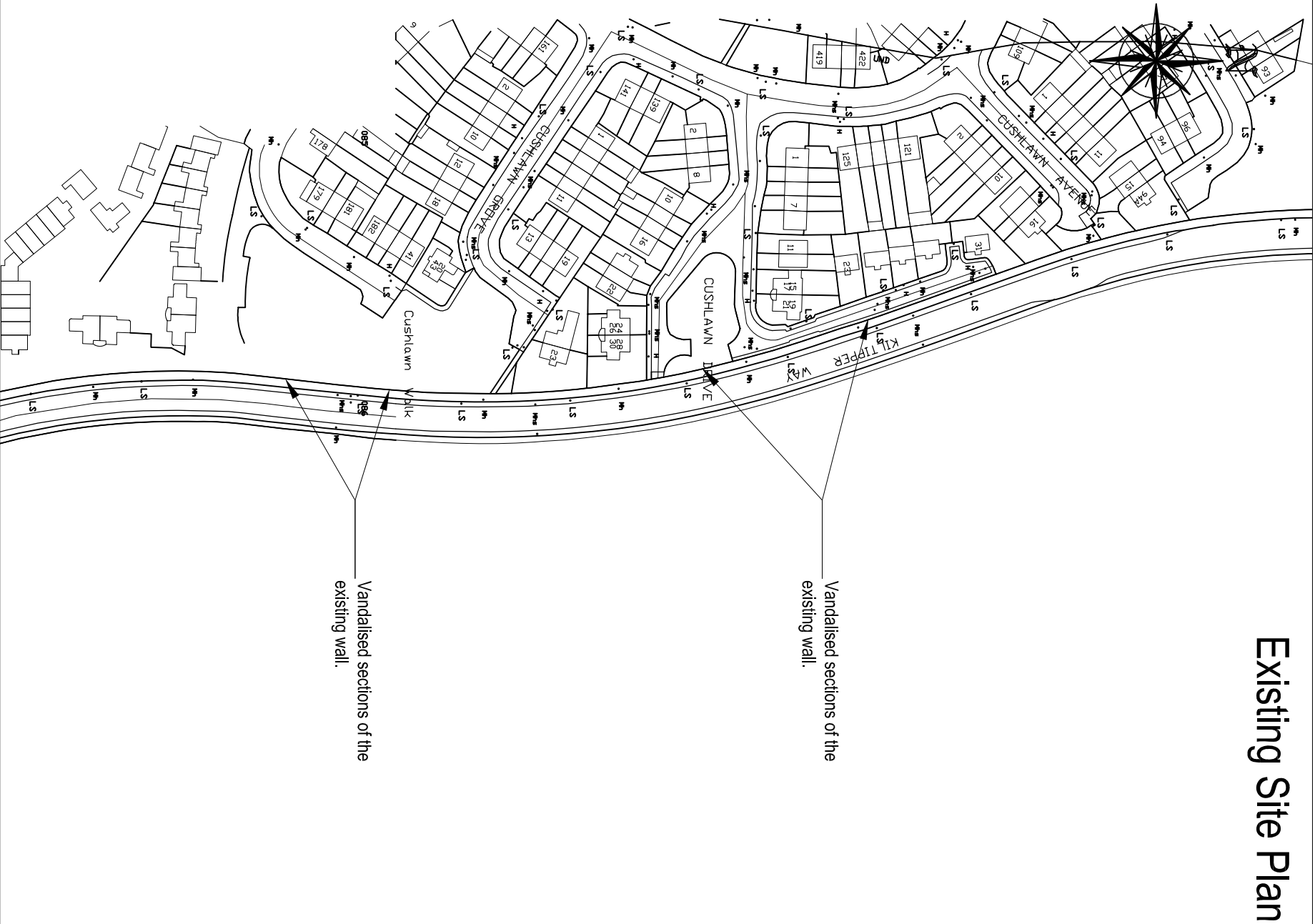

Proposed Site Plan

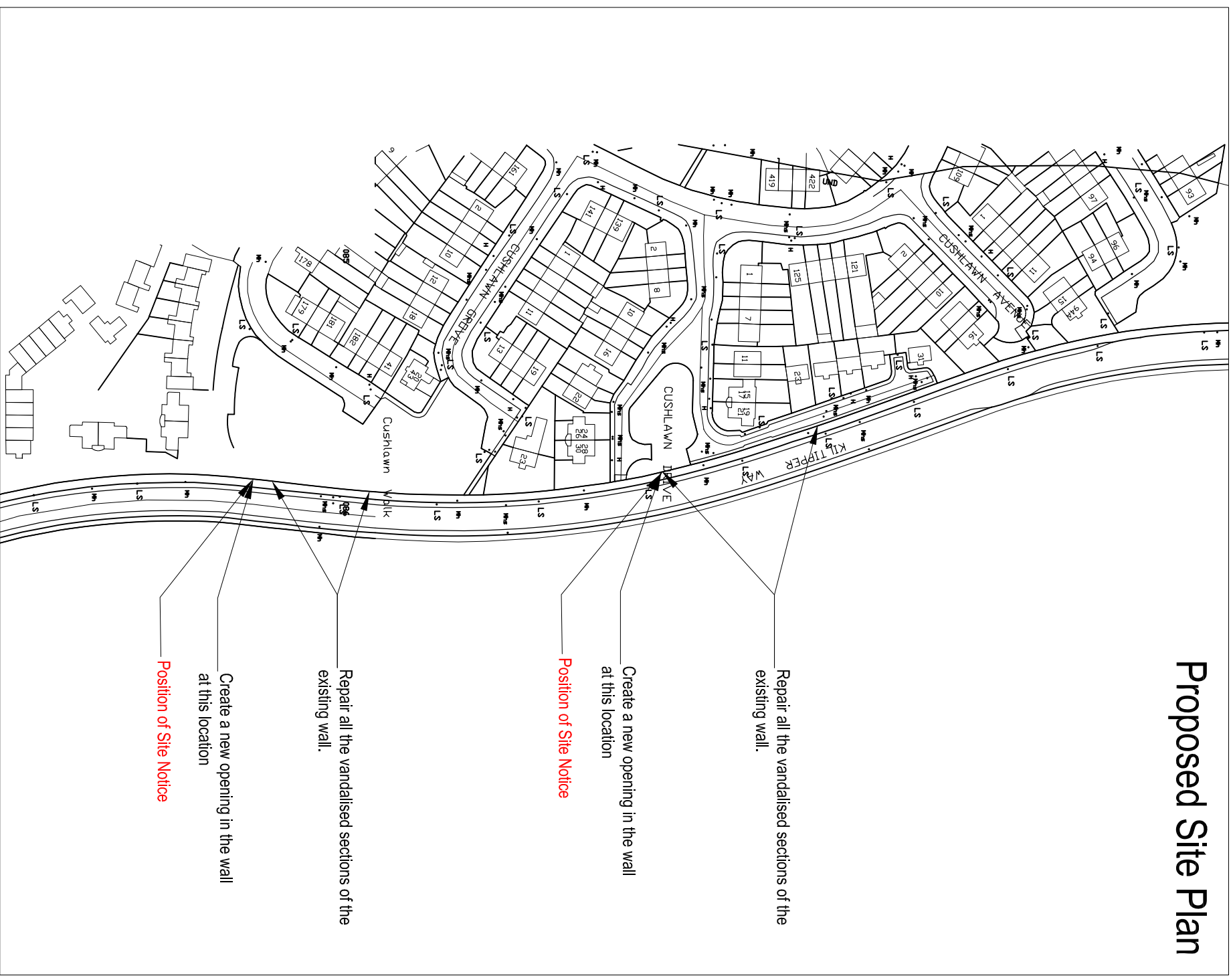

SOUTH DUBLIN COUNTY COUNCIL
 ARCHITECTS' DEPARTMENT
 County Hall, TALLAGHT,
 DUBLIN 24, TEL.01-4149000
 COUNTY ARCHITECT
 B. BRENNAN, M.Sc. Arch., F.R.I.A.I.

PROJECT 2 New Openings to the Existing Stone Wall at Kiltipper Way
TITLE Existing Site Plan and Proposed Site Plan

Date October 2005
Scale 1:2000

DRG. NO. 2005/0006/P8/001-rev01