

Includes Ordnance Survey Ireland data reproduced under OSI Licence number 2009/23/CCMA/SouthDublinCountyCouncil.
Unauthorised reproduction infringes Ordnance Survey Ireland and Government of Ireland copyright.
© Ordnance Survey Ireland, 2009.

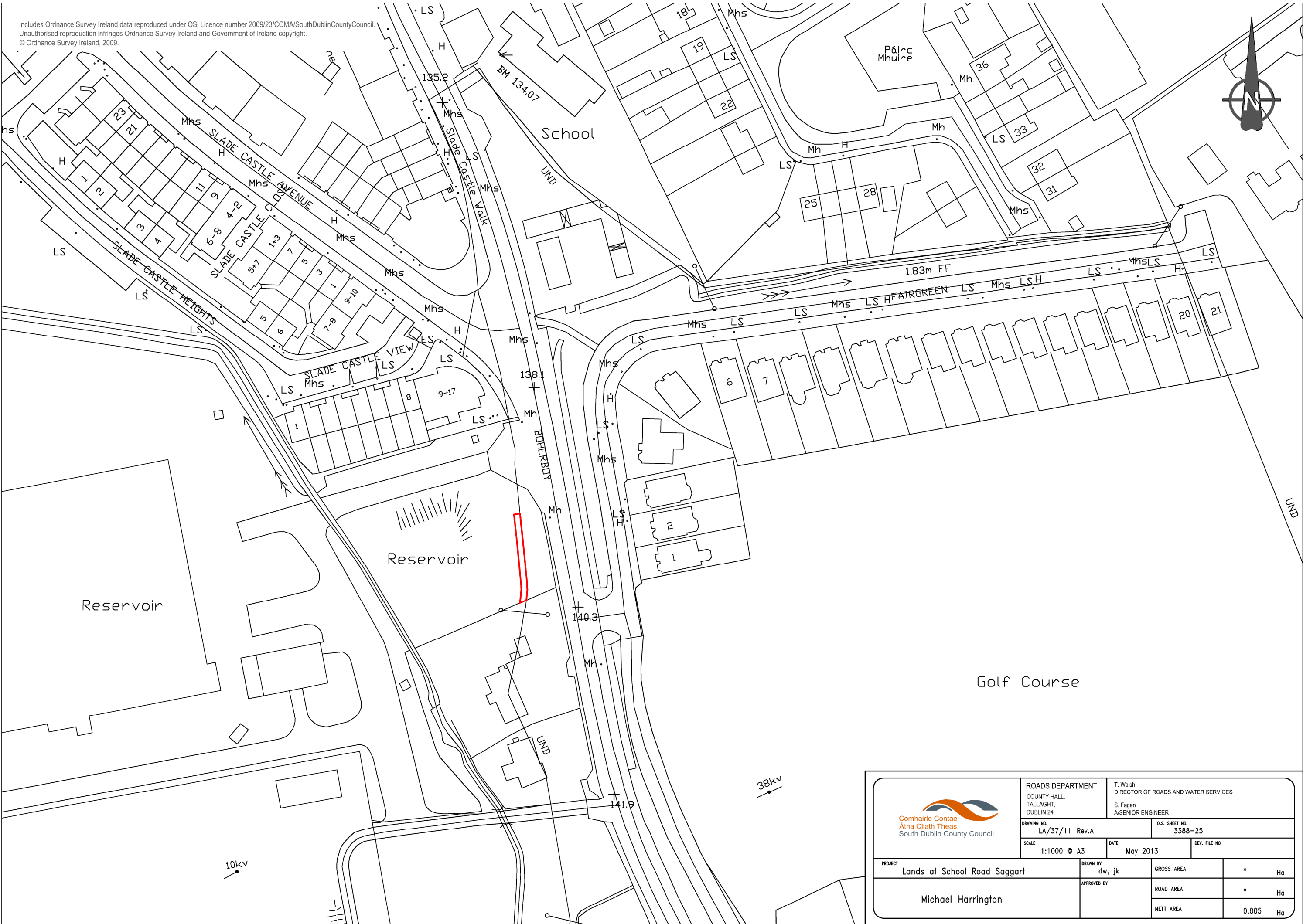
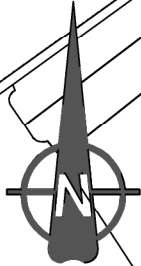

	ROADS DEPARTMENT		T. Walsh DIRECTOR OF ROADS AND WATER SERVICES		
	COUNTY HALL, TALLAGHT, DUBLIN 24.		S. Fagan A/SENIOR ENGINEER		
	DRAWING NO. LA/37/11 Rev.A		O.S. SHEET NO. 3388~25		
	SCALE 1:1000 @ A3		DATE May 2013		
PROJECT Lands at School Road Saggart		DRAWN BY dw, jk		GROSS AREA * Ha	
Michael Harrington		APPROVED BY		ROAD AREA * Ha	
				NETT AREA 0.005 Ha	