

X=301834.2509  
Y=227135.1404

X=303789.6768  
Y=227135.1404

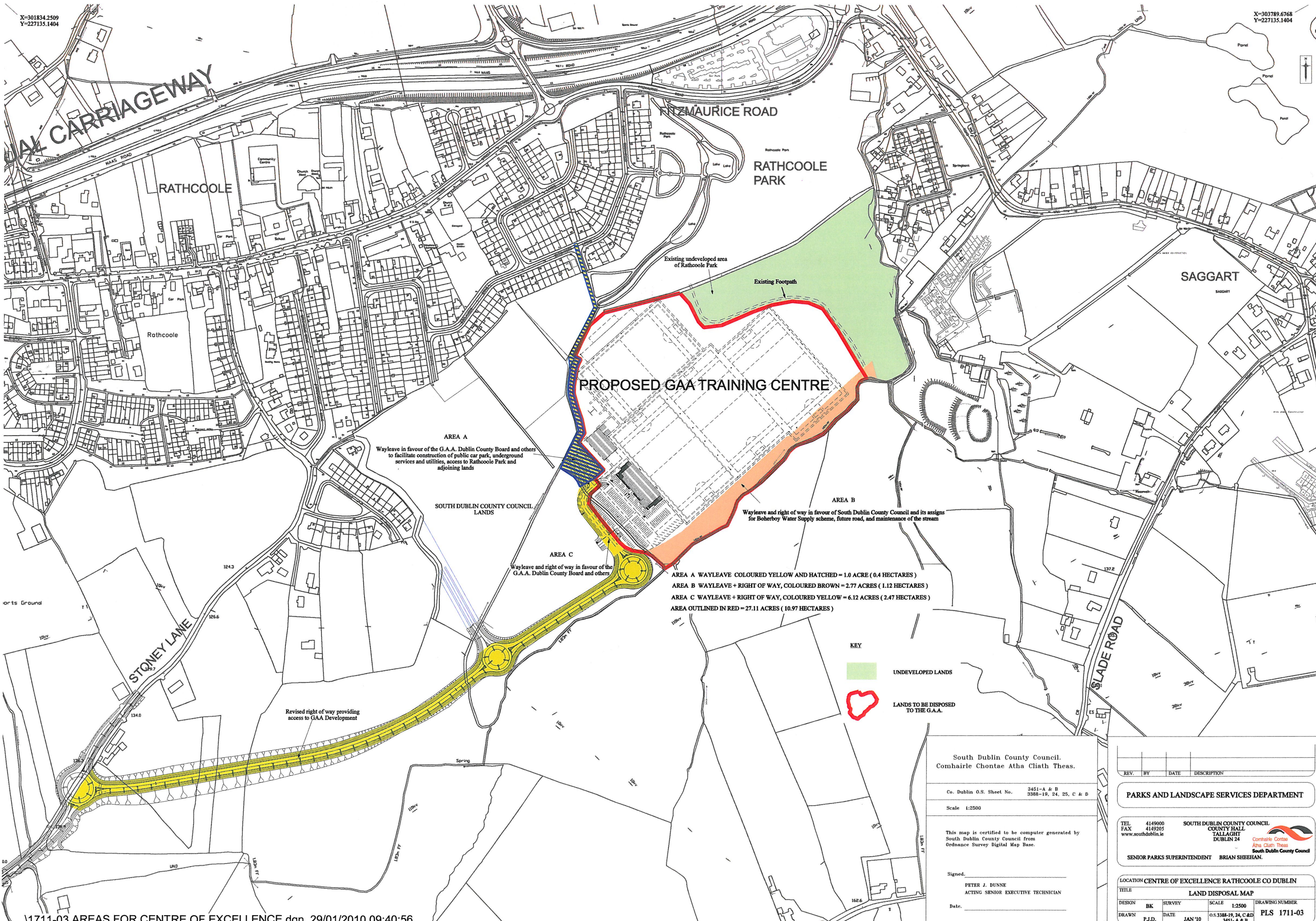

PROPOSED GAA TRAINING CENTRE

AREA A  
Wayleave in favour of the G.A.A. Dublin County Board and others  
to facilitate construction of public car park, underground  
services and utilities, access to Rathcoole Park and  
adjoining lands

SOUTH DUBLIN COUNTY COUNCIL  
LANDS

AREA C  
Wayleave and right of way in favour of the  
G.A.A. Dublin County Board and others

AREA B  
Wayleave and right of way in favour of South Dublin County Council and its assigns  
for Boherboy Water Supply scheme, future road, and maintenance of the stream

AREA A WAYLEAVE COLOURED YELLOW AND HATCHED = 1.0 ACRE (0.4 HECTARES)  
AREA B WAYLEAVE + RIGHT OF WAY, COLOURED BROWN = 2.77 ACRES (1.12 HECTARES)  
AREA C WAYLEAVE + RIGHT OF WAY, COLOURED YELLOW = 6.12 ACRES (2.47 HECTARES)  
AREA OUTLINED IN RED = 27.11 ACRES (10.97 HECTARES)

KEY



UNDEVELOPED LANDS



LANDS TO BE DISPOSED  
TO THE G.A.A.

South Dublin County Council.  
Comhairle Chontae Atha Cliath Theas.

Co. Dublin O.S. Sheet No. 3451-A & B  
3388-19, 24, 25, C & D

Scale 1:2500

This map is certified to be computer generated by  
South Dublin County Council from  
Ordnance Survey Digital Map Base.

Signed.

PETER J. DUNNE  
ACTING SENIOR EXECUTIVE TECHNICIAN

Date.

REV. BY DATE DESCRIPTION

PARKS AND LANDSCAPE SERVICES DEPARTMENT

TEL 4149000  
FAX 4149205  
www.southdublin.ie

SOUTH DUBLIN COUNTY COUNCIL  
COUNTY HALL  
TALLAGHT  
DUBLIN 24



SENIOR PARKS SUPERINTENDENT BRIAN SHEEHAN.

LOCATION CENTRE OF EXCELLENCE RATHCOOLE CO DUBLIN

TITLE LAND DISPOSAL MAP

DESIGN BK SURVEY SCALE 1:2500 DRAWING NUMBER  
DRAWN P.J.D. DATE JAN '10 O.S. 3388-19, 24, C & D  
3451-A & B PLS 1711-03