

CANAL BRIDGE - CANAL LEVEL OPENABLE BRIDGE

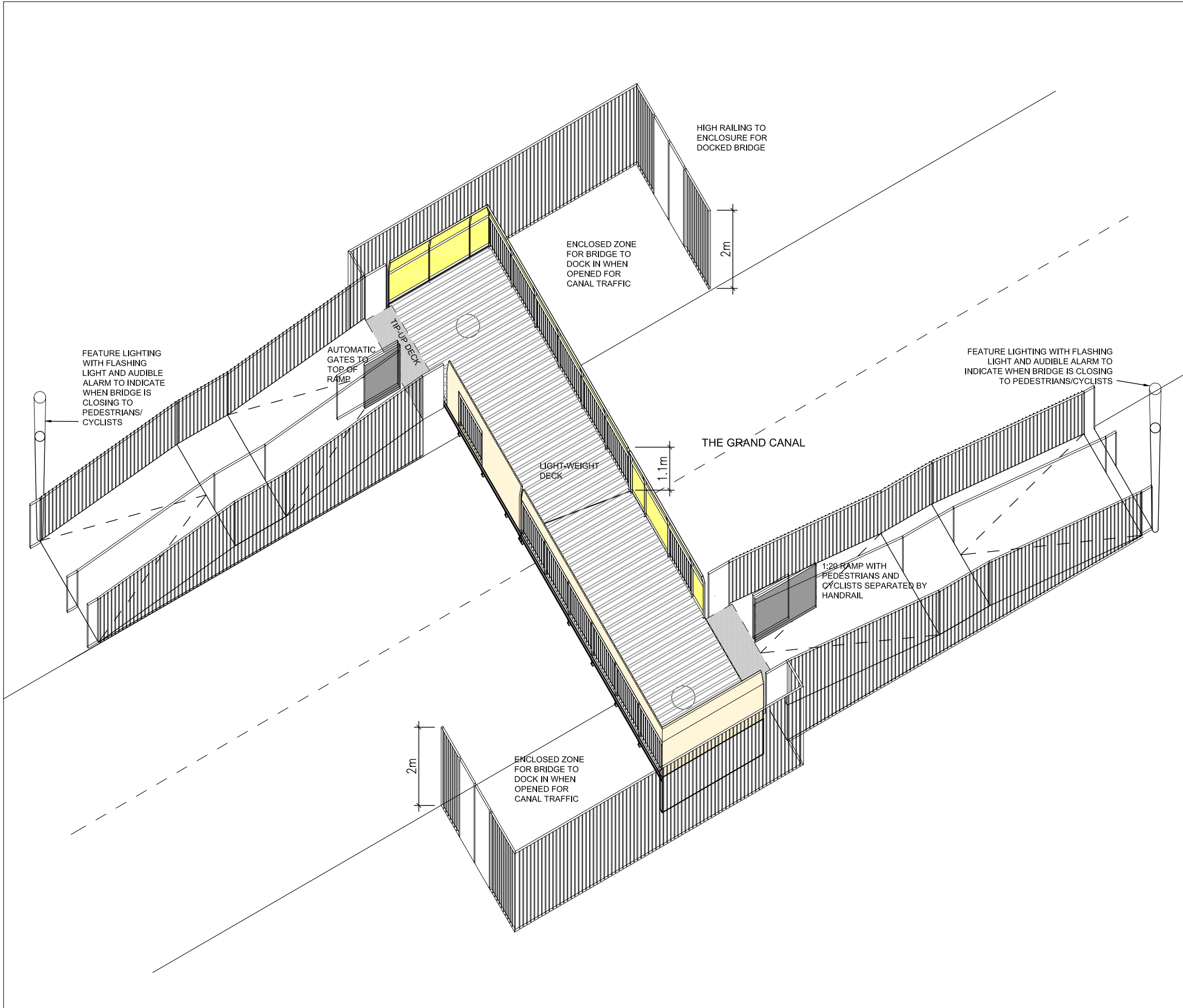

CANAL LEVEL
OPENABLE BRIDGE
ISOMETRIC @ 1 : 100

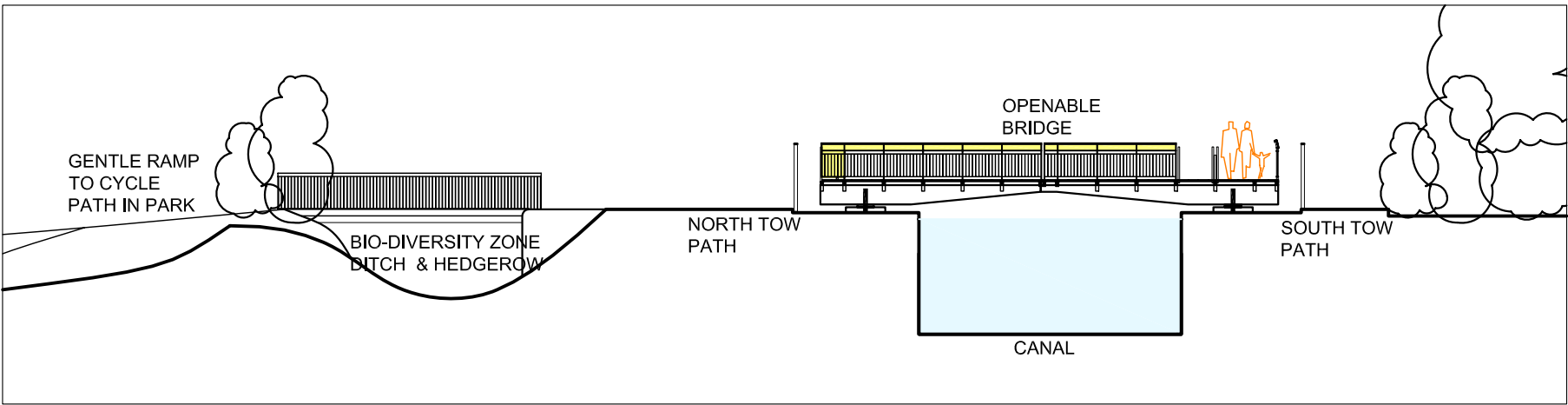

WEST SECTIONAL ELEVATION @ 1 : 200

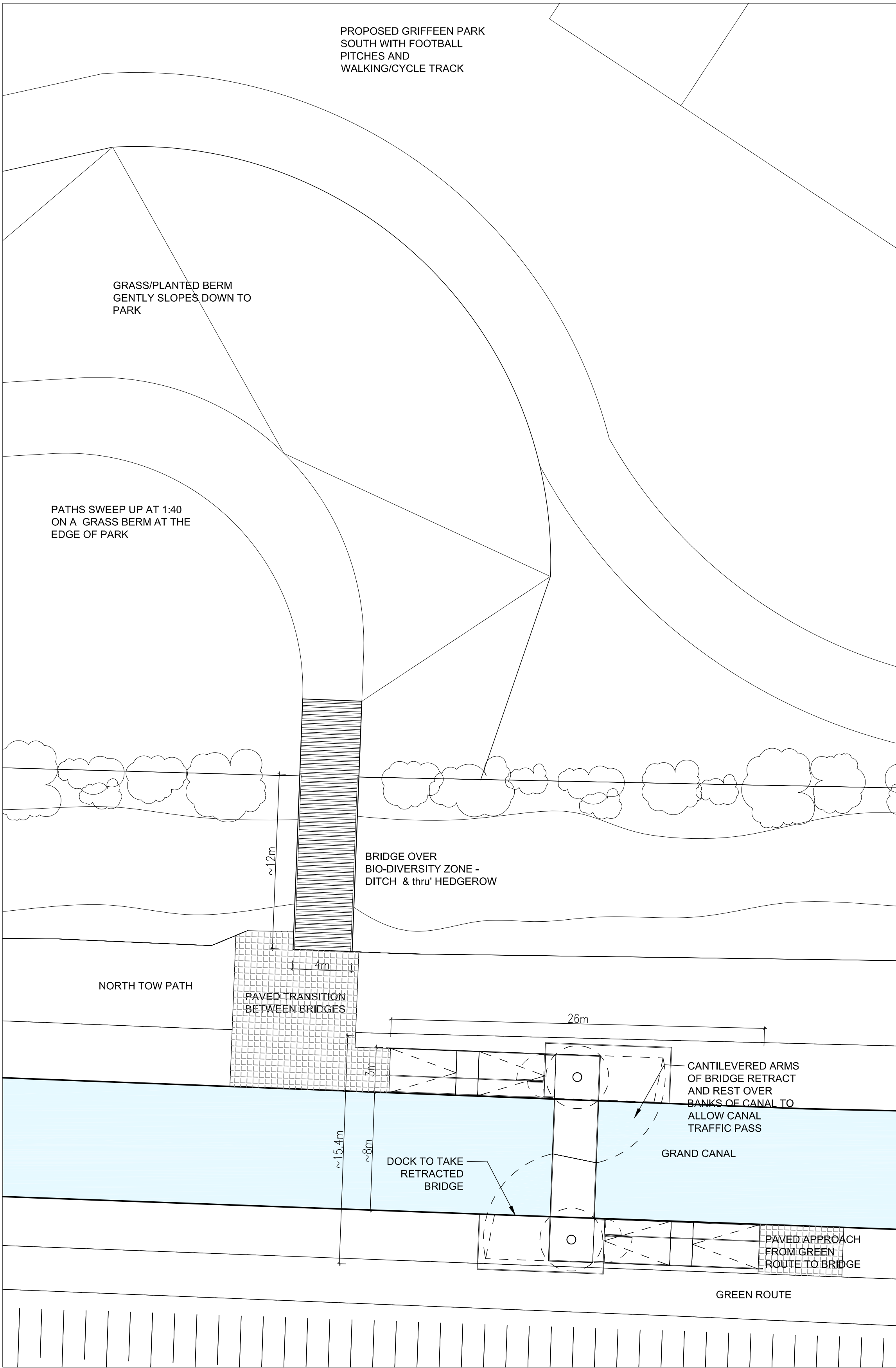

LEVEL OPENABLE
BRIDGE -
PLAN @ 1 : 200

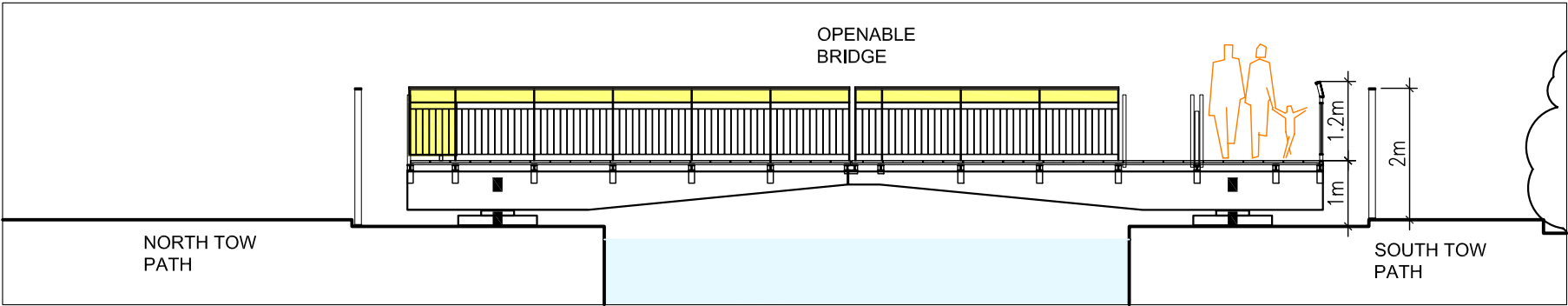

CANAL BRIDGE ELEVATION @ 1 : 100

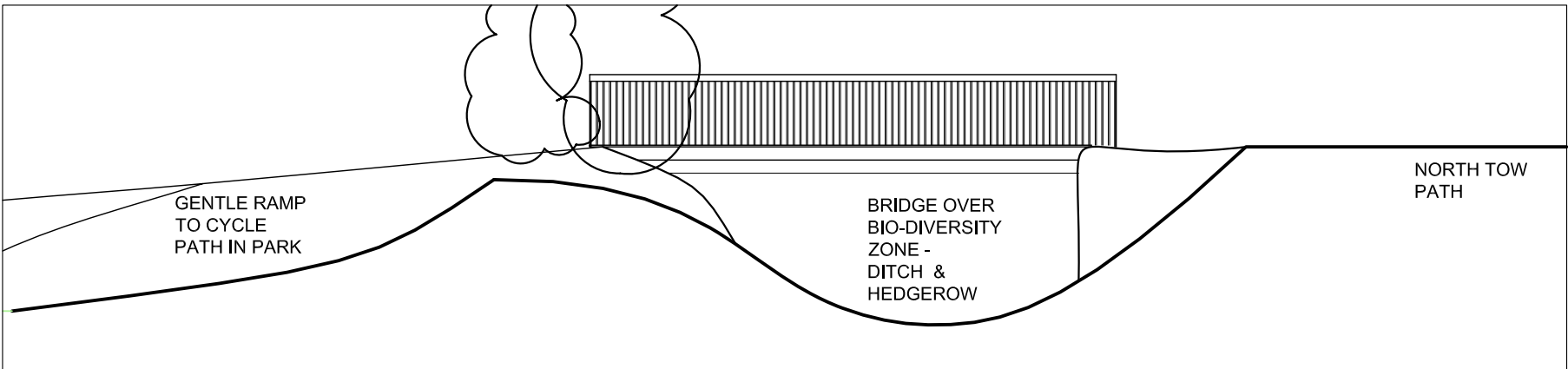

PARK BRIDGE ELEVATION @ 1 : 100

CANAL LEVEL OPENABLE BRIDGE
is an openable bridge with minimal ramping from the canal paths at both sides. The bridge is made up of two halves which both swing/pivot, over the banks into a docking position, when barges or boats need to navigate past. The bridge surface is raised only a high as the bridge structure necessitates. The illustrated bridge is shown at 900mm over the bank (max of 1m possible) so requiring 2 no. 9m long 1:20 ramps on each side. Cyclists and pedestrians are alerted to the bridge opening with lights and an audible alarm and a sliding gate prohibits access to the bridge deck.

PROJECT:
**GRAND CANAL
BRIDGE**

DRAWING:
**CANAL BRIDGE
SHEET 2 of 6
LEVEL OPENABLE
BRIDGE
PART 8**

**Comhairle Contae
Átha Cliath Theas
South Dublin County Council**
Architects' Department,
County Hall, Tallaght,
Dublin 24.
Tel: 01 414 9000
County Architect - Eddie Conroy
B. Arch., M. Arch.Sc., FRIBA.