

**TREE SURVEY
SCHEDULE OF EXISTING TREES**

Fig 1.0 Trees within or adjoining proposed development site

Tree Ref #	Species	Height (m)	Stem Diameter (mm)	Branch Spread (m)	Canopy Clearance Height (m)	Canopy Height (m)	Age Class	Physiological Condition	Structural Condition	Pest/Insect Management	ERC	CAK
146	Acacia	5	160	2.5	2	2	SM	Poor	Moderate	Numerous bleeding cankers on main stem, also bark damage at base. Tree likely to die within 5 years.	< 20	R
149	Spinaea scopulina (Spinaea scopulina subsp. hibernica)	4	270	North +2 West -3	1.5	1.5	SM	Moderate	Moderate	There is evidence of fungal rot in the stem. The tree has a distinct lean to the east.	< 20	CI
150	Prunus avium	6	350	North +4 South -4	2	2	M	Moderate	Poor	Unilateral crown die back (wooden) observed on south side. Some cankers observed on main stem.	< 20	CI
151	Prunus avium (Cory)	6	300	North +4 South -4	0	0	M	Moderate	Moderate	Unilateral crown die back (wooden) observed on south side. Some cankers observed on main stem.	> 20	R
152	Cornus verticillata	3	125	South +1.5 West -3	2	2	SM	Moderate	Poor	Unilateral crown die back (wooden) observed on south side. Some cankers observed on main stem.	< 20	R
153	Populus sp.	4	130	2	2	2	SM	Moderate	Poor	Unilateral crown die back (wooden) observed on south side. Some cankers observed on main stem.	< 20	R
154	Spinaea scopulina	5	150	2	2.5	2.5	SM	Moderate	Poor	Unilateral crown die back (wooden) observed on south side. Some cankers observed on main stem.	< 20	CI
155	Prunus avium (Cory)	5	180	2	2.5	2.5	SM	Moderate	Poor	Unilateral crown die back (wooden) observed on south side. Some cankers observed on main stem.	< 20	R
156	Prunus avium (Cory)	6	210	2	2	2	SM	Moderate	Poor	Unilateral crown die back (wooden) observed on south side. Some cankers observed on main stem.	< 20	R
157	Prunus sp.	5	190	2	2	2	1	Poor	Poor	Unilateral crown die back (wooden) observed on south side. Some cankers observed on main stem.	< 20	R
158	Cornus verticillata	6	180	2	1.8	1.8	1	Good	Moderate	Unilateral crown die back (wooden) observed on south side. Some cankers observed on main stem.	< 20	CI
159	Populus sp.	5	70	1.5	1.5	1.5	1	Moderate	Moderate	Unilateral crown die back (wooden) observed on south side. Some cankers observed on main stem.	> 20	CI
160	Cornus verticillata	4	110	2	2	2	1	Good	Moderate	Unilateral crown die back (wooden) observed on south side. Some cankers observed on main stem.	> 20	CI

Fig 1.1 Trees within Saggart Village Green

Tree Ref #	Species	Height (m)	Stem Diameter (mm)	Branch Spread (m)	Canopy Clearance Height (m)	Canopy Height (m)	Age Class	Physiological Condition	Structural Condition	Pest/Insect Management	ERC	CAK
161	Thuja sp. (Leylandii)	6	208	2.5	2	2	SM	Good	Good	Gliding root at base, evidence of fungal rot at base. Some damage observed on lower stem and around base appears to be caused by fungal rot.	> 20	BI
162	Spinaea scopulina (Spinaea scopulina subsp. hibernica)	7	205	2.5	2.5	2.5	SM	Good	Good	There is good condition. Some damage observed on lower stem and around base appears to be caused by fungal rot.	> 20	BI
163	Spinaea scopulina (Spinaea scopulina subsp. hibernica)	7.2	380	North +3.5 South +1 West -2	2	2	SM	Good	Moderate	There is good condition. Some damage observed on lower stem and around base appears to be caused by fungal rot.	> 20	CI
164	Spinaea scopulina (Spinaea scopulina subsp. hibernica)	4	138	South +2 West -3	1.75	1.75	SM	Good	Moderate	There is good condition. Some damage observed on lower stem and around base appears to be caused by fungal rot.	> 20	BI
165	Hypericum (Hypericum)	7.2	320 @ 1.5m	North +4.5 South +4.5 West -4.5	2	2	M	Good	Moderate	Unilateral crown die back (wooden) observed on south side. Some cankers observed on main stem.	> 20	BI
166	Hypericum (Hypericum)	6	158	2	2.5	2.5	SM	Good	Moderate	Unilateral crown die back (wooden) observed on south side. Some cankers observed on main stem.	< 20	CI
167	Populus sp. (Populus)	14.0	425	North +4 West -4	3	3	M	Moderate	Moderate	Unilateral crown die back (wooden) observed on south side. Some cankers observed on main stem.	< 20	CI
168	Spinaea scopulina (Spinaea scopulina subsp. hibernica)	6	121	West -4	1.4	1.4	SM	Poor	Poor	Unilateral crown die back (wooden) observed on south side. Some cankers observed on main stem.	< 20	R
169	Spinaea scopulina (Spinaea scopulina subsp. hibernica)	9	385	4	2	2	M	Moderate	Moderate	Unilateral crown die back (wooden) observed on south side. Some cankers observed on main stem.	< 20	BI
170	Acacia (Acacia)	8.2	395	North +4.2 South +4.2 West -2	2.8	2.8	M	Good	Moderate	Unilateral crown die back (wooden) observed on south side. Some cankers observed on main stem.	< 20	CI
171	Thuja sp. (Leylandii)	6	135	2	2	2	SM	Good	Moderate	Unilateral crown die back (wooden) observed on south side. Some cankers observed on main stem.	< 20	CI
172	Thuja sp. (Leylandii)	6	158 @ 1.1m	2.5	1.4	1.4	SM	Good	Moderate	Unilateral crown die back (wooden) observed on south side. Some cankers observed on main stem.	< 20	CI
173	Prunus sp.	7	216 @ 0.5m	South +1.5 West -1.5	1.1	1.1	SM	Good	Moderate	Unilateral crown die back (wooden) observed on south side. Some cankers observed on main stem.	< 20	CI

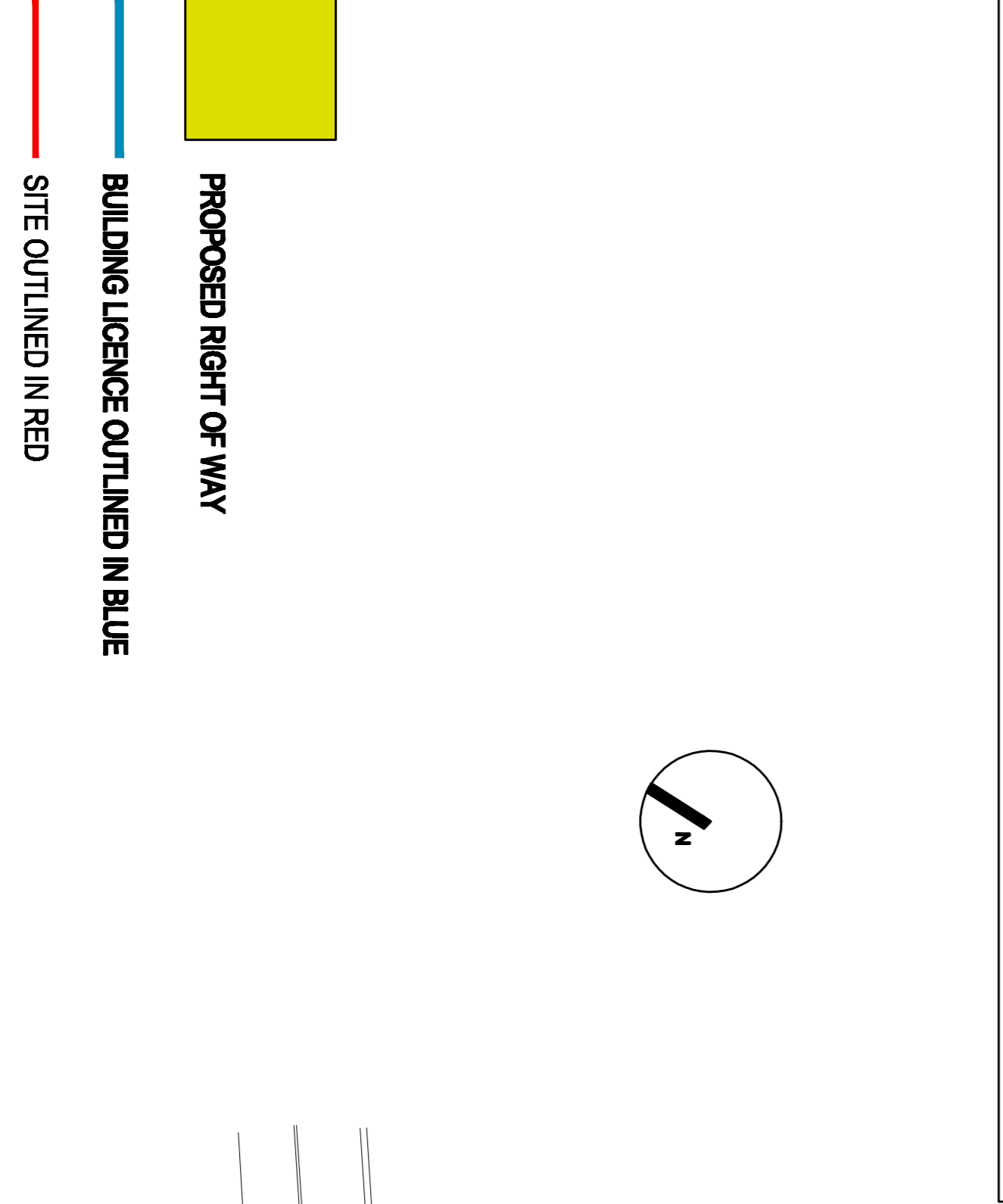

NOTES:

JOB NO: 01-05
DRAWING: EXISTING LAYOUT & PROPOSED RIGHT OF WAY
DATE: AUGUST 2008
CLIENT: DES NOLAN & SHAY MURPHY

DRG. NO: PR-04
SCALE: 1/200
SITE: SAGGART VILLAGE CO. DUBLIN

17 BRIGHTON SQUARE, RATHGAR, DUBLIN 6. TEL. 4902446

CHK STA DATE	REV	CHK STA DATE	REV