

**TREE SURVEY
SCHEDULE OF EXISTING TREES**

Fig 1.0 Trees within or adjoining proposed development site

Tree Ref #	Species	Height (m)	Stem Diameter (mm)	Branch Spread (m)	Clearance Height (m)	Canopy Height (m)	Age Class	Physiological Condition	Structural Condition	Pruning/Management Recommendations	EMC	CAK
146	Azalea	5	160	2.3	2	2	SM	Poor	Moderate	Numerous bleeding cankers on main stem, also bark damage at base. Tree likely to die within 10 years.	< 20	R
149	Spirea japonica	4	270	North +2 West -3	1.3		SM	Moderate	Moderate	There is evidence of growing roots in walk area. This tree has a distinct lean to the east.	< 20	CI
150	Prunus sibirica	6	350	North +4 West -2	2		M	Moderate	Poor	Unilateral crown die back (windburn) observed on south side. Some cankers observed on main stem.	< 20	CI
151	Prunus sibirica	6	350	North +4 West -2	2		M	Moderate	Moderate	Unilateral crown die back (windburn) observed on south side. Some cankers observed on main stem.	< 20	R
152	Prunus sibirica	6	350	North +4 West -2	2		M	Moderate	Moderate	Unilateral crown die back (windburn) observed on south side. Some cankers observed on main stem.	< 20	R
153	Prunus sibirica	6	350	North +4 West -2	2		M	Moderate	Moderate	Unilateral crown die back (windburn) observed on south side. Some cankers observed on main stem.	< 20	R
154	Prunus sibirica	6	350	North +4 West -2	2		M	Moderate	Moderate	Unilateral crown die back (windburn) observed on south side. Some cankers observed on main stem.	< 20	R
155	Prunus sibirica	6	350	North +4 West -2	2		M	Moderate	Moderate	Unilateral crown die back (windburn) observed on south side. Some cankers observed on main stem.	< 20	R
156	Prunus sibirica	6	350	North +4 West -2	2		M	Moderate	Moderate	Unilateral crown die back (windburn) observed on south side. Some cankers observed on main stem.	< 20	R
157	Prunus sibirica	6	350	North +4 West -2	2		M	Moderate	Moderate	Unilateral crown die back (windburn) observed on south side. Some cankers observed on main stem.	< 20	R
158	Prunus sibirica	6	350	North +4 West -2	2		M	Moderate	Moderate	Unilateral crown die back (windburn) observed on south side. Some cankers observed on main stem.	< 20	R
159	Prunus sibirica	6	350	North +4 West -2	2		M	Moderate	Moderate	Unilateral crown die back (windburn) observed on south side. Some cankers observed on main stem.	< 20	R
160	Prunus sibirica	6	350	North +4 West -2	2		M	Moderate	Moderate	Unilateral crown die back (windburn) observed on south side. Some cankers observed on main stem.	< 20	R

Fig 1.1 Trees within Saggart Village Green

Tree Ref #	Species	Height (m)	Stem Diameter (mm)	Branch Spread (m)	Clearance Height (m)	Canopy Height (m)	Age Class	Physiological Condition	Structural Condition	Pruning/Management Recommendations	EMC	CAK
161	Thuja sp.	6	208	2.5	2	2	SM	Good	Good	Gliding root at base, evidence of some minor bark damage elsewhere.	> 20	BI
162	Spirea japonica	7	205	2.5	2.5	2.5	SM	Good	Good	There is good condition. Bark damage on lower stem and around base appears to be due to mechanical damage.	> 20	BI
163	Spirea japonica	7.2	380	North +3.5 South +1 West -2	2	2	SM	Good	Moderate	There is evidence of growing roots in walk area. This tree has a distinct lean to the east. Some bark damage at base, add other growth that break at the top. Change to bark on main stem at 1.5m where there is a hole in bark.	> 20	CI
164	Spirea japonica	4	138	South +2 West -2	1.75	1.75	SM	Good	Moderate	There is a hole in bark at 1.5m where there is a hole in bark. Change to bark on main stem at 1.5m where there is a hole in bark.	> 20	BI
165	Spirea japonica	7.2	320 @ 1.5m	North +4.5 South +4.5 West -4.5	2	2	M	Good	Moderate	Unilateral crown die back (windburn) observed on south side. Some cankers observed on main stem.	> 20	BI
166	Spirea japonica	6	188	2	2.5	2.5	SM	Good	Moderate	Unilateral crown die back (windburn) observed on south side. Some cankers observed on main stem.	> 20	CI
167	Populus sp.	14.0	425	North +4 West -4	3		M	Moderate	Moderate	Unilateral crown die back (windburn) observed on south side. Some cankers observed on main stem.	< 20	CI
168	Spirea japonica	6	121	1.8	1.4	1.4	SM	Poor	Poor	Numerous small cankers on secondary stems up to 1.5m. Some wounds on main stem where they should be sealed by removal of dead wood.	< 10	R
169	Spirea japonica	9	385	4	2	2	M	Moderate	Moderate	Numerous small cankers on secondary stems up to 1.5m. Some wounds on main stem where they should be sealed by removal of dead wood.	< 10	BI
170	Spirea japonica	8.2	395	North +4.2 South +4.2 West -2	2.8	2.8	M	Good	Moderate	Numerous small cankers on secondary stems up to 1.5m. Some wounds on main stem where they should be sealed by removal of dead wood.	< 10	CI
171	Thuja sp.	6	135	2	2	2	SM	Good	Moderate	Unilateral crown die back (windburn) observed on south side. Some cankers observed on main stem.	< 20	CI
172	Thuja sp.	6	188 @ 1.1m	2.3	1.4	1.4	SM	Good	Moderate	Unilateral crown die back (windburn) observed on south side. Some cankers observed on main stem.	< 20	CI
173	Prunus sp.	7	216 @ 55cm	South +1.1 West -1.1	1.1	1.1	SM	Good	Moderate	Unilateral crown die back (windburn) observed on south side. Some cankers observed on main stem.	< 20	CI

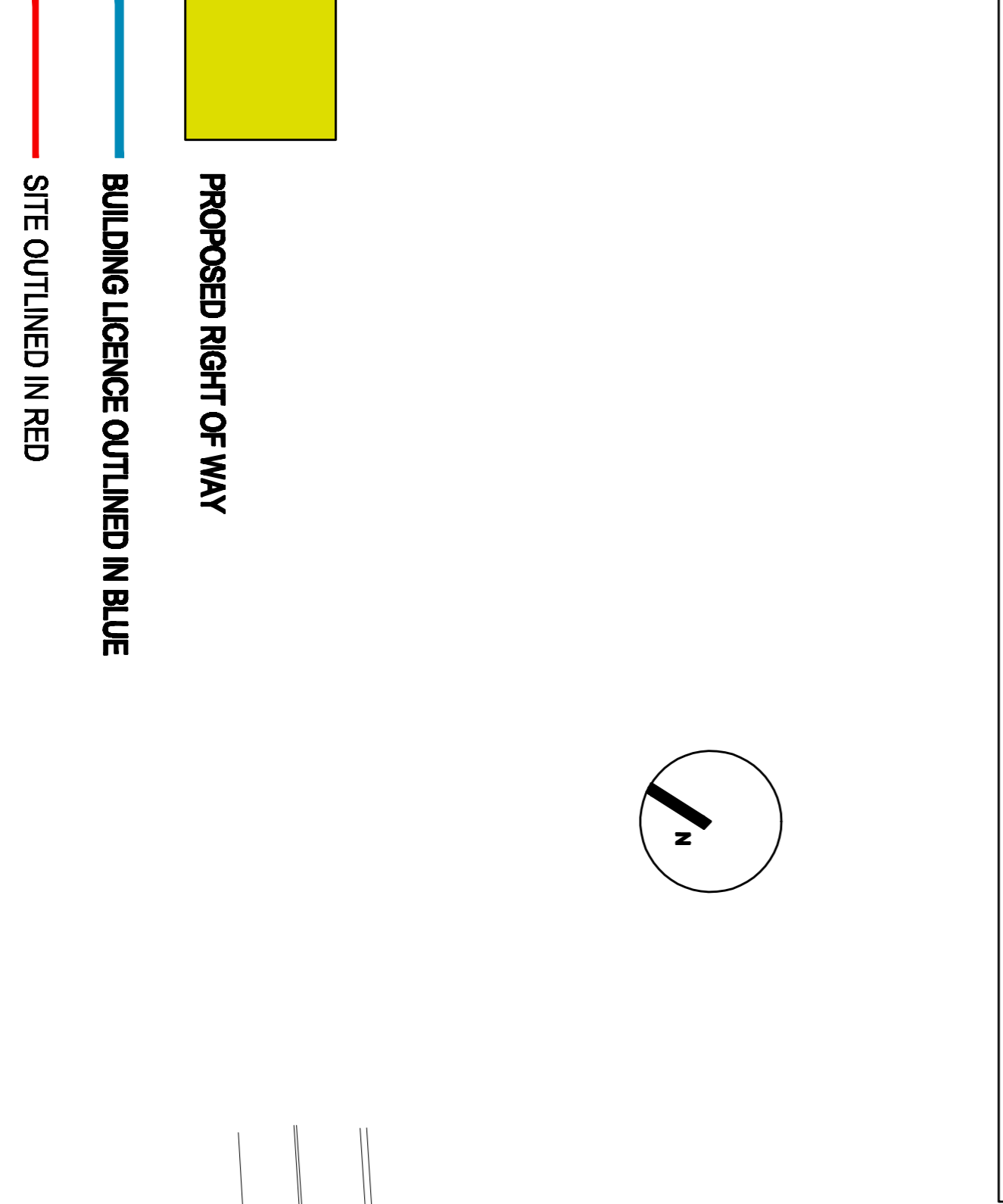

NOTES:

PROPOSED RIGHT OF WAY

BUILDING LICENCE OUTLINED IN BLUE

SITE OUTLINED IN RED

17 BRIGHTON SQUARE, RATHGAR, DUBLIN 6, TEL. 4902446

DOWNEY - MAC CONVILLE ARCHITECTS

JOB NO: 01-05

DRAWING: EXISTING LAYOUT & PROPOSED RIGHT OF WAY

DATE: AUGUST 2008

CLIENT: DES NOLAN & SHAY MURPHY

SCALE: 1/200

SITE: SAGGART VILLAGE CO DUBLIN

DRG. NO: PR.04

REVISION: