

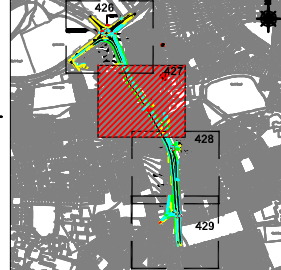

COMHAIRLE CHONTAE ATHA CLIATH THEAS
SOUTH DUBLIN COUNTY COUNCIL



KEY PLAN LAYOUT

GENERAL NOTES:
 ALL LEVELS TO MALIN HEAD O.S. DATUM.
 THIS DRAWING IS PRODUCED TO MATCH THE O.S. NATIONAL GRID. (NOT IRENET NATIONAL GRID)
 THIS DRAWING IS FOR INFORMATION ONLY, WHILE EVERY EFFORT HAS BEEN MADE TO ENSURE THAT THE ITEMS/SERVICES SHOWN ARE IN THE POSITIONS INDICATED ON THIS DRAWING, NO RESPONSIBILITY CAN BE TAKEN FOR DAMAGE OR INJURY CAUSED WHILE WORKING AT OR NEAR THE ITEMS/SERVICES.
 WORK SHOULD PROCEED WITH EXTREME CARE AT ALL TIMES.
 THIS DRAWING IS BELIEVED TO BE UP TO DATE AT THE TIME OF PRODUCTION. FURTHER SERVICES MAY HAVE BEEN ADDED SUBSEQUENT TO ISSUING OF DRAWINGS.
 USERS SHOULD OPERATE ON THE BASIS THAT SERVICES MAY HAVE BEEN ADDED WITHOUT RECORD.
 MAIN CONTRACTORS MUST CONFIRM LOCATION OF ALL EXISTING SERVICES WITH ALL UTILITY COMPANIES PRIOR TO EXCAVATION IN ANY LOCATION.

	Drawing Status
	FOR INFORMATION ONLY
	Issue By: CSEA

Revision	Description	Date

CLIFTON SCANNELL EMERSON ASSOCIATES
 Consulting Engineers
 20001 Leixlip, Clonsilla Park, Leixlip, Co. Dubh, Ireland.
 Tel. +353 01 289 9000 Fax. +353 01 289 9000 Email. info@csea.ie

Architect	SOUTH DUBLIN COUNTY COUNCIL		
Client	SOUTH DUBLIN COUNTY COUNCIL		
Project	PROPOSED KNOCKLYON ROAD		
Doc. Title	PROPOSED WALL LAYOUT SHEET 2 OF 4		
Drawn By	DMcE	Date	-
Checked by	IL / RG	Scale	1:500
Doc. No.	05_132_427		

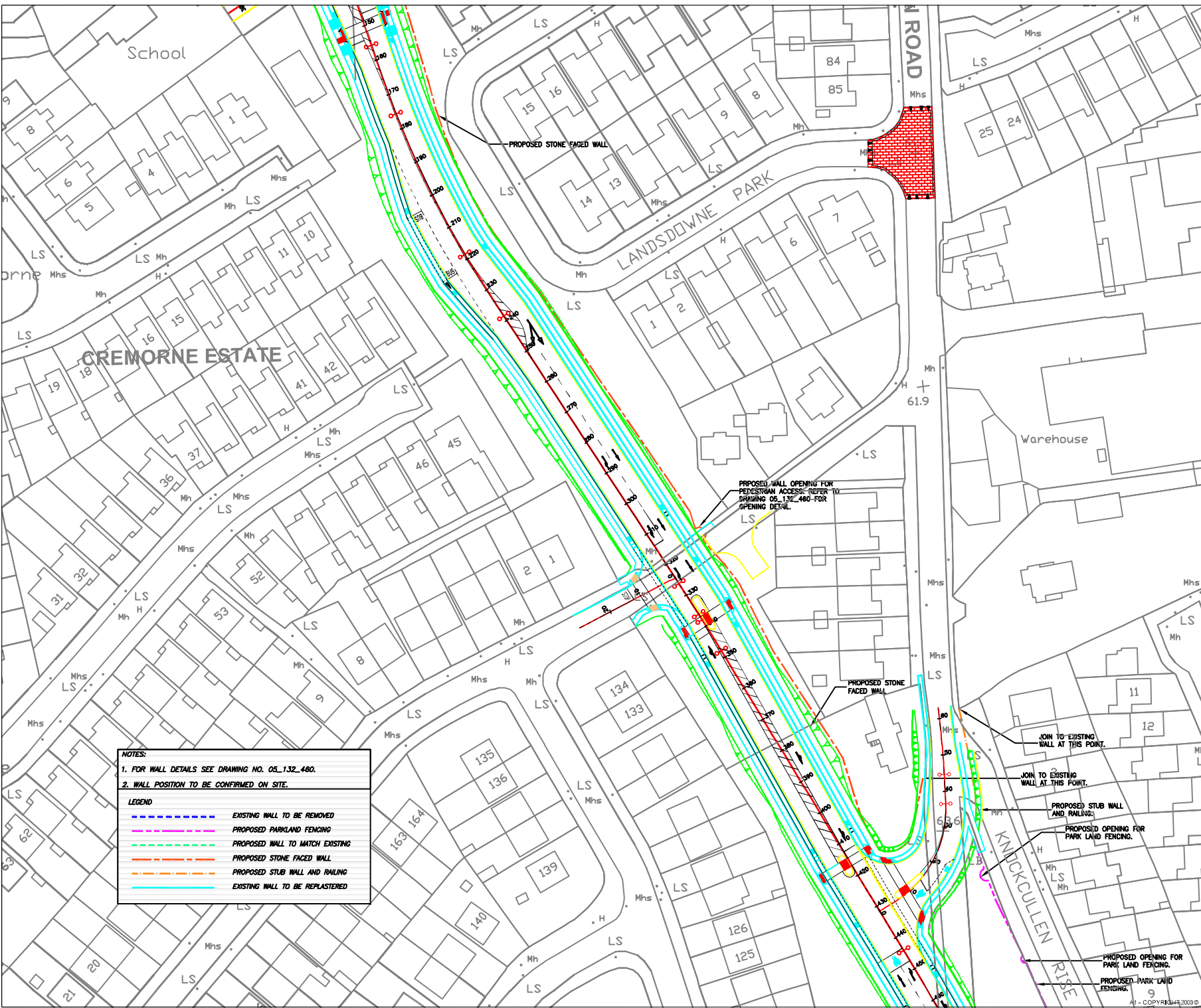

NOTES:
 1. FOR WALL DETAILS SEE DRAWING NO. 05_132_480.
 2. WALL POSITION TO BE CONFIRMED ON SITE.

LEGEND

	EXISTING WALL TO BE REMOVED
	PROPOSED PARKLAND FENCING
	PROPOSED WALL TO MATCH EXISTING
	PROPOSED STONE FACED WALL
	PROPOSED STUB WALL AND RAILING
	EXISTING WALL TO BE REPLASTERED